



Camden Park Road, NW1

£700,000

A fantastic two double bedroom apartment with direct access to a private garden. The apartment has a large reception room, a separate kitchen and is in great condition throughout.

Kings Cross and Granary Square are in close proximity offering a choice of bars and restaurants. Kentish Town underground station is 0.9 miles away. The area has excellent schools including Torriano Primary School and the popular Camden School for Girls.

Features

- Two Double Bedrooms
- Private Garden
- Chain Free
- Share Of Freehold
- One Bathroom
- Great Location

Camden Park Road, London, NW1

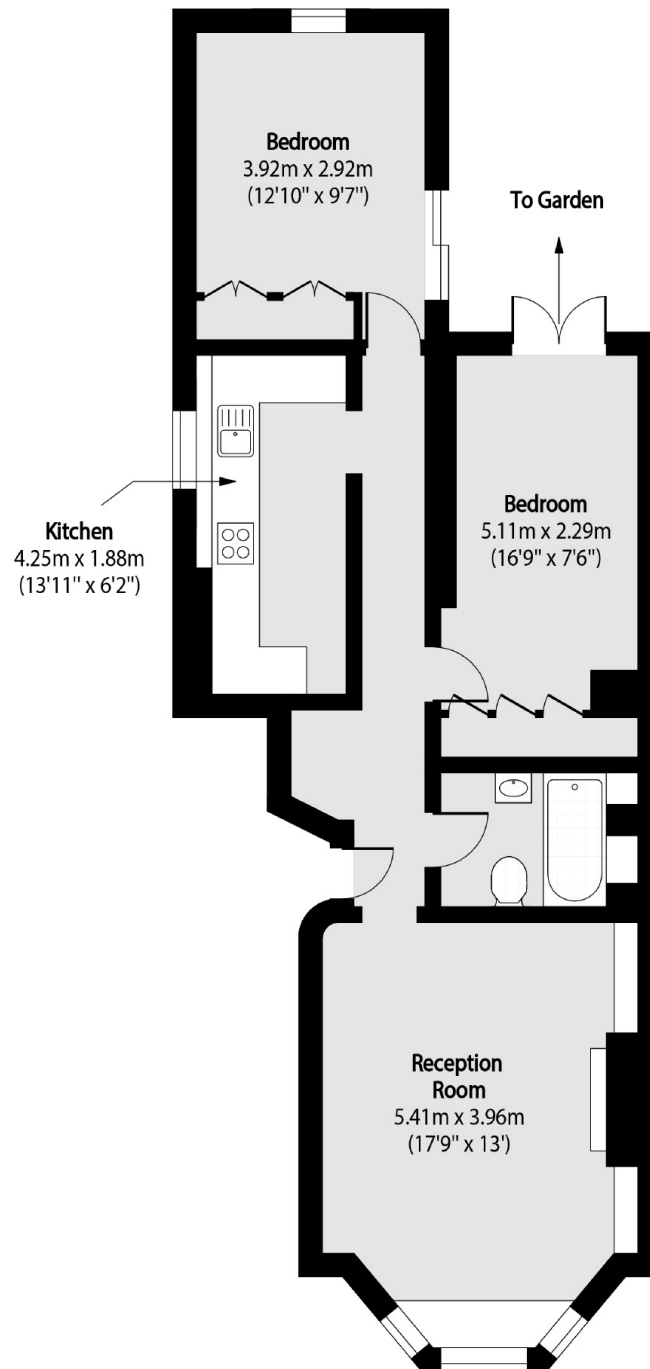

Total area (approx): 66.25 sq m (713 sq. ft)