



Barker Drive, NW1

£519 Per week

At approximately 526 sq.ft is this two double bedroom apartment forming part of this secure purpose built building. The property has a modern separate kitchen, off street parking and access to a communal garden.

Located in Elm Village, a much sought-after part of Camden on the banks of the Regents Canal, a short walk from King's Cross; including the vibrant Granary Sq. Coal Drop Yard and St. Pancras International train station. The property also offers easy access to Camden's independent boutique shops, pubs, cafés and restaurants.

Features

- Two Bedrooms
- Off Street Parking
- One Bathroom
- Great Location
- Great Transport Links
- Available Now

Barker Drive,
London, NW1

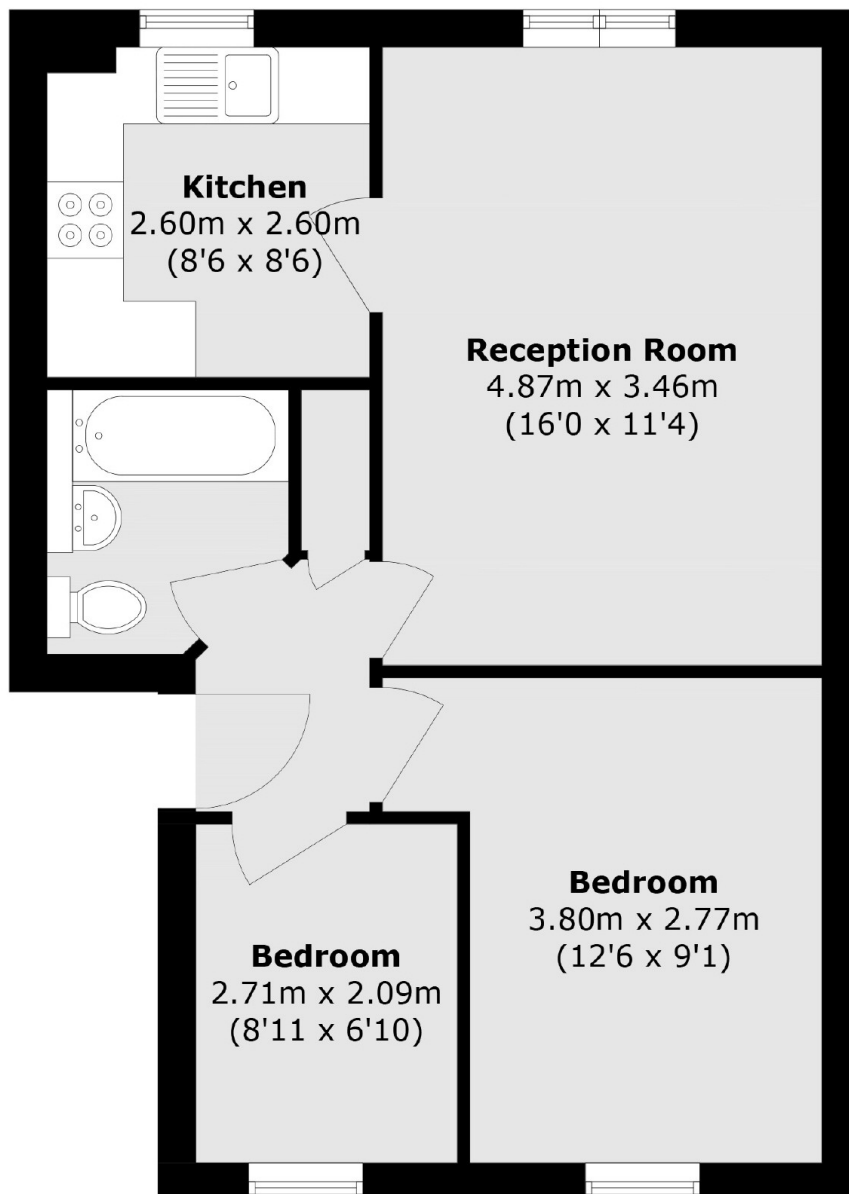

Total area (approx.): 48.9 sq. m (526.3 sq. ft)

Dexters

Kentish Town & Camden
274 Kentish Town Road
London
NW5 2AA
Lettings
020 7483 6391

Energy Rating: C. We aim to make our particulars both accurate and reliable. However they are not guaranteed; nor do they form part of an offer or contract. If you require clarification on any points then please contact us, especially if you're traveling some distance to view. Please note that appliances and heating systems have not been tested and therefore no warranties can be given as to their good working order.

 **RICS** | Regulated
Estate Agent
and Letting Agent

[dexters.co.uk](https://www.dexters.co.uk)