



Murray Mews, NW1

£669 Per week

A modern three-bedroom house with a secluded garden close to the Northern and Piccadilly Line. Set over three floors the property offers a spacious reception room with modern kitchen, three bedrooms, contemporary bathroom and its own garden.

Murray Mews is a residential area popular with families being within walking distance to good schools, cafés, restaurants and the transport links of Kentish Town, Camden Town and Kings Cross.

Features

- Excellent Location
- House
- Secluded Garden
- Three Bedrooms
- Close to Kings Cross

Murray Mews, London, NW1

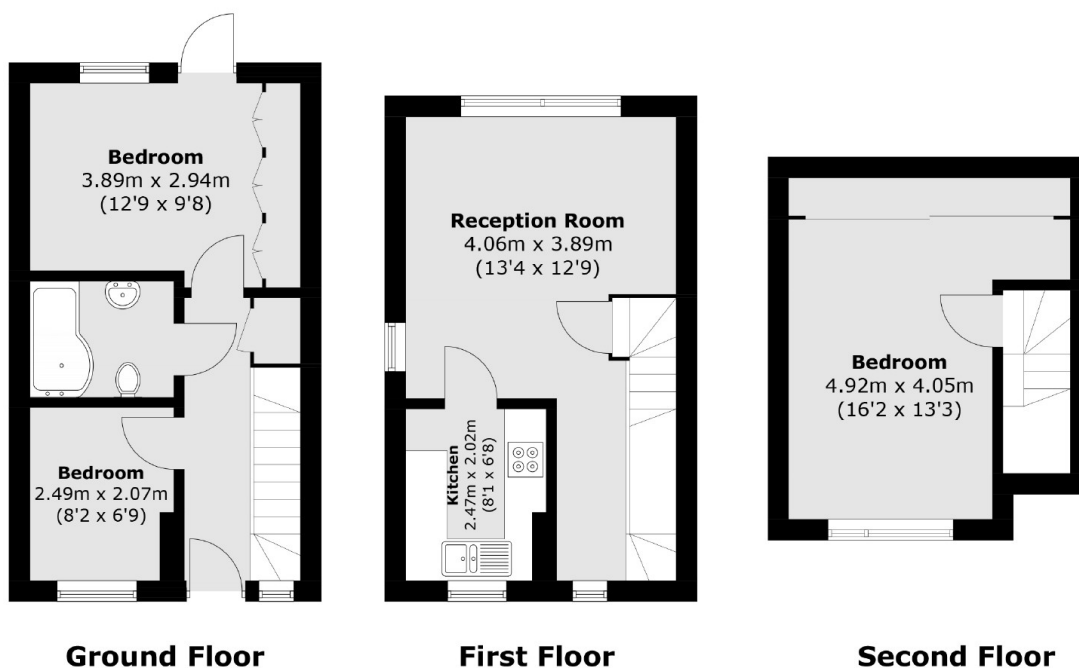

Total area (approx.): 73.3 sq. m (788.8 sq. ft)

Dexters

Kentish Town & Camden
274 Kentish Town Road
London
NW5 2AA
Lettings
020 7483 6391

Energy Rating: D. We aim to make our particulars both accurate and reliable. However they are not guaranteed; nor do they form part of an offer or contract. If you require clarification on any points then please contact us, especially if you're traveling some distance to view. Please note that appliances and heating systems have not been tested and therefore no warranties can be given as to their good working order.

 **RICS** | Regulated
Estate Agent
and Letting Agent

[dexters.co.uk](https://www.dexters.co.uk)