



## Highgate Road, NW5

£553 Per week

A stylish one-bedroom apartment set in a modern development with concierge service. The contemporary warehouse conversion features a modern finish throughout, including an open plan marble kitchen/living area, double bedroom and good storage. Residents benefit from bike storage, lift access and a 24 hour concierge service.

The Maple building is ideally located close to the Northern Line offering quick access to the Kings Cross and the city. Hampstead Heath is also nearby with its famous open spaces perfect for escaping the city.

### Features

- Secure Development
- Modern Finish
- Excellent Transport Links
- 24hr Concierge
- Wooden Floors
- High Ceilings
- Lift Access

# Highgate Road, London, NW5

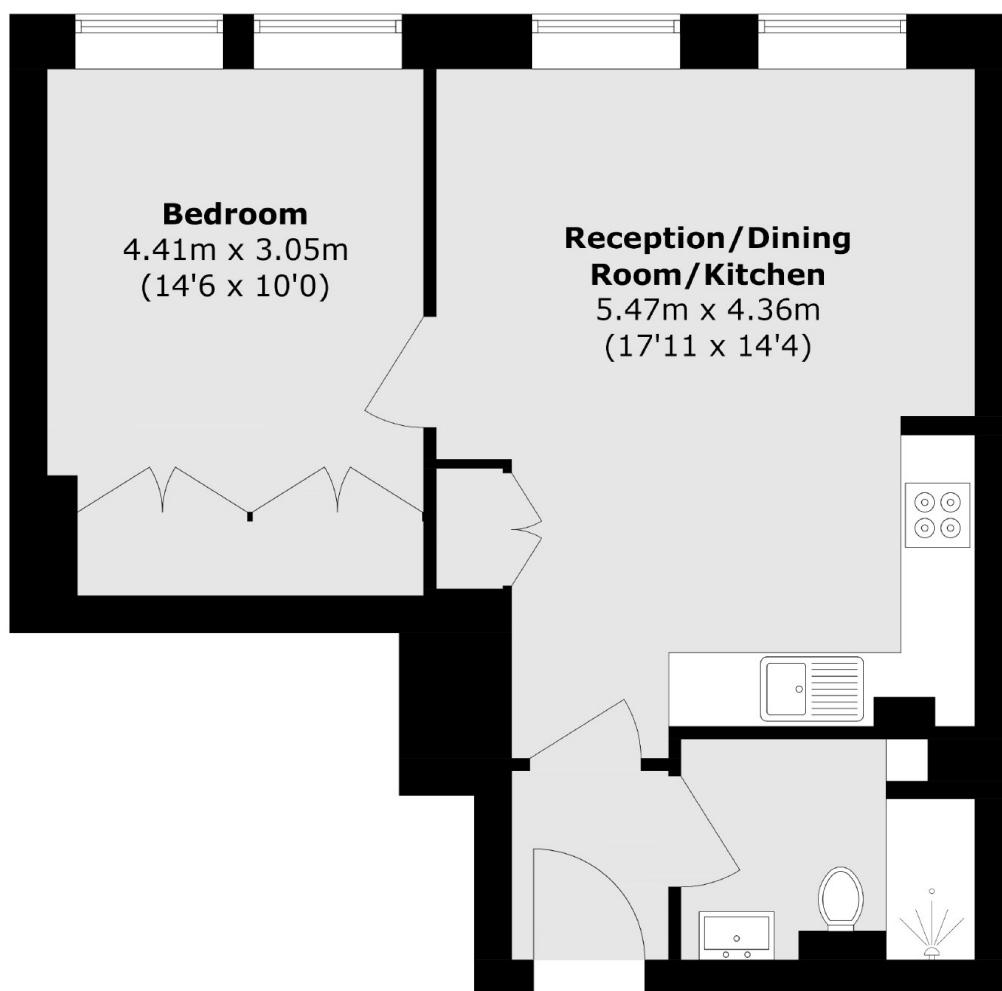

Total area (approx.): 44.9 sq. m (483.3 sq. ft)