



## Maitland Park Villas, NW3

### £475,000

This spacious and well-proportioned apartment has three bedrooms, a bright reception room with a sunny balcony and a separate kitchen.

The leafy Maitland Park conservation area is a sought after residential area between Belsize Park and Chalk Farm and is only 0.5 miles away from both Northern line stations. Hampstead Station is also easily accessible, including the variety of shops, restaurants and cafes surrounding the area.

### Features

- Three Bedrooms
- Leasehold
- Chain Free
- Private Balcony
- First Floor
- Great Location

# Maitland Park Villas, London, NW3

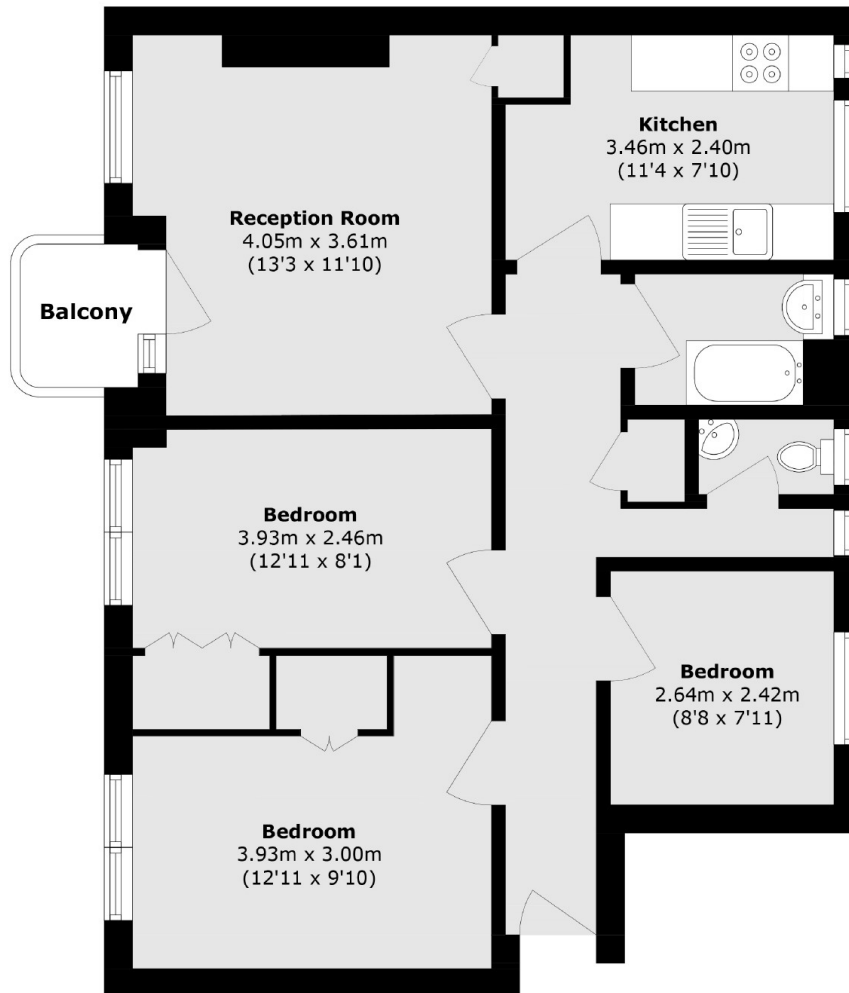

Total area (approx.): 69.0 sq. m (742.7 sq. ft)

Balcony area (approx.): 2.0 sq. m (21.5 sq. ft)