



## Mornington Place, NW1

£595,000

This beautiful one double bedroom apartment has an open plan kitchen/reception room, a private south facing terrace and the apartment is in fantastic condition throughout.

Mornington Place is a quiet residential street perfectly located for the shops and restaurants of Camden Town, as well as Primrose Hill Village. The open spaces of Regent's Park are within easy walking distance, Mornington Crescent underground station (Northern Line) is 0.1 miles away.

### Features

- One Double Bedroom
- Private Terrace
- Leasehold
- Fantastic Condition
- Great Location
- Modern Bathroom

Mornington Place,  
London, NW1

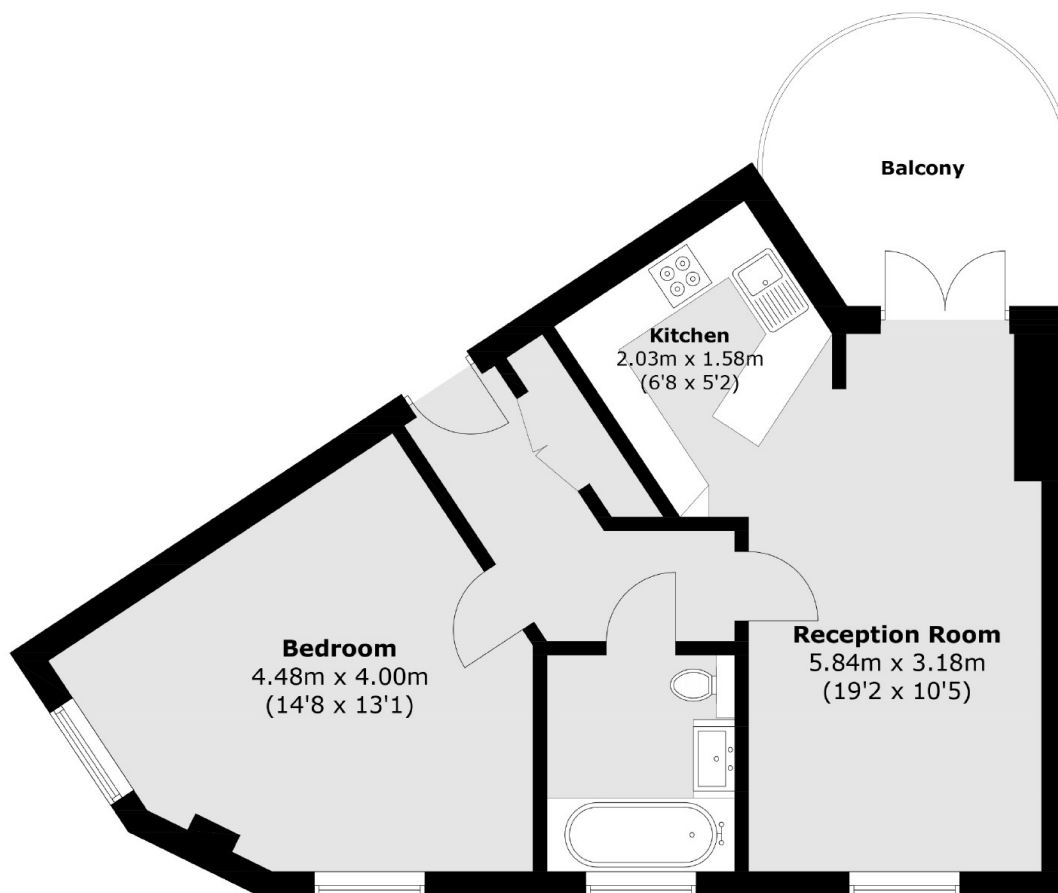

Total area (approx.): 54.0 sq. m (581.2 sq. ft)  
Balcony (approx.): 8.5 sq. m (91.5 sq. ft)