



Queens Crescent, NW5

£320,000

This one double bedroom apartment at approximately 532 sq.ft, has a separate modern kitchen, a large reception room and private balcony.

Situated on a beautiful tree lined crescent in Kentish Town, Fordcombe is within easy reach of excellent transport links, local amenities and the wide open spaces of Hampstead Heath.

Features

- One Bedroom
- Separate Kitchen
- Balcony
- Long Lease
- One Bathroom
- Good Condition

Queens Crescent, London, NW5

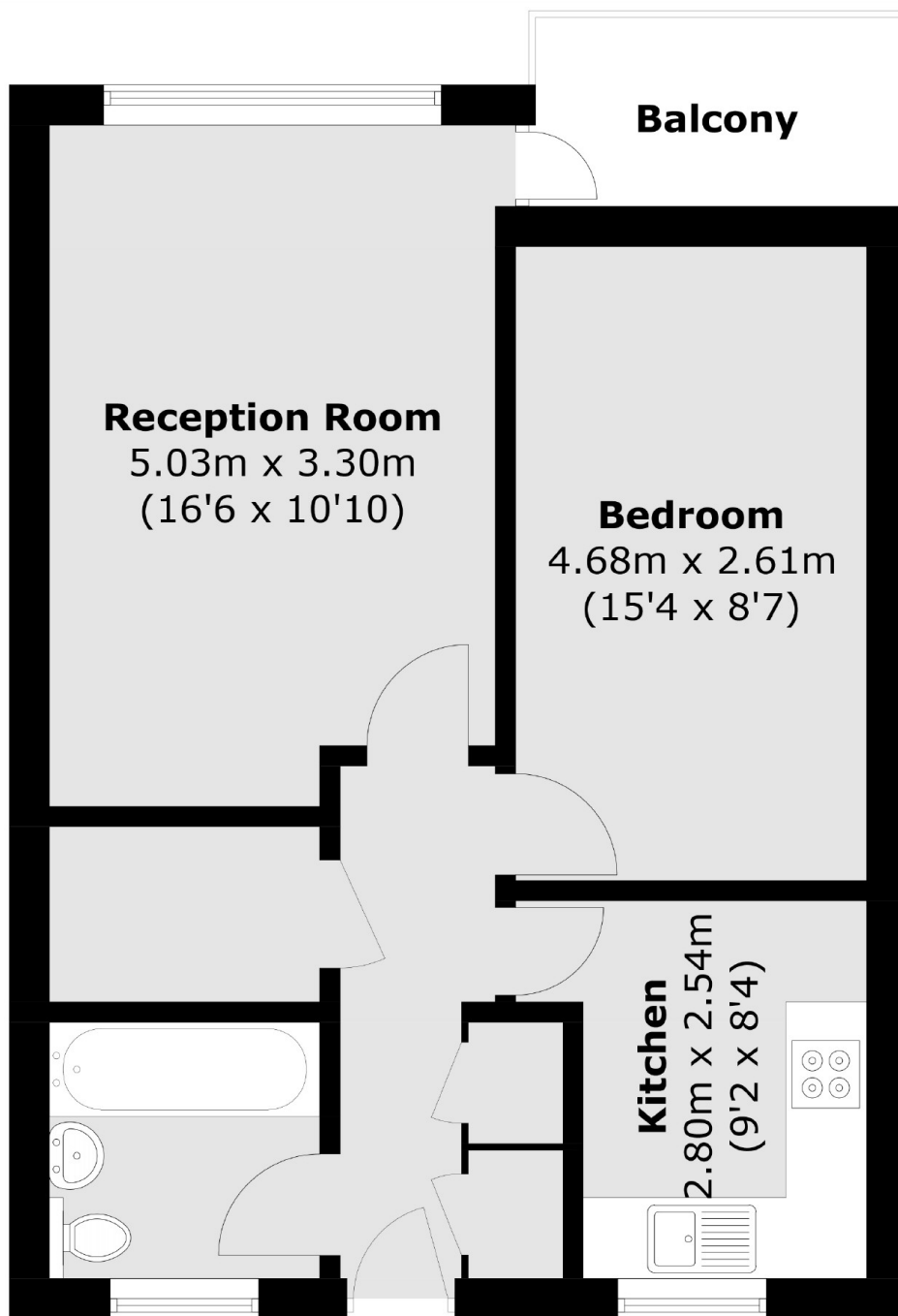

Total area (approx.): 49.5 sq. m (532.8 sq. ft)
Balcony: 3.8 sq. m (40.9 sq. ft)