

## Grafton Road, NW5

£500,000

Forming part of this popular modern purpose built block is this spacious two double bedroom apartment. The flat is in fantastic condition throughout, with an open plan kitchen/living room and large windows that let in an abundance of natural light.

Grafton Road is a short walk from the Parliament Hill entrance to Hampstead Heath with easy access to the open air lido and amazing views over London. Gospel Oak overground station is the closest station, with Kentish Town underground also close by.

### Features

- Two Double Bedrooms
- Two Bathrooms
- Leasehold
- Fantastic Condition
- Chain Free
- Great Views

# Grafton Road, London, NW5

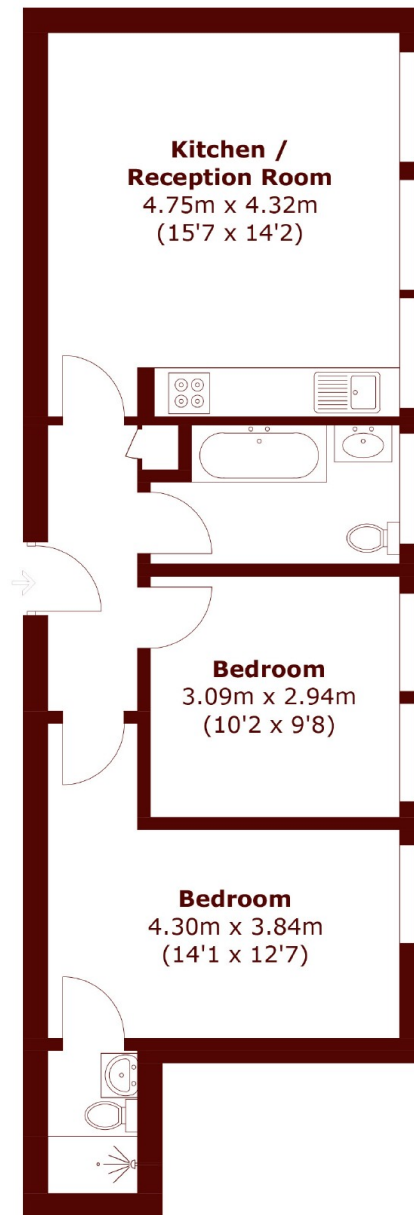

Total area (approx.): 55.1 sq. m (593.1 sq. ft)