



Fortess Grove, NW5

£634 Per week

A charming Victorian terraced cottage situated in a highly sought after cul-de-sac close to the Northern line. The property offers a spacious lounge with wooden floors, three piece bathroom, modern kitchen, two spacious bedrooms and patio garden.

The property is located within close proximity to Kentish Town's multiple shopping and transport facilities including (Northern Line) as well as the popular Tufnell Park Highstreet.

Features

- Victorian Cottage
- Unfurnished
- Double Bedrooms
- Secluded Location
- Excellent Transport Links
- Outside Space

Fortess Grove, London, NW5

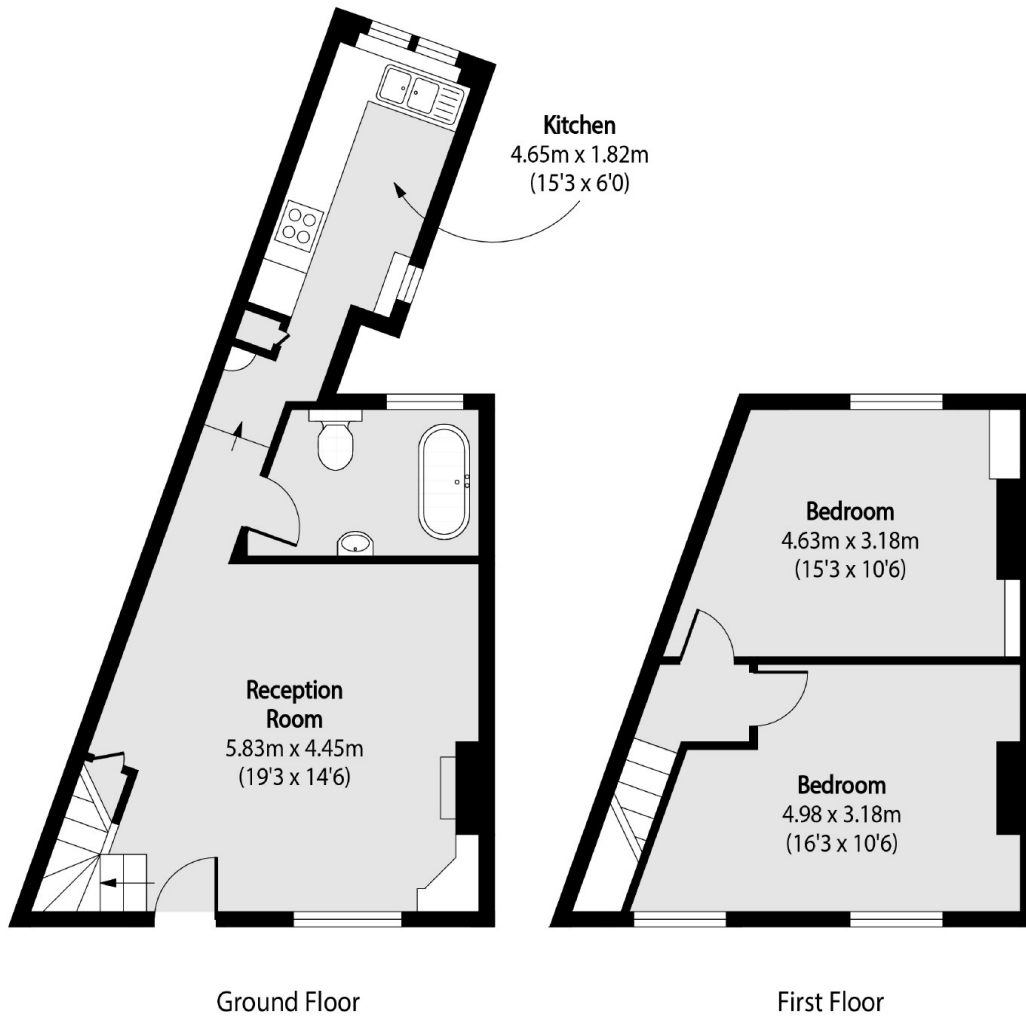

Total area (approx): 68.25 sq m (735 sq. ft)