



Leighton Road, NW5

£475,000

This stunning one double bedroom flat is in good condition with lovely wood flooring and has a separate kitchen. This large garden flat is located within a period property, with its own entrance with use of a rear garden, accessible off the reception room..

Leighton Road is close to all the local amenities, shops and restaurants of Kentish Town. The property is close to Kentish Town station (Northern line and Thameslink) and Tufnell Park station (Northern line) and is in the catchment for Camden School for Girls.

Features

- Private Entrance
- One Double Bedroom
- Lovely Wood Flooring
- Garden
- Share of Freehold
- Chain Free

Leighton Road, London, NW5

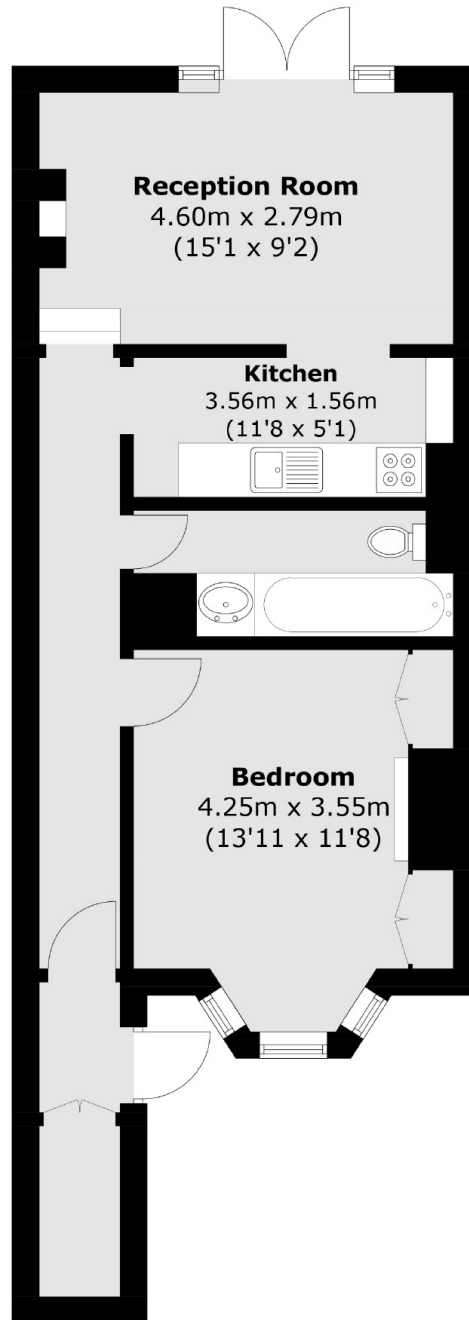

Total area (approx.): 49.5 sq. m (532.8 sq. ft)