

ANWYL
thoughtful homes



the delamere

4 bed detached house

An *impressive* detached family home. Key features include a large open plan kitchen, dining and family room, separate living room and a master en-suite with dressing room.

www.anwylhomes.co.uk

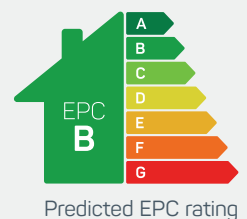



modern
open plan living



ground floor

kitchen/ family/dining	29'10" x 13'11"
utility	9'7" x 5'7"
living room	18'1" x 11'8"
cloaks	5'7" x 3'6"

kitchen/ family/dining	9.09m x 4.25m
utility	2.92m x 1.70m
living room	5.51m x 3.55m
cloaks	1.70m x 1.08m

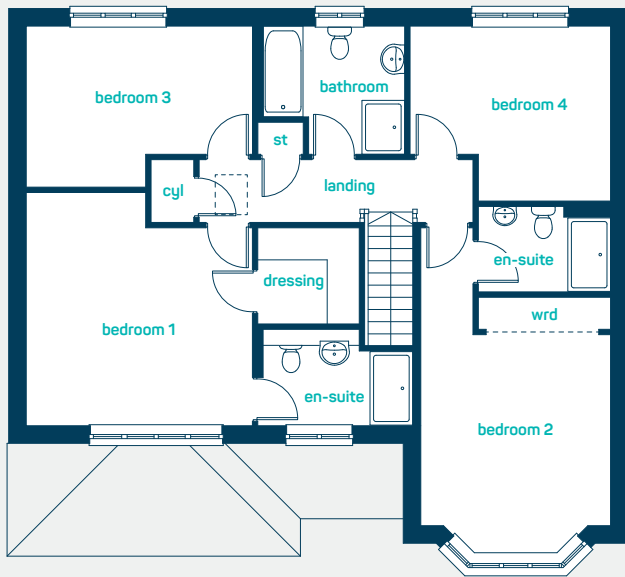

first floor

bedroom 1	14'4" x 13'11"
en-suite	9'6" x 6'3"
dressing room	6'1" x 5'7"
bedroom 2*	20'2" x 11'8"
ensuite 2	8'1" x 5'3"
bedroom 3	13'11" x 9'11"
bedroom 4	12'4" x 10'9"
bathroom	8'8" x 7'11"

bedroom 1	4.37m x 4.23m
en-suite	2.90m x 1.91m
dressing room	1.86m x 1.70m
bedroom 2*	6.13m x 3.55m
en-suite 2	2.48m x 1.60m
bedroom 3	4.24m x 3.01m
bedroom 4	3.75m x 3.27m
bathroom	2.65m x 2.40m

the delamere
4 bed detached house

ANWYL
thoughtful homes

**NEW
HOMES
QUALITY
CODE**

**NEW HOMES
SERVICE
OMBUDSMAN**

www.anwylhomes.co.uk

Anwyl Homes is a Registered Developer with the NHQB. This is a computer-generated image of the delamere, elevation treatment may vary. Room sizes are approximate, dimensions are taken from the longest room point (please consult homes advisor for measurement points). Plots may be handed and any garages may be single or double. Kitchen and bathroom layouts are indicative. These plans are correct at the time of going to press, but may be subject to change during construction. Please ensure that you check for specific plot details. 01/11/22.

everything considered.