



MARCO HARRIS  
THE PROPERTY PROFESSIONALS

## Hunters Moon, Poles Lane, Otterbourne

Guide Price £1,100,000

4 4 3



### Welcome to Hunters Moon!

This impressive detached family home offers nearly 3,300 sqft of living space and is situated on a plot of just over 0.25 acres in the sought-after village of Otterbourne, conveniently located within excellent school catchment areas on the outskirts of Winchester. Tucked away from the road, the property is accessed via a gravel driveway, which provides ample parking and leads to a detached outbuilding. The ground floor features a highly versatile layout with four reception rooms and an expansive kitchen/dining/family area. The property enjoys a prime location in Otterbourne, close to the neighbouring village of Shawford with it's train station. Just a short



MARCO HARRIS  
THE PROPERTY PROFESSIONALS

drive from the historic city of Winchester, Otterbourne is a very picturesque village of amenities such as a village hall, church, garage, post office, local shop, and traditional pubs - not to mention the fantastic Thornden School in catchment.





## Key Features

- Detached Family Home
- Offering Almost 3300 SqFt
- Four Double Bedrooms
- Utility And Downstairs Cloakroom
- Thornden School Catchment
- Open-Plan Kitchen/Dining/Family Room
- Cosy Lounge With Further Second Lounge Through Double Doors
- Four Bathrooms
- Large Private Rear Garden
- Sought After Area Of Otterbourne Village

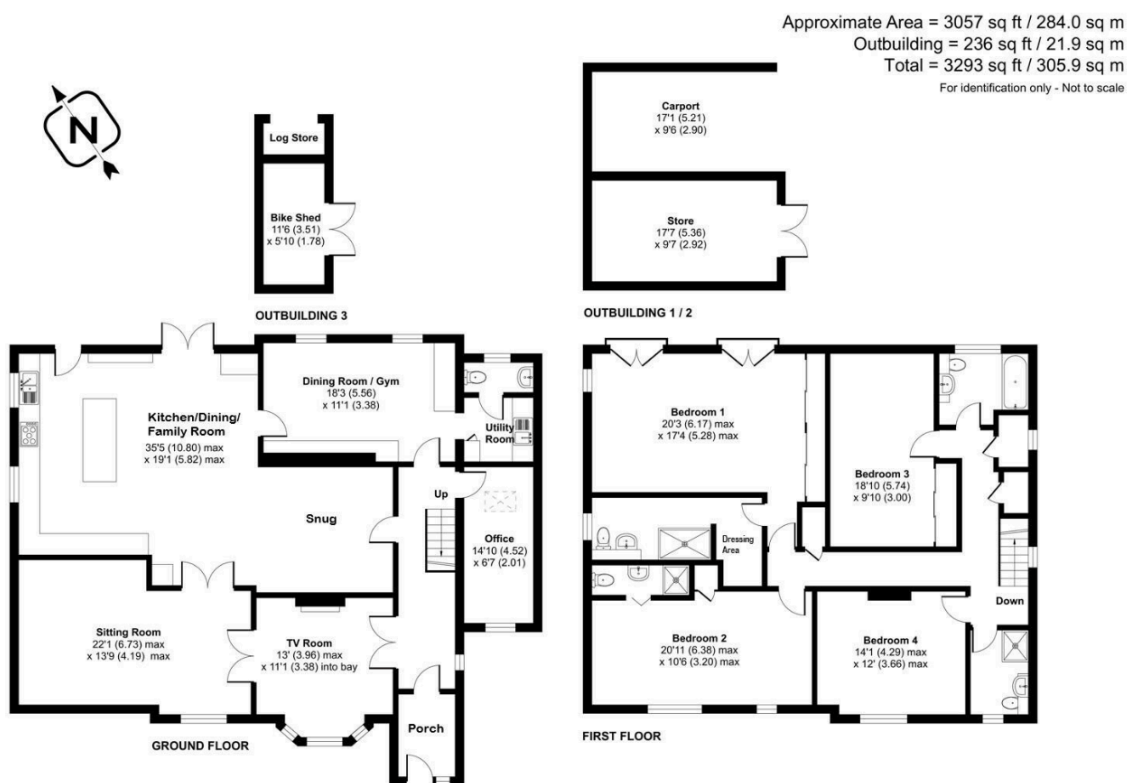

Certified  
Property  
Measurer

Floor plan produced in accordance with RICS Property Measurement Standards incorporating International Property Measurement Standards (IPMS2 Residential). © richcom 2023. Produced for Charters Estate Agents Limited. REF: 954743

