



MARCO HARRIS
THE PROPERTY PROFESSIONALS

Home Field Drive, Nursling, Southampton, SO16

Guide Price £280,000

🛏️ 2 🚿 1 🚗 1



- Built In Storage In Both Bedrooms
- Easy Access To Junction 3 Of M27
- Modern Fitted Kitchen With Integrated Appliances
- Ideal First Time Buy
- Loft Is Boarded With Electrics
- Modern Shower Room With Large Shower Cubicle
- Stunning Low Maintenance Rear Garden
- Two Allocated Parking Spaces In Front Of Property
- Two Bedroom House
- CHECK OUT THE VIDEO TOUR!



Welcome to Home Field Drive! This is a fantastic two-bedroom terrace house with off road parking for two cars and a gorgeous rear garden. Situated in a popular area of Nursling this location offers superb motorway access to the M27 via junction 3 ideal for commuting or access to Southampton City. Just 11 miles away you will find Lyndhurst a large village situated in the New Forest National Park, perfect for walks, picnics and enjoying the local wildlife. If schools are high on the agenda, then you'll be pleased to know that the catchment is Nursling Ce Primary School for ages 4 – 10 and the secondary is The Mountbatten School a Language & Sports College.

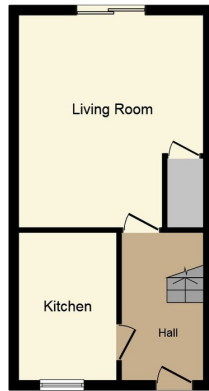

Ground Floor

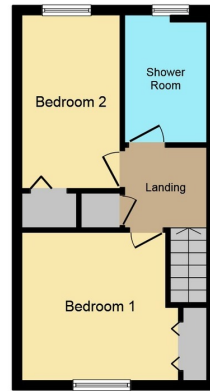

First Floor

This Floor Plan is for illustration purposes only and may not be representative of the property. The position and size of doors, windows and other features are approximate. Unauthorized reproduction prohibited. © PropertyBox

