



MARCO HARRIS
THE PROPERTY PROFESSIONALS

Television House, Meridian Way, Southampton, SO14

Offers Over £220,000

🛏️ 2 🚿 1 🚿 1



- Two Bedroom Apartment
- Meridian Waterside Development
- Stunning Balcony
- Water Views
- Three- Piece Bathroom
- Open Plan Living
- High Spec Kitchen
- Allocated Parking



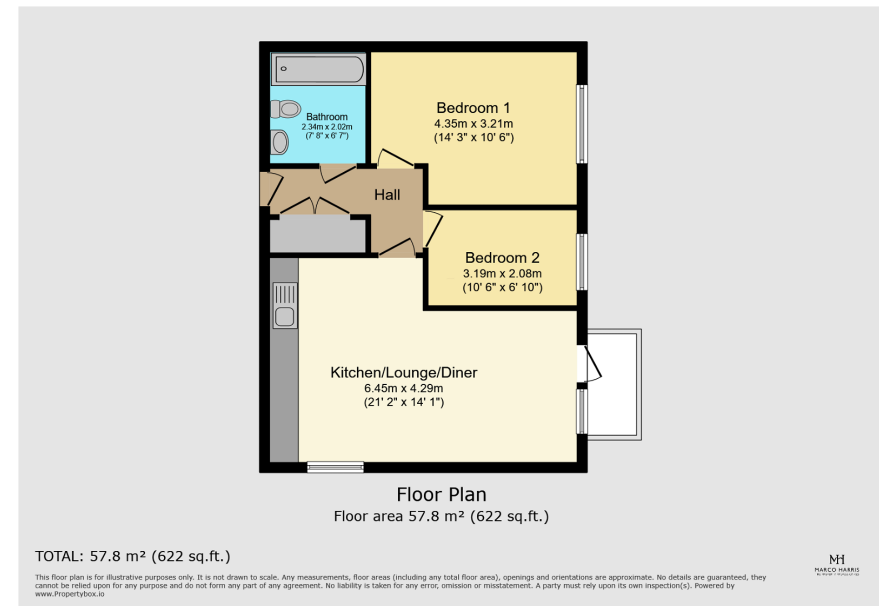

Welcome to Television House! This beautiful two-bedroom apartment is situated in the highly desirable area of Southampton. Nestled by the River Itchen, it offers breathtaking views and a scenic backdrop. The property is part of the coveted Meridian Way development and is just a short distance from the city centre, providing convenient access to all of Southampton's amenities and attractions.

85 85