



**2 Windermere Road, Felixstowe**

In Excess of **£402,500**







## 2 Windermere Road

Felixstowe, Felixstowe

Situated on a quiet road in Old Felixstowe is this immaculate 3 bedroom detached bungalow  
Council Tax band: D

Tenure: Freehold

EPC Energy Efficiency Rating: C

EPC Environmental Impact Rating: D







Ground Floor  
Approximate Gross Internal Area  
1195 sq ft (111 sq m)

Disclaimer: Floorplan measurements are approximate and are for illustrative purposes only.  
While we do not doubt the floor plan accuracy and completeness, you or your advisors should  
conduct a careful, independent investigation of the property in respect of monetary valuation.  
copyright www.rjphoto.co.uk

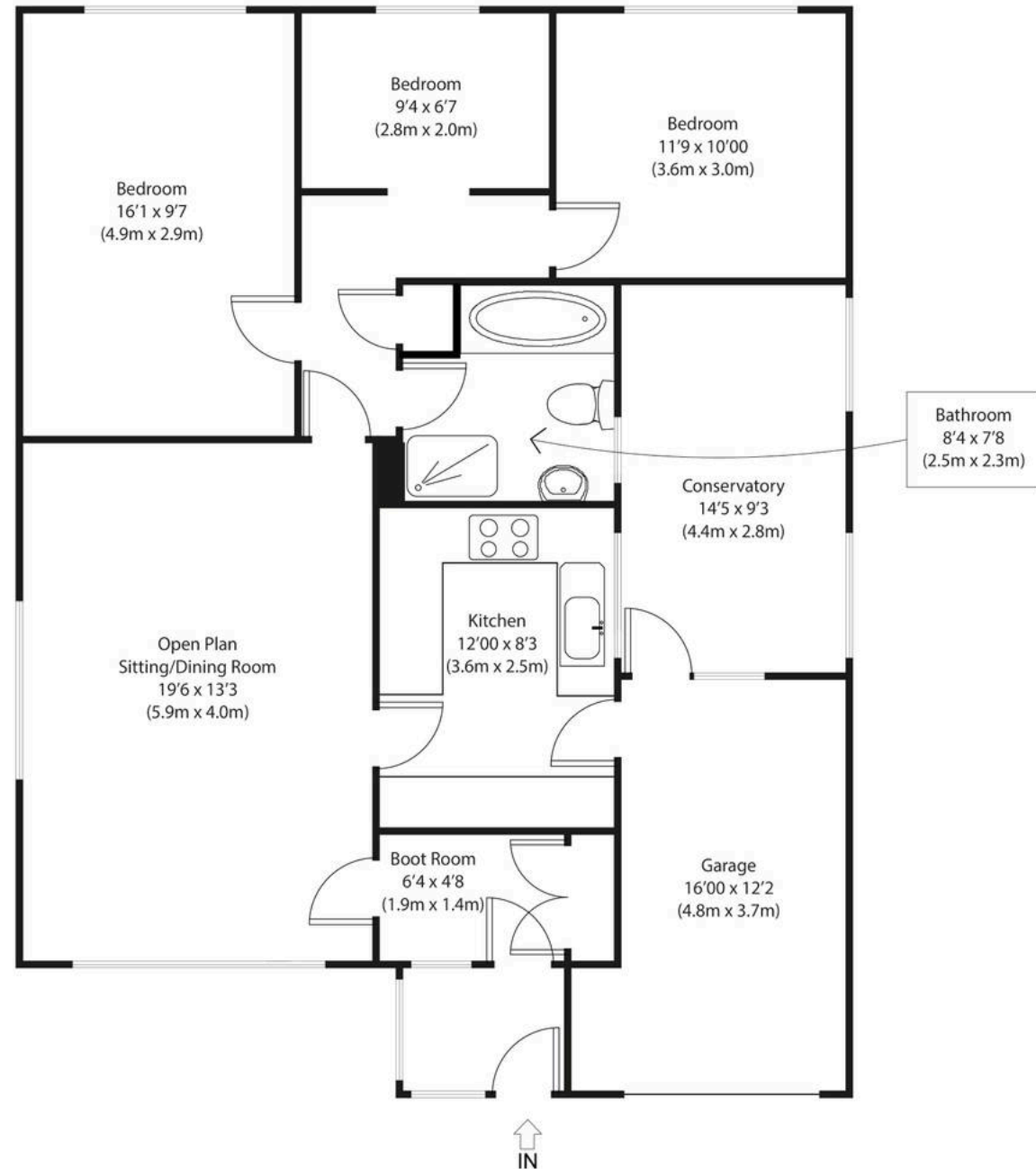
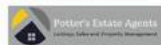





## Potters Estate Agents

Potters Estate Agents, 6 Market Hill - IP12 4LU

01394 447487 • [enquiries@pottersestateagents.com](mailto:enquiries@pottersestateagents.com) • [www.pottersestateagents.com/](http://www.pottersestateagents.com/)