



Top Floor Snitterton Road
, Matlock, DE4 3LZ

£285 PCM



Top Floor Snitterton Road

, Matlock, DE4 3LZ

This top floor office is based at Snitterton House and within close proximity of many local amenities and walking distance of Matlock town centre. The office is 180 square feet and has use of a communal kitchen. Lovely aspect overlooking the town.



Floor Plan

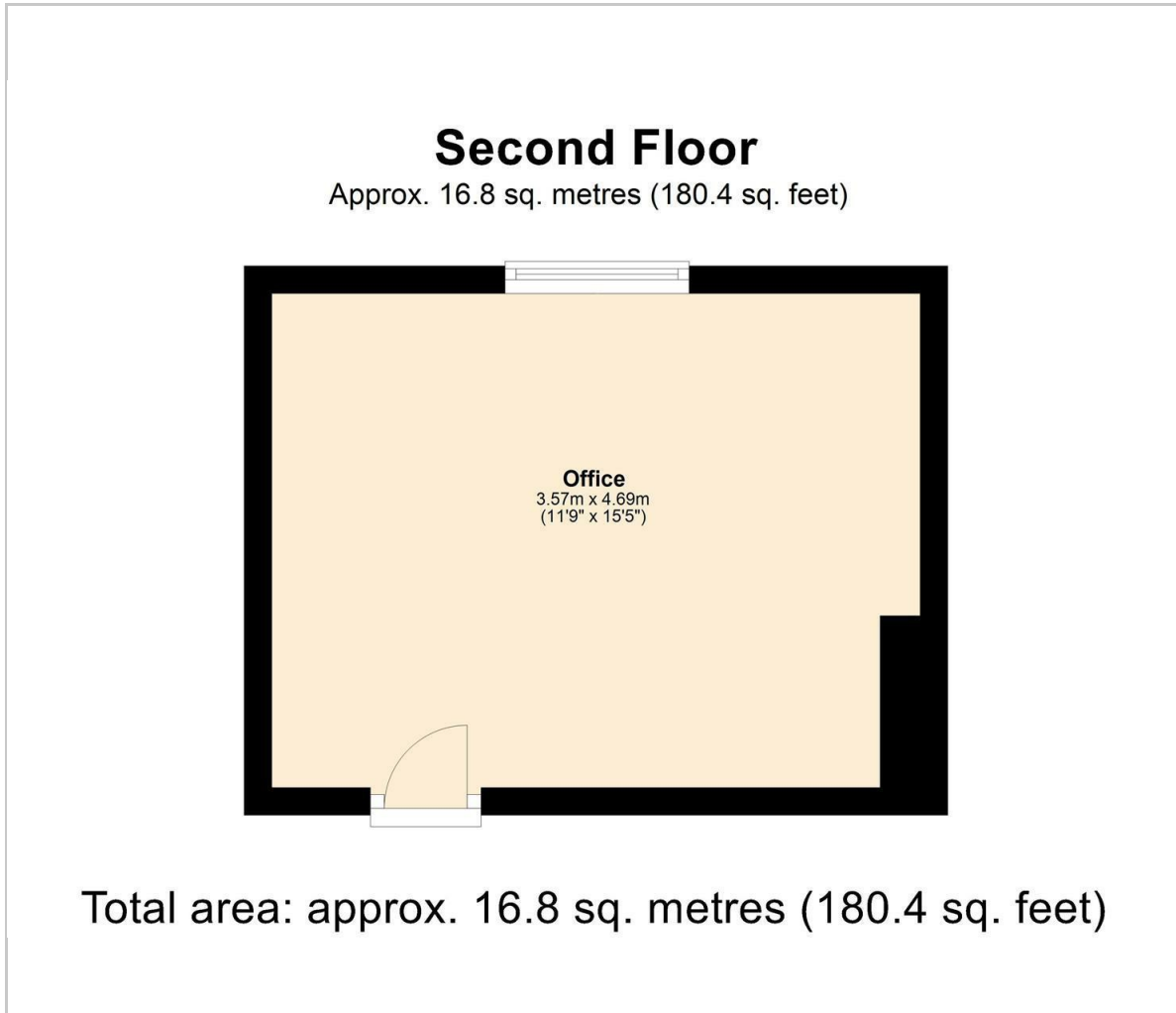

Viewing

Please contact our Matlock Office on 01629 700246 if you wish to arrange a viewing appointment for this property or require further information.

These particulars, whilst believed to be accurate are set out as a general outline only for guidance and do not constitute any part of an offer or contract. Intending purchasers should not rely on them as statements of representation of fact, but must satisfy themselves by inspection or otherwise as to their accuracy. No person in this firm's employment has the authority to make or give any representation or warranty in respect of the property.

Area Map



Energy Efficiency Graph

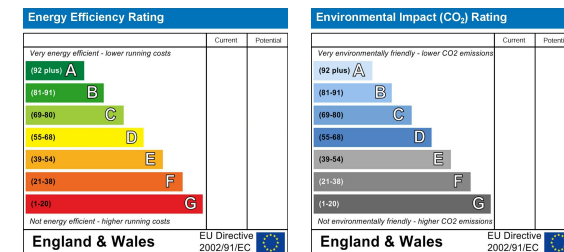

2 Dale Road, Matlock, Derbyshire, DE4 3LT
T: 01629 700246



E: info@dalesandpeaks.co.uk
www.dalesandpeaks.co.uk