



DALES & PEAKS



## Clips Heads Willersley Lane

Cromford, Matlock, DE4 5JG

£325,000

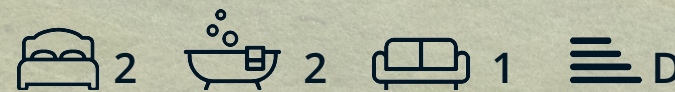



## Clips Heads Willersley Lane

Cromford, Matlock, DE4 5JG

Occupying a generous plot with ample off street parking is this attractive and fully renovated 2 bedroom, 2 bathroom semi detached property. Clips Head offers 871 sqft of living accommodation, scenic views of the surrounding countryside and benefits from a lawned garden with patio seating area and stone outbuilding.

The ground floor comprises; Bright and spacious open plan living space and kitchen with integrated appliances and breakfast bar. Utility room and downstairs shower room.

The first floor comprises; Two double bedrooms with incredible views and main bathroom.

**Dales and Peaks ForwardMove - Please read**







Floor Plan

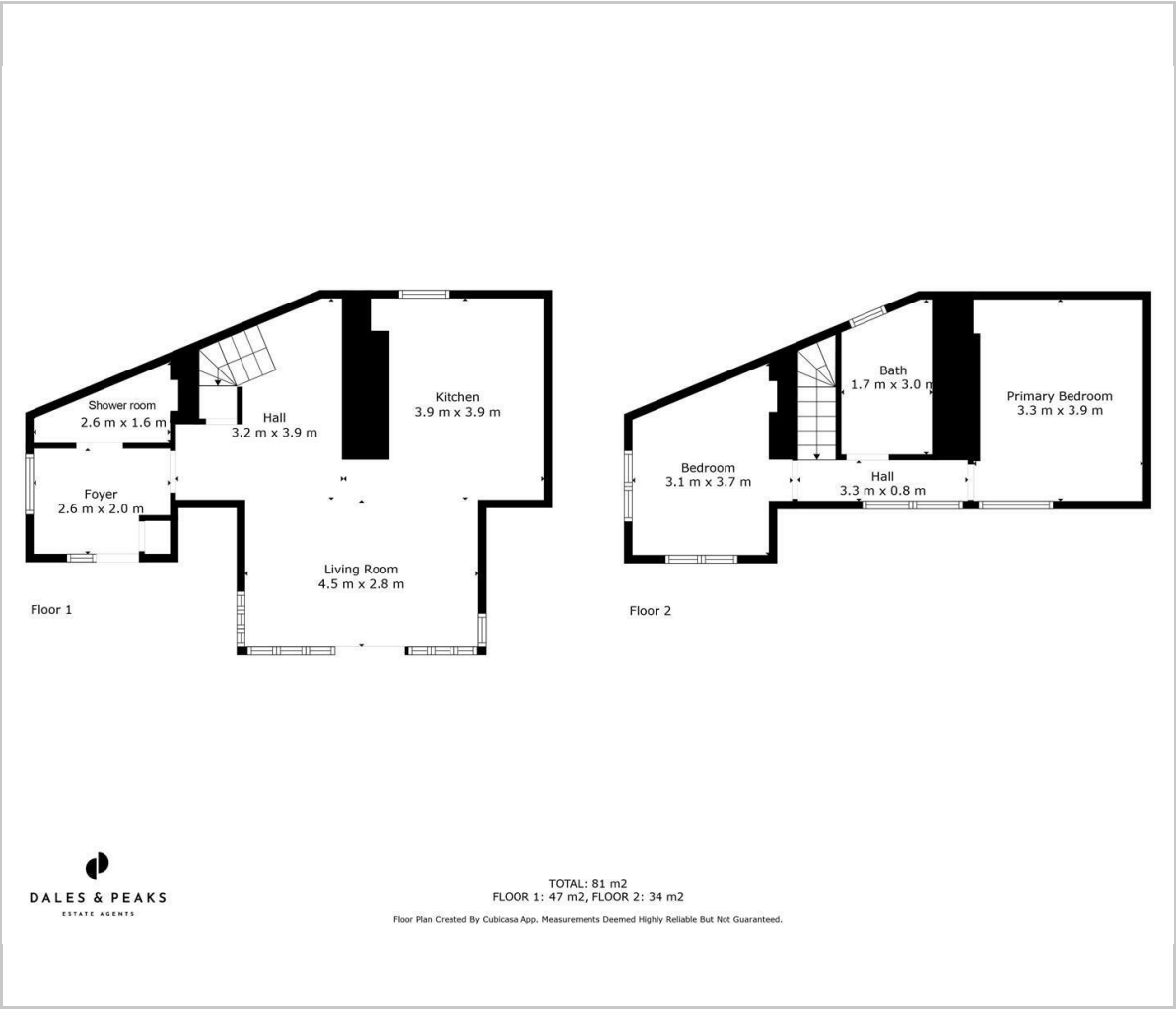

Viewing

Please contact our Matlock Office on 01629 700246 if you wish to arrange a viewing appointment for this property or require further information.

These particulars, whilst believed to be accurate are set out as a general outline only for guidance and do not constitute any part of an offer or contract. Intending purchasers should not rely on them as statements of representation of fact, but must satisfy themselves by inspection or otherwise as to their accuracy. No person in this firms employment has the authority to make or give any representation or warranty in respect of the property.

Area Map

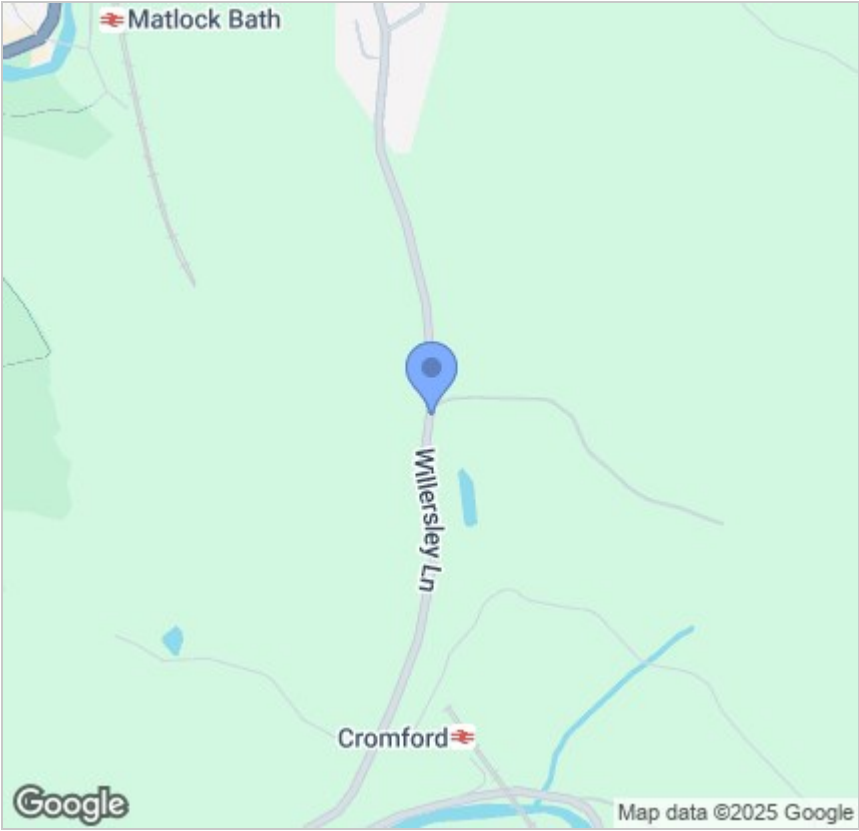

Energy Efficiency Graph

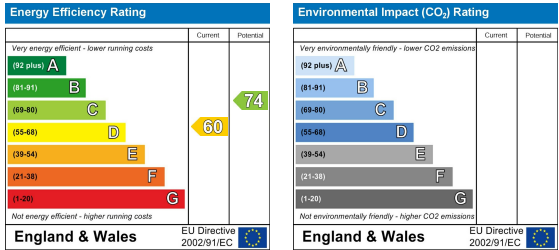

2 Dale Road, Matlock, Derbyshire, DE4 3LT  
T: 01629 700246



E: info@dalesandpeaks.co.uk  
www.dalesandpeaks.co.uk