



**4 Nether Way**

Darley Dale, Matlock, DE4 2TS

£500,000





## 4 Nether Way

Darley Dale, Matlock, DE4 2TS

£500,000 - £525,000 (Guide price) A recently refurbished and extended, 4 bedroom detached family home, situated in a highly desirable location, offering 2131 sqft of living accommodation over 2 storeys. The property features a home office with potential to create an annex for a dependant relative, private enclosed rear garden, ample off street parking and garage.

The ground floor comprises; Entrance hallway, living room with bay window and electric fireplace, open plan dining kitchen with integrated appliances and quartz worktop, sunroom with access onto the rear patio. A third split level reception room with versatile use for a home office/studio, gym or snug, also with potential to create an annex.

The first floor comprises; Front aspect master bedroom with ensuite shower room, three further double bedrooms and main family bathroom.

**Dales and Peaks ForwardMove**  
- Please read







Floor Plan

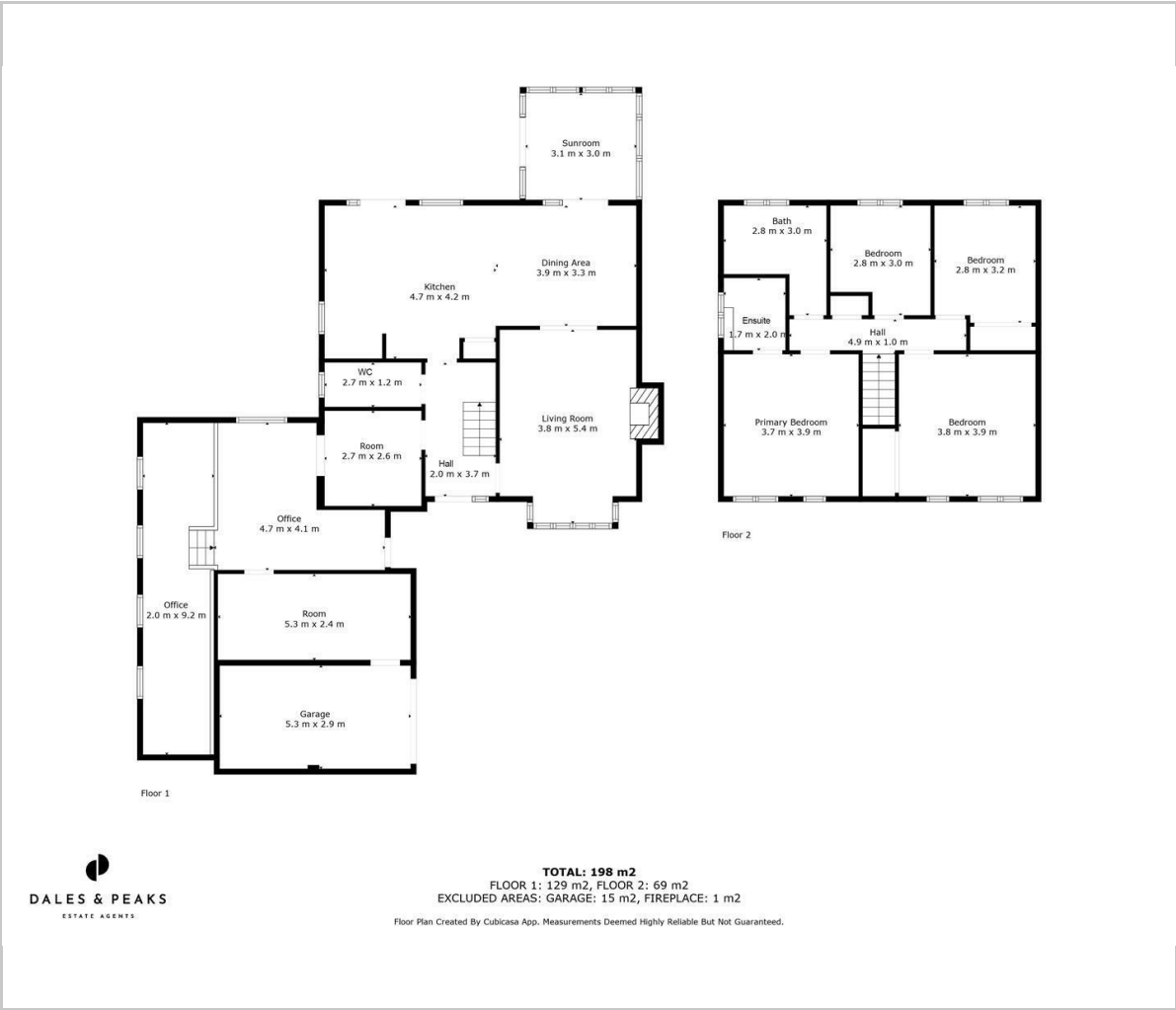

Viewing

Please contact our Matlock Office on 01629 700246 if you wish to arrange a viewing appointment for this property or require further information.

These particulars, whilst believed to be accurate are set out as a general outline only for guidance and do not constitute any part of an offer or contract. Intending purchasers should not rely on them as statements of representation of fact, but must satisfy themselves by inspection or otherwise as to their accuracy. No person in this firms employment has the authority to make or give any representation or warranty in respect of the property.

Area Map

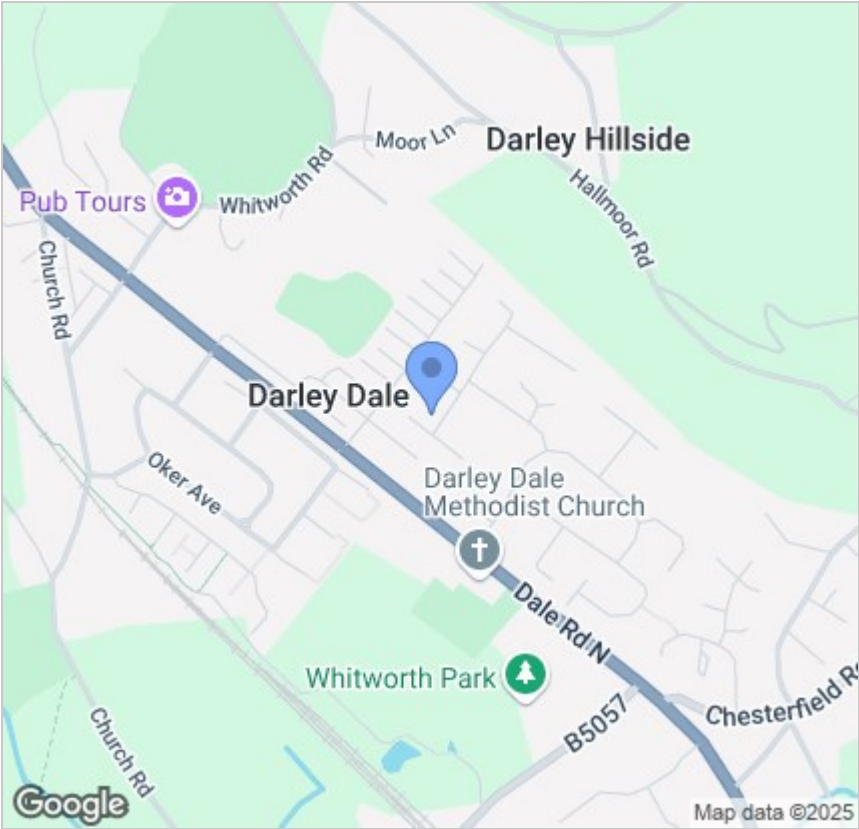

Energy Efficiency Graph

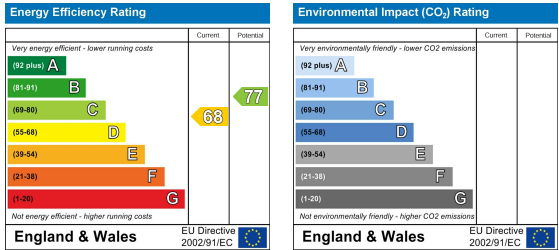

2 Dale Road, Matlock, Derbyshire, DE4 3LT  
T: 01629 700246



E: info@dalesandpeaks.co.uk  
www.dalesandpeaks.co.uk