



11 Sir Josephs Lane
Darley Dale, Matlock, DE4 2GY
Guide Price £260,000



11 Sir Josephs Lane

Darley Dale, Matlock, DE4 2GY

£260,000 - £270,000 (Guide price)
Situated in this edge of town location and offering 721 sqft of living accommodation, this 2 bedroom semi detached bungalow benefits from a low maintenance garden, off street parking and single garage. The accommodation briefly comprises; Entrance porch and hallway, dining kitchen, living room through to the conservatory, a double bedroom, shower room and single bedroom.

Dales and Peaks ForwardMove
- Please read





Floor Plan

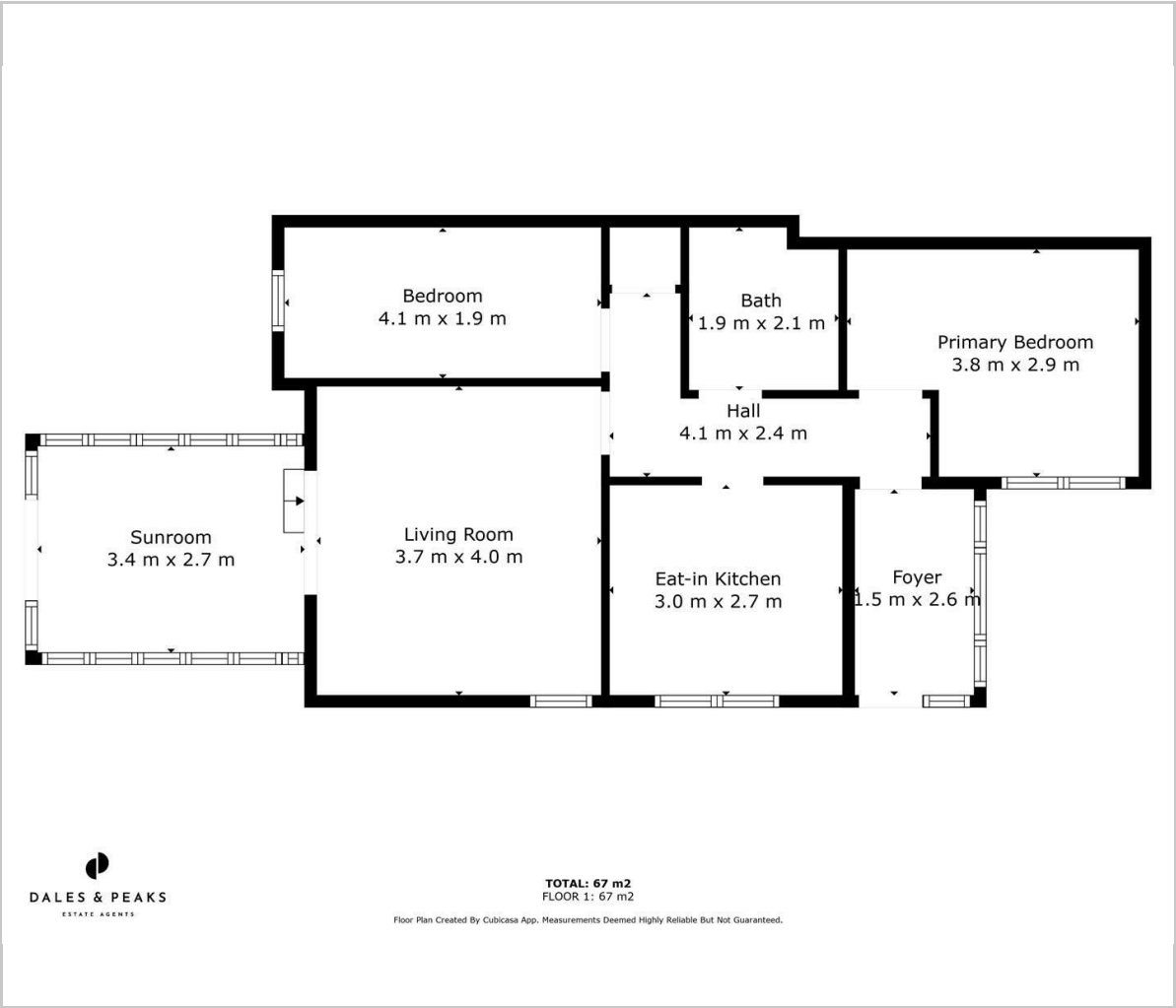

Viewing

Please contact our Matlock Office on 01629 700246 if you wish to arrange a viewing appointment for this property or require further information.

These particulars, whilst believed to be accurate are set out as a general outline only for guidance and do not constitute any part of an offer or contract. Intending purchasers should not rely on them as statements of representation of fact, but must satisfy themselves by inspection or otherwise as to their accuracy. No person in this firms employment has the authority to make or give any representation or warranty in respect of the property.

Area Map



Energy Efficiency Graph

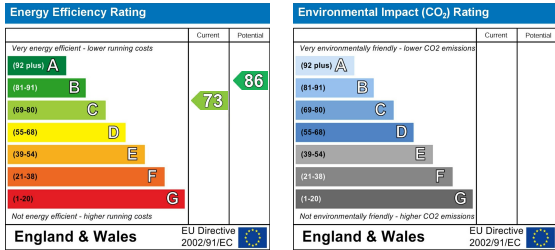

2 Dale Road, Matlock, Derbyshire, DE4 3LT
T: 01629 700246



E: info@dalesandpeaks.co.uk
www.dalesandpeaks.co.uk