



Ground Floor Snitterton Road
, Matlock, DE4 3LZ

£1,200 PCM



Ground Floor Snitterton

, Matlock, DE4 3LZ

The ground floor of Snitterton House is currently being utilised as a cafe. Previously it was office/retail so any interested parties will need to check with the council with regards to change of use. The property is situated on Snitterton Road and has a very pleasant outlook across to Matlock. The accommodation comprises of one front facing room which is the main area. There is a further room with a side aspect overlooking Snitterton Road. Kitchen and toilet facilities. To the rear of the property there is a charming enclosed courtyard that is being utilised by the current tenant as additional outdoor seating space. Overall square footage is 709.7. The property benefits from being in a vibrant area just off Dale Road, which lends itself perfectly for various uses.





Floor Plan

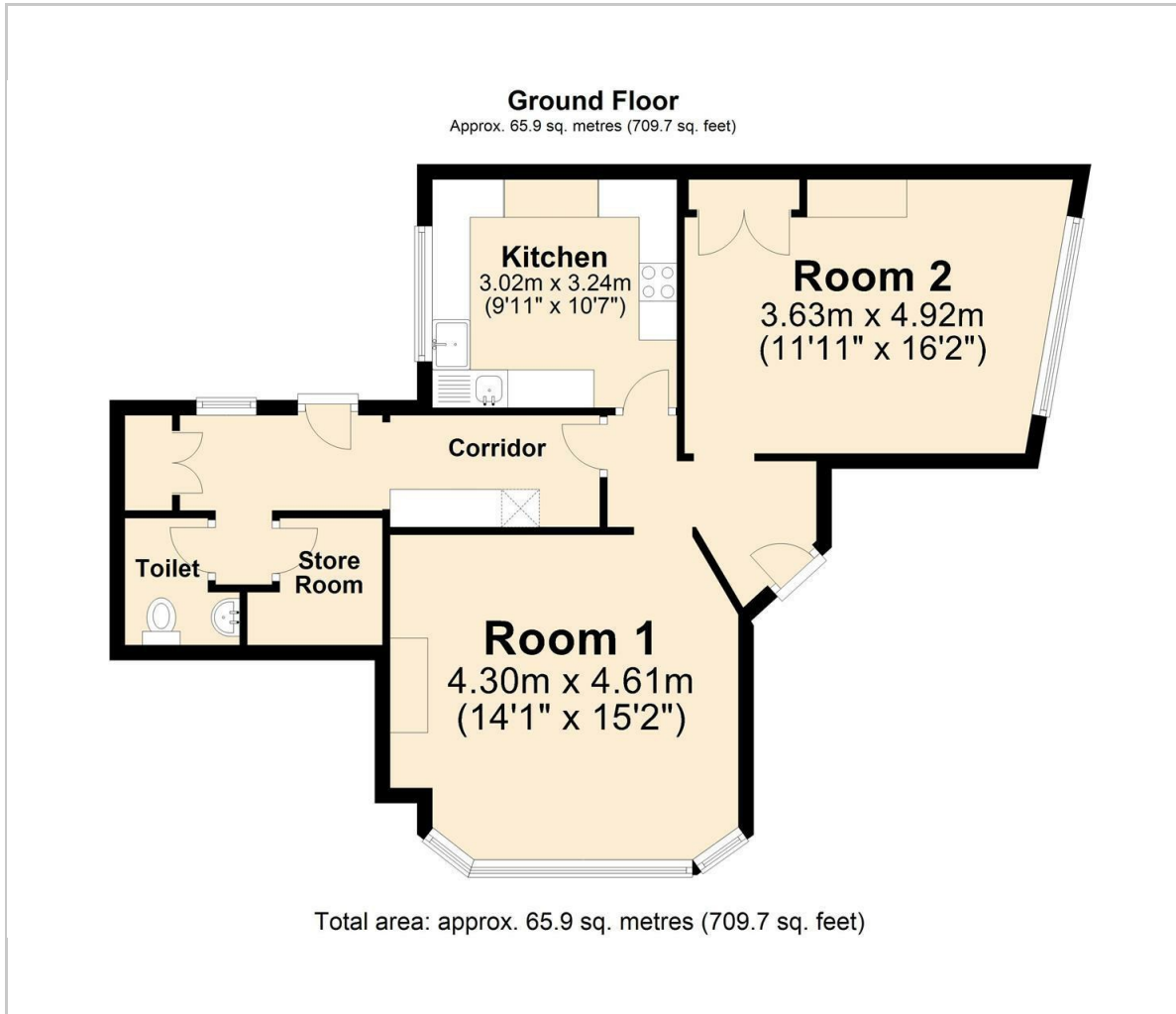

Viewing

Please contact our Matlock Office on 01629 700246 if you wish to arrange a viewing appointment for this property or require further information.

These particulars, whilst believed to be accurate are set out as a general outline only for guidance and do not constitute any part of an offer or contract. Intending purchasers should not rely on them as statements of representation of fact, but must satisfy themselves by inspection or otherwise as to their accuracy. No person in this firm's employment has the authority to make or give any representation or warranty in respect of the property.

Area Map



Energy Efficiency Graph

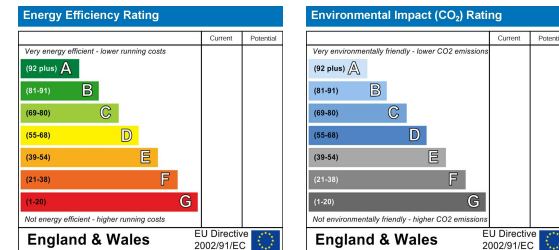

2 Dale Road, Matlock, Derbyshire, DE4 3LT
T: 01629 700246

E: info@dalesandpeaks.co.uk
www.dalesandpeaks.co.uk