

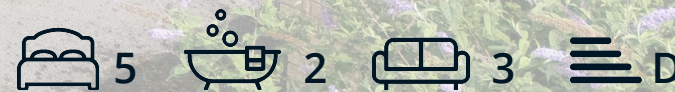

34 Hawleys Close

, Matlock, DE4 5LY

Guide Price £500,000



34 Hawleys Close

, Matlock, DE4 5LY

£500,000 - £510,000 (Guide price)
Located within close proximity of local amenities and boasting views of the surrounding countryside, is this well proportioned 5 bedroom detached family home which has been extensively extended. Offering 1689 sqft of accommodation over two storeys and benefitting from a generous plot, 34 Hawleys Close features well presented gardens, ample off street parking and a double garage.

The ground floor comprises; Spacious entrance hallway, dual aspect family living room with gas fireplace and patio doors onto the rear garden, formal dining room, open plan dining kitchen with granite worktops and breakfast nook, home office space and WC.

The first floor comprises; Master bedroom with built in wardrobe space and recently refurbished ensuite shower room, 3 further generously proportioned bedrooms, single bedroom and family bathroom.

**Dales and Peaks ForwardMove
- Please read**



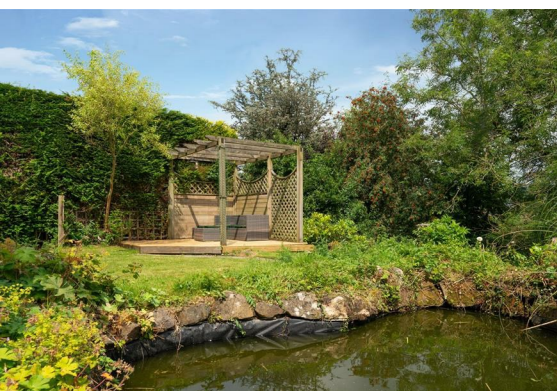

Floor Plan

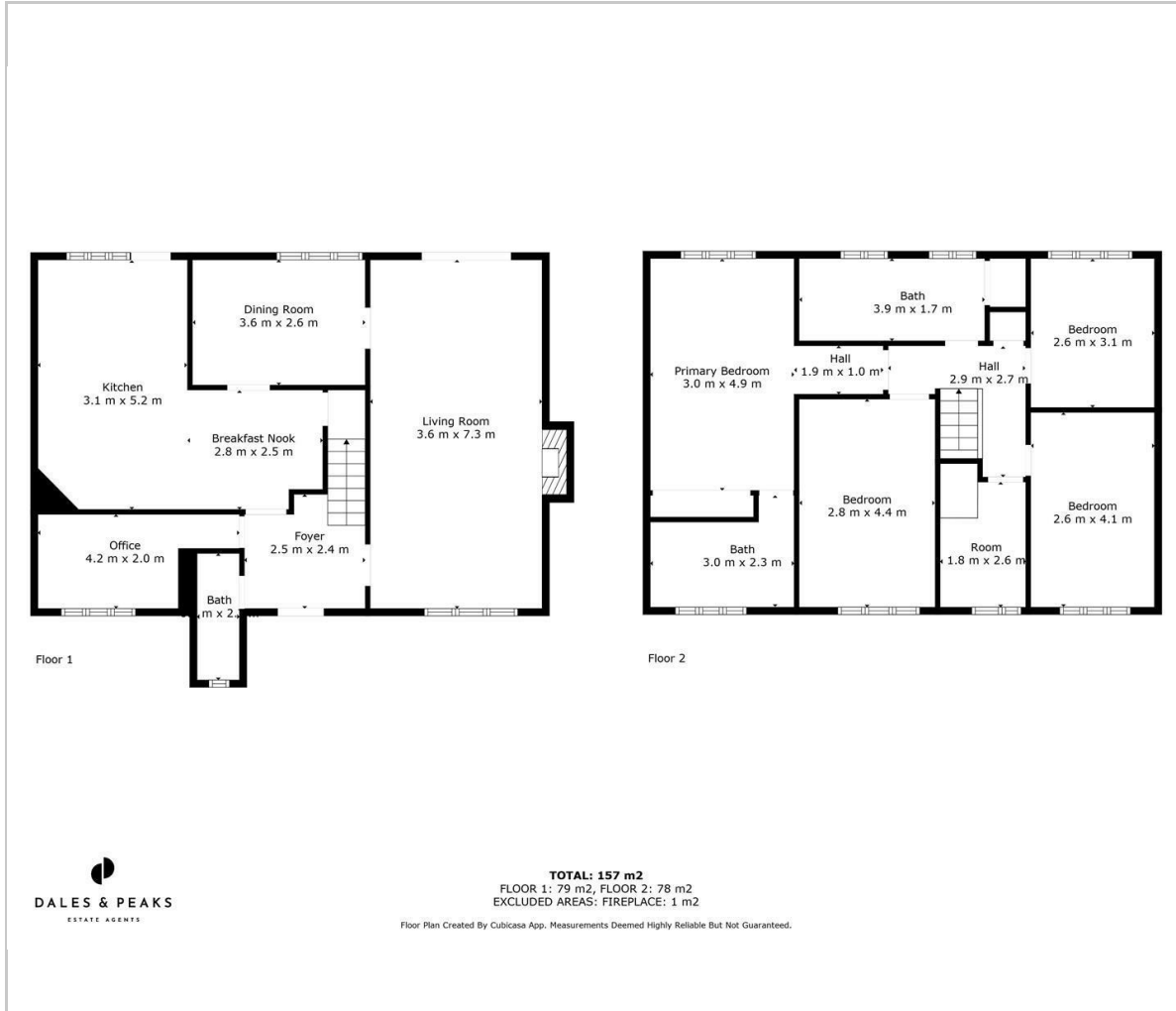

Area Map



Viewing

Please contact our Matlock Office on 01629 700246 if you wish to arrange a viewing appointment for this property or require further information.

Energy Efficiency Graph

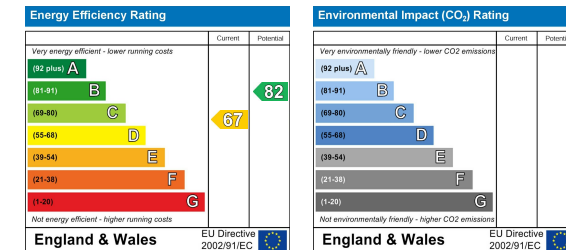

These particulars, whilst believed to be accurate are set out as a general outline only for guidance and do not constitute any part of an offer or contract. Intending purchasers should not rely on them as statements of representation of fact, but must satisfy themselves by inspection or otherwise as to their accuracy. No person in this firm's employment has the authority to make or give any representation or warranty in respect of the property.



2 Dale Road, Matlock, Derbyshire, DE4 3LT
 T: 01629 700246

E: info@dalesandpeaks.co.uk
 www.dalesandpeaks.co.uk