

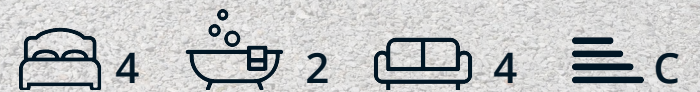

High Moor House

Darley Moor, Matlock, DE4 5LJ

£625,000



High Moor House

Darley Moor, Matlock, DE4 5LJ

A well presented and individual 3/4 bedroom family home within a peaceful and exceptionally desirable rural setting, on the fringe of the Peak District National Park. Sat in a plot of approximately 0.42 acres, the property offers a private drive providing ample parking, a double garage and beautifully presented gardens, backing onto neighbouring fields and benefits from a 1 bedroom detached property with opportunity for holiday let.

The ground floor comprises; An extensive dual aspect living room with double sided fireplace complete with a multi-fuel stove, through to the well appointed dining kitchen which features integrated appliances, conservatory with views of the garden, second reception room offering versatile use for a home office, snug or 4th bedroom. Utility room and downstairs WC.

The first floor comprises; A spacious landing providing ample storage, 3 generously proportioned double bedrooms and family bathroom.

The holiday cottage comprises; Front aspect living room, fitted kitchen, double bedroom, shower room and private garden backing onto fields.

Dales and Peaks ForwardMove - Please read





Floor Plan

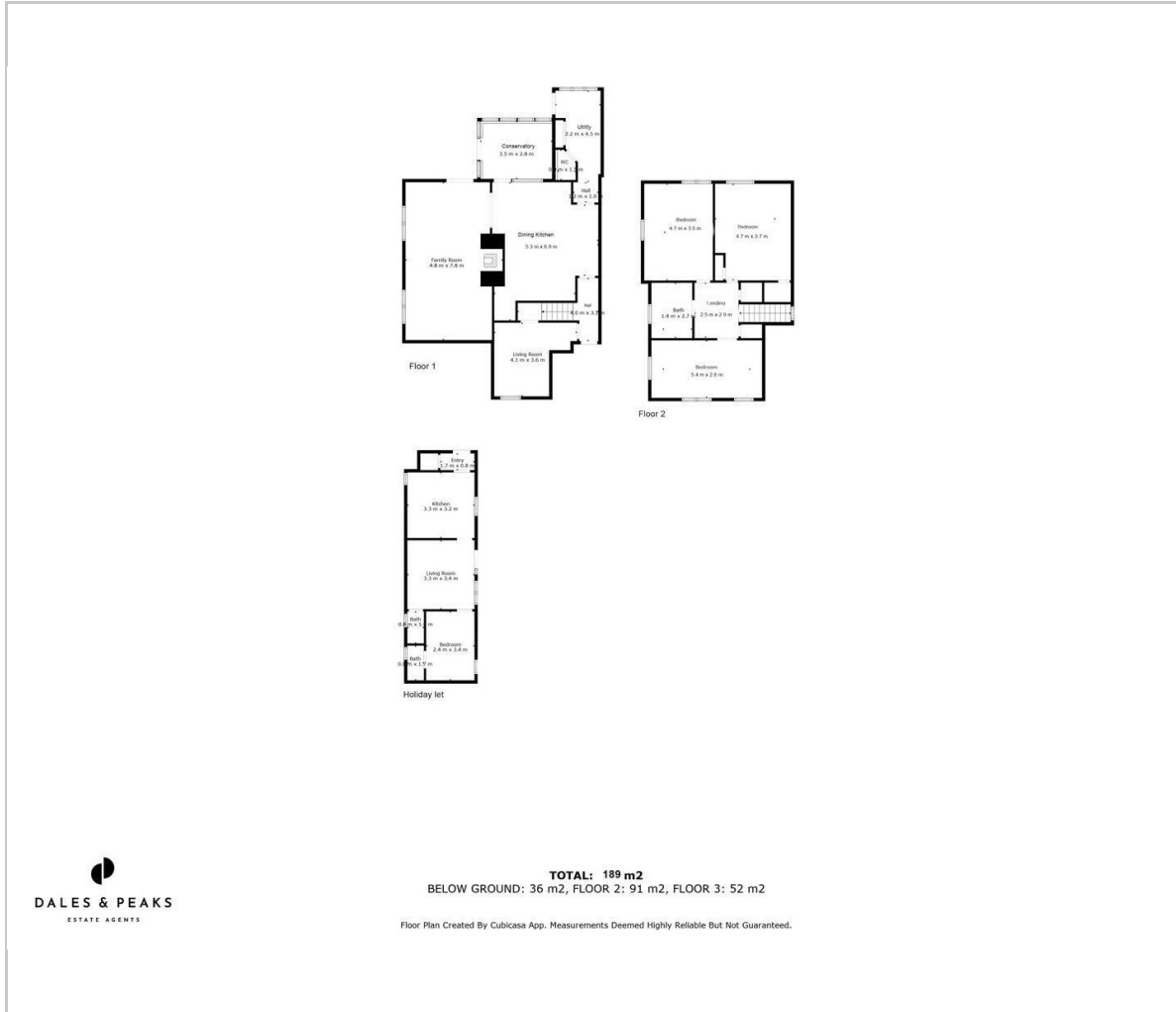

Viewing

Please contact our Matlock Office on 01629 700246 if you wish to arrange a viewing appointment for this property or require further information.

These particulars, whilst believed to be accurate are set out as a general outline only for guidance and do not constitute any part of an offer or contract. Intending purchasers should not rely on them as statements of representation of fact, but must satisfy themselves by inspection or otherwise as to their accuracy. No person in this firm's employment has the authority to make or give any representation or warranty in respect of the property.

Area Map



Energy Efficiency Graph

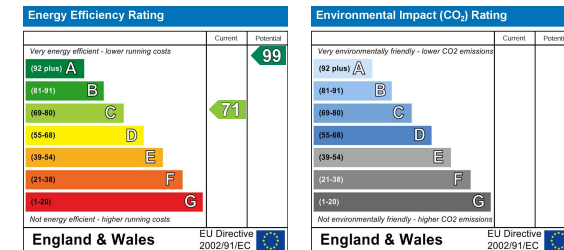

2 Dale Road, Matlock, Derbyshire, DE4 3LT
T: 01629 700246



E: info@dalesandpeaks.co.uk
www.dalesandpeaks.co.uk