



High Court Smith Road
, Matlock, DE4 3JL

£700 PCM



High Court Smith Road

, Matlock, DE4 3JL

A well presented first floor two bedroom apartment situated within close proximity of Matlock town centre with far reaching views of Derwent Valley.

The apartment briefly comprises; entrance hallway, spacious living room, fitted kitchen, two bedrooms and bathroom with shower over bath.

The apartment benefits from being located close to Matlock town centre with access to many local amenities, shops bars and restaurants.

For fee information please copy and paste the link below for our tenant brochure

https://ggfx-dalesandpeaks.s3.eu-west-2.amazonaws.com/i.prod/Tenants_broc

- * We are a member of the Propertymark Client Money Protection Scheme - propertymark.co.uk
- * We are a member of The Property Ombudsman Scheme - tpos.co.uk
- * We place all our deposits in the Deposit Protection Scheme DPS - depositprotection.com





Floor Plan

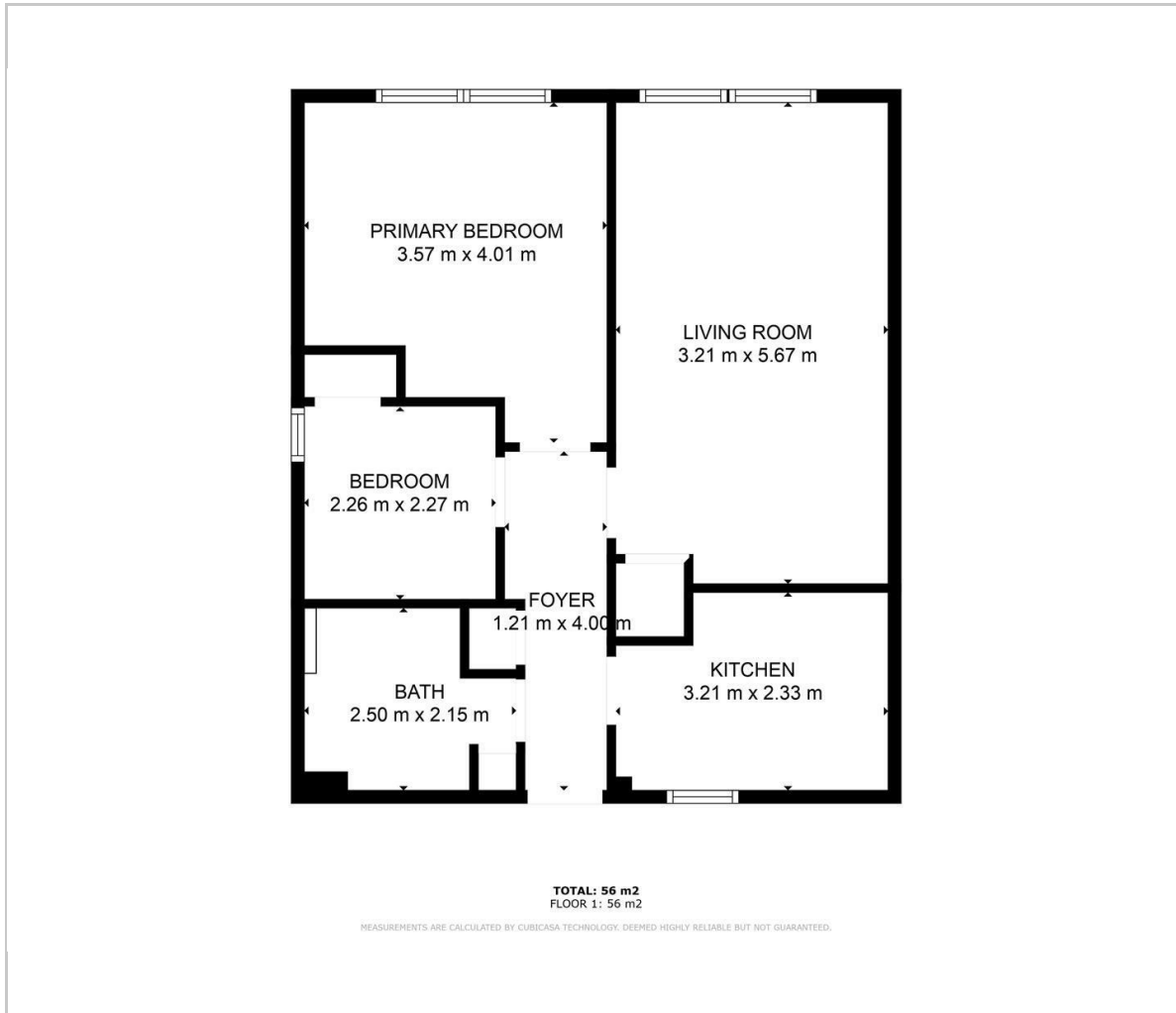

Viewing

Please contact our Matlock Office on 01629 700246 if you wish to arrange a viewing appointment for this property or require further information.

These particulars, whilst believed to be accurate are set out as a general outline only for guidance and do not constitute any part of an offer or contract. Intending purchasers should not rely on them as statements of representation of fact, but must satisfy themselves by inspection or otherwise as to their accuracy. No person in this firm's employment has the authority to make or give any representation or warranty in respect of the property.

Area Map



Energy Efficiency Graph

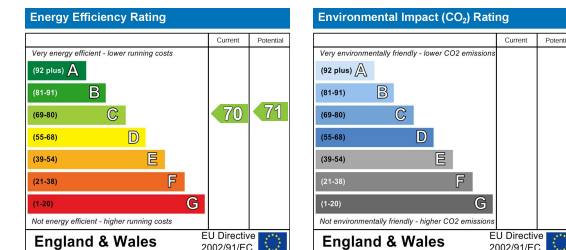

2 Dale Road, Matlock, Derbyshire, DE4 3LT
T: 01629 700246



E: info@dalesandpeaks.co.uk
www.dalesandpeaks.co.uk