

ANWYL
thoughtful homes

welcome to
Stonebridge Fold
Longridge



01772 286 095
.....

everything considered.

Stonebridge Fold

Phase two

ANWYL
thoughtful homes



This plan is a general site layout, not to scale and is intended for guidance only. It does not form any part of the contract. The plan does not show ownership boundaries, easements or wayleaves. Anwyl Homes reserve the right to alter or replan at any time. Please ask our site homes advisor for specific plot details. Turf to rear gardens is not provided. 01/12/21

everything considered.

ANWYL
thoughtful homes



the bretton

3 bed semi detached

A 3 bedroom semi-detached home. *Perfect* as a family starter home or for first-time buyers. Key features include an open plan kitchen/diner and master bedroom with en-suite.

www.anwylhomes.co.uk

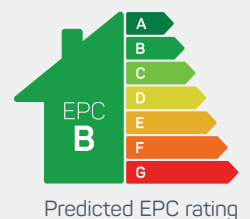

ideal for
first time buyers



ground floor

| | |
|----------------|---------------|
| kitchen/dining | 15'4" x 10'9" |
| living room | 16'8" x 12'0" |
| cloaks | 5'11" x 3'1" |

| | |
|----------------|---------------|
| kitchen/dining | 4.67m x 3.28m |
| living room | 5.08m x 3.66m |
| cloaks | 1.79m x 0.95m |

first floor

| | |
|-----------|---------------|
| bedroom 1 | 12'10" x 8'4" |
| en-suite | 8'4" x 5'6" |
| bedroom 2 | 11'0" x 8'4" |
| bedroom 3 | 7'7" x 6'8" |
| bathroom | 7'2" x 6'8" |

| | |
|-----------|---------------|
| bedroom 1 | 3.91m x 2.53m |
| en-suite | 2.53m x 1.67m |
| bedroom 2 | 3.35m x 2.53m |
| bedroom 3 | 2.30m x 2.04m |
| bathroom | 2.18m x 2.02m |

the bretton
3 bed semi detached

ANWYL
thoughtful homes

NEW HOMES QUALITY CODE

NEW HOMES OMBUDSMAN SERVICE

www.anwylhomes.co.uk

Anwyl Homes is a Registered Developer with the NHQB. This is a computer-generated image of the bretton, elevation treatment may vary. Room sizes are approximate, dimensions are taken from the longest room point (please consult homes advisor for measurement points). Plots may be handed and any garages may be single or double. Kitchen and bathroom layouts are indicative. These plans are correct at the time of going to press, but may be subject to change during construction. Please ensure that you check for specific plot details. 01/11/22.

everything considered.



the lymm

4 bed detached with garage

A *spacious* 4-bedroom detached home. The Lymm is thoughtfully designed to make the most of the space available, providing a well-planned open plan living space and a separate lounge in which to relax. Boasting 4 generously sized bedrooms, integral garage, lovely high ceilings and a roofed porch the Lymm is designed for today's family.

www.anwylhomes.co.uk

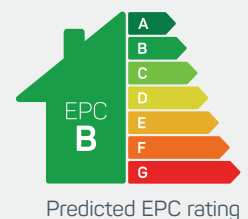

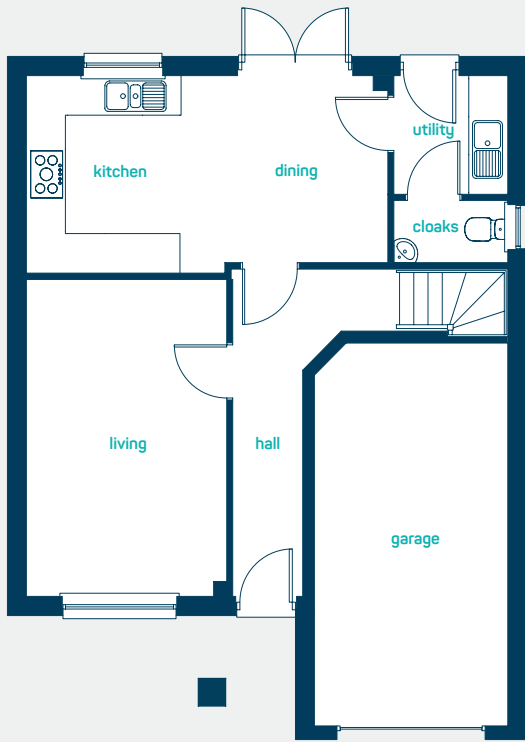

large open plan
kitchen diner

ground floor

| | |
|----------------|----------------|
| kitchen/dining | 18'11" x 10'1" |
| utility | 6'1" x 5'11" |
| living room | 16'3" x 10'5" |
| cloaks | 5'11" x 3'2" |
| | |
| kitchen/dining | 5.76m x 3.07m |
| utility | 1.85m x 1.80m |
| living room | 4.96m x 3.18m |
| cloaks | 1.80m x 0.96m |

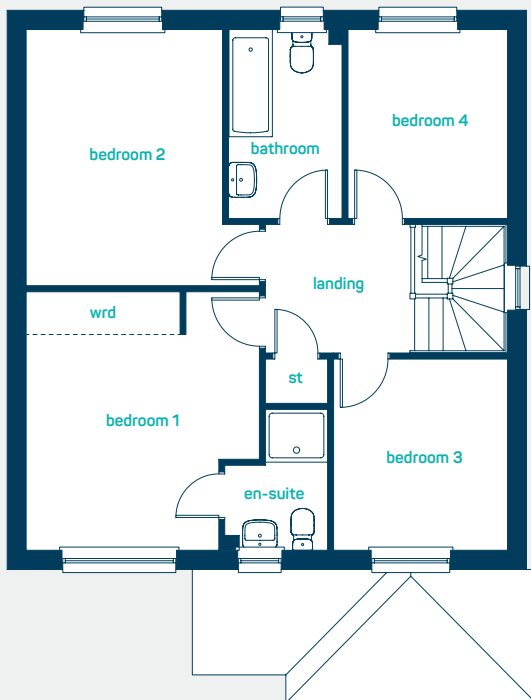

first floor

| | |
|-----------|---------------|
| bedroom 1 | 13'4" x 12'2" |
| en-suite | 7'3" x 5'5" |
| bedroom 2 | 13'2" x 12'2" |
| bedroom 3 | 9'10" x 9'1" |
| bedroom 4 | 9'9" x 8'4" |
| bathroom | 9'9" x 6'0" |
| | |
| bedroom 1 | 4.06m x 3.71m |
| en-suite | 2.20m x 1.65m |
| bedroom 2 | 4.02m x 3.71m |
| bedroom 3 | 3.00m x 2.76m |
| bedroom 4 | 2.96m x 2.53m |
| bathroom | 2.96m x 1.82m |

the lymm
4 bed detached with garage

ANWYL
thoughtful homes

NEW HOMES QUALITY CODE

NEW HOMES OMBUDSMAN SERVICE

www.anwylhomes.co.uk

Anwyl Homes is a Registered Developer with the NHQB. This is a computer-generated image of the lymm, elevation treatment may vary. Room sizes are approximate, dimensions are taken from the longest room point (please consult homes advisor for measurement points). Plots may be handed and any garages may be single or double. Kitchen and bathroom layouts are indicative. These plans are correct at the time of going to press, but may be subject to change during construction. Please ensure that you check for specific plot details. 01/11/22 (grand version).

everything considered.

ANWYL
thoughtful homes



the farndon

4 bed detached

A *spacious* 4 bedroom detached family home. Key features include a large separate living room, master bedroom with en-suite and open plan kitchen, dining room.

www.anwylhomes.co.uk

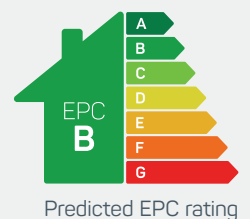

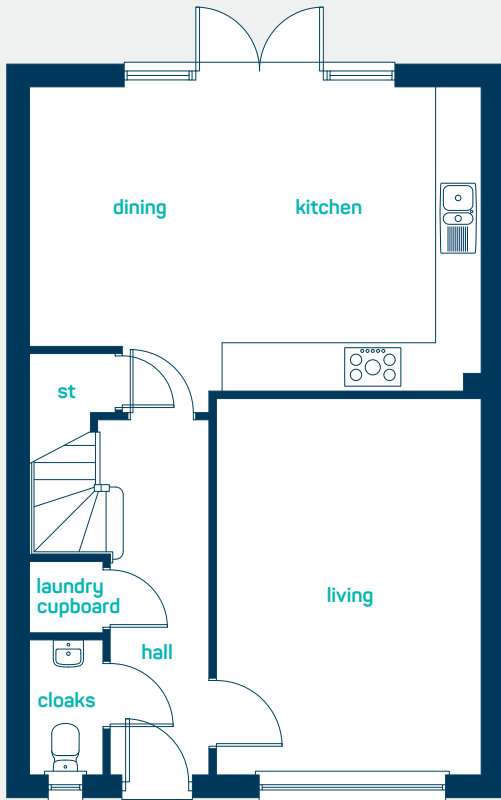

ideal for
spacious living

ground floor

| | |
|------------------|---------------|
| kitchen/dining | 19'7" x 13'2" |
| laundry cupboard | 3'2" x 2'11" |
| cloaks | 5'10" x 3'2" |
| living room | 16'4" x 11'5" |

| | |
|------------------|---------------|
| kitchen/dining | 5.97m x 4.01m |
| laundry cupboard | 0.96m x 0.90m |
| cloaks | 1.78m x 0.96m |
| living room | 4.97m x 3.48m |

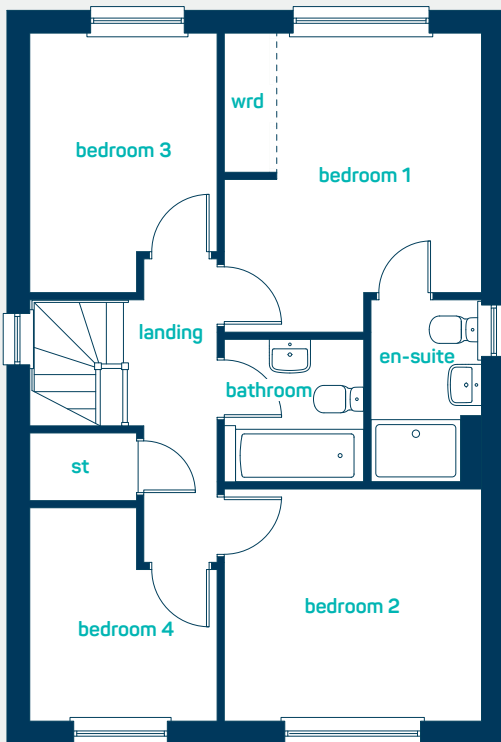

first floor

| | |
|-----------|---------------|
| bedroom 1 | 13'0" x 11'2" |
| en-suite | 8'0" x 4'9" |
| bedroom 2 | 11'2" x 10'0" |
| bedroom 3 | 11'2" x 8'1" |
| bedroom 4 | 9'2" x 8'0" |
| bathroom | 6'3" x 6'1" |

| | |
|-----------|---------------|
| bedroom 1 | 3.96m x 3.40m |
| en-suite | 2.43m x 1.45m |
| bedroom 2 | 3.40m x 3.05m |
| bedroom 3 | 3.41m x 2.47m |
| bedroom 4 | 2.80m x 2.45m |
| bathroom | 1.90m x 1.86m |



the farndon
4 bed detached

ANWYL
thoughtful homes

NEW HOMES QUALITY CODE

NEW HOMES OMBUDSMAN SERVICE

www.anwylhomes.co.uk

Anwyl Homes is a Registered Developer with the NHQB. This is a computer-generated image of the farndon, elevation treatment may vary. Room sizes are approximate, dimensions are taken from the longest room point (please consult homes advisor for measurement points). Plots may be handed and any garages may be single or double. Kitchen and bathroom layouts are indicative. These plans are correct at the time of going to press, but may be subject to change during construction. Please ensure that you check for specific plot details. 01/11/22.

everything considered.

ANWYL
thoughtful homes



the ascot special

4 bed detached with garage

A 4 bedroom *detached* home. Key features include a separate living room, 4 double bedrooms and master bedroom with en-suite.

www.anwylhomes.co.uk

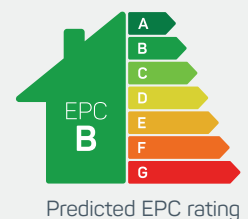

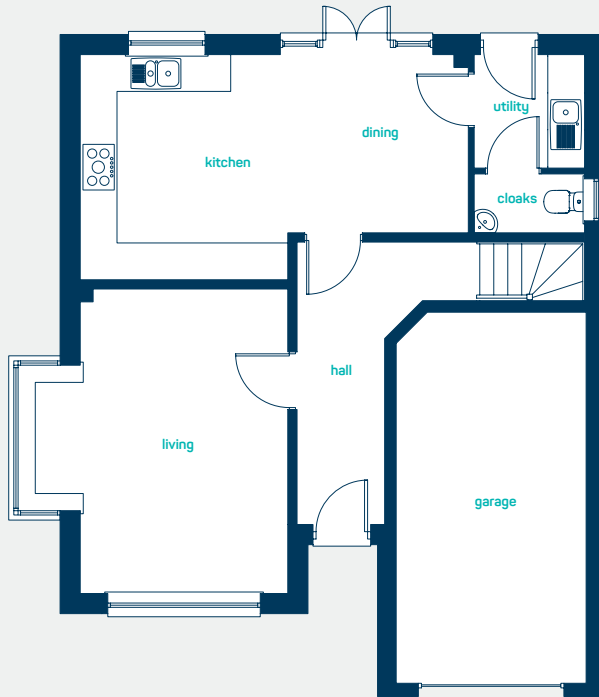

ideal for
spacious living

ground floor

kitchen/dining 20'9" x 12'1"
utility 6'1" x 5'11"
living room(inc bay) 16'4" x 13'8"
cloaks 5'11" x 3'2"

kitchen/dining 6.33m x 3.67m
utility 1.85m x 1.80m
living room(inc bay) 4.96m x 4.17m
cloaks 1.80m x 0.96m

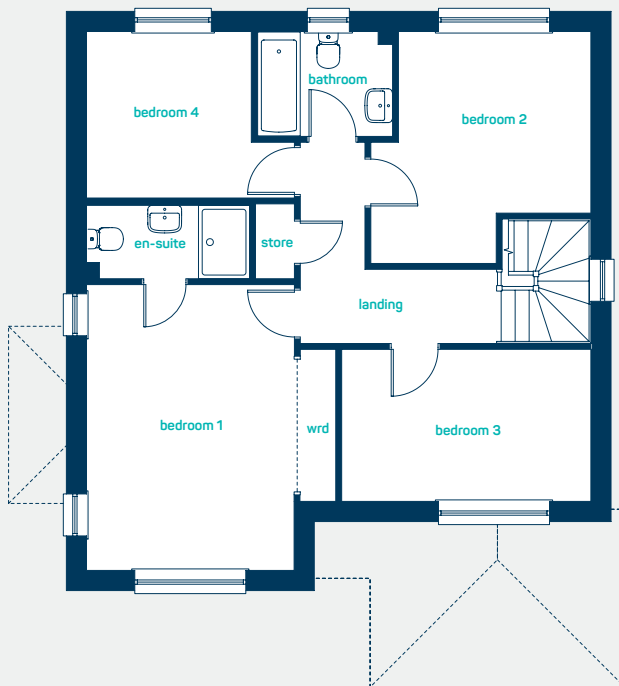

first floor

bedroom 1 15'4" x 13'4"
en-suite 8'9" x 3'11"
bedroom 2 12'5" x 11'9"
bedroom 3 13'4" x 8'2"
bedroom 4 11'1" x 8'11"
bathroom 7'3" x 5'7"

bedroom 1 4.66m x 4.06m
en-suite 2.66m x 1.20m
bedroom 2 3.78m x 3.59m
bedroom 3 4.06m x 2.48m
bedroom 4 3.39m x 2.71m
bathroom 2.21m x 1.71m

the ascot special
4 bed detached with garage

ANWYL
thoughtful homes

**NEW
HOMES
QUALITY
CODE**

**NEW HOMES
SERVICE
OMBUDSMAN**

www.anwylhomes.co.uk

Anwyl Homes is a Registered Developer with the NHQB. This is a computer-generated image of the ascot special, elevation treatment may vary. Room sizes are approximate, dimensions are taken from the longest room point (please consult homes advisor for measurement points). Plots may be handed and any garages may be single or double. Kitchen and bathroom layouts are indicative. These plans are correct at the time of going to press, but may be subject to change during construction. Please ensure that you check for specific plot details. 01/11/22.

everything considered.

ANWYL
thoughtful homes



the henley

4 bed detached with garage

A *traditional* 4 bedroom detached home. Designed to capture the essence of traditional house building with lovely high ceilings, beautiful bay windows and a roofed porch. Step inside and the henley is thoughtfully designed for modern family life with open plan family space, separate living room and generously sized bedrooms on offer.

www.anwylhomes.co.uk

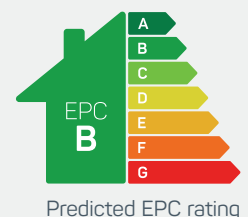



Large open plan
family space

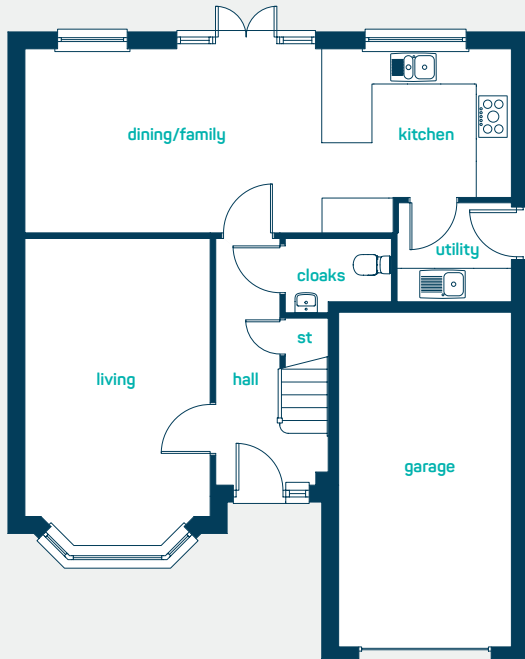

ground floor

| | |
|---------------------------|---------------|
| kitchen/dining/ family | 28'6" x 10'8" |
| utility | 6'1" x 5'10" |
| living room | 18'0" x 10'9" |
| cloaks | 6'8" x 4'3" |
| | |
| kitchen/dining/ family | 8.67m x 3.25m |
| utility | 1.85m x 1.76m |
| living room | 5.48m x 3.27m |
| cloaks | 2.03m x 1.31m |

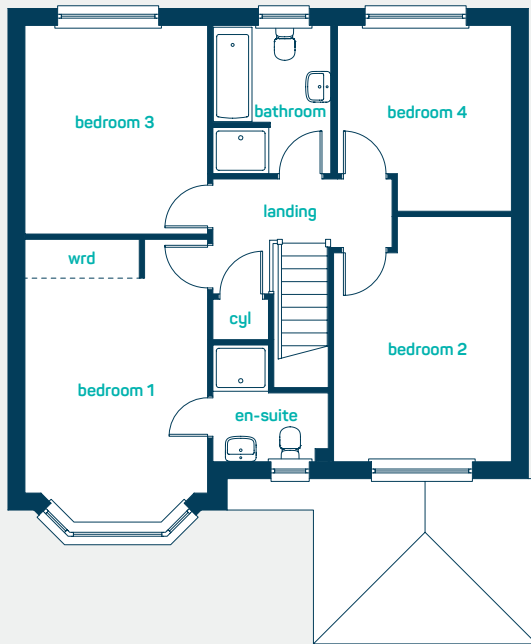

first floor

| | |
|-----------|----------------|
| bedroom 1 | 16'9" x 10'8" |
| en-suite | 6'9" x 6'9" |
| bedroom 2 | 14'4" x 10'5" |
| bedroom 3 | 12'2" x 10'8" |
| bedroom 4 | 10'10" x 10'2" |
| bathroom | 8'6" x 6'11" |
| | |
| bedroom 1 | 5.09m x 3.25m |
| en-suite | 2.07m x 2.07m |
| bedroom 2 | 4.37m x 3.16m |
| bedroom 3 | 3.72m x 3.25m |
| bedroom 4 | 3.31m x 3.09m |
| bathroom | 2.60m x 2.11m |

the henley
4 bed detached with garage

ANWYL
thoughtful homes

**NEW
HOMES
QUALITY
CODE**

**NEW HOMES
OMBUDSMAN
SERVICE**

www.anwylhomes.co.uk

Anwyl Homes is a Registered Developer with the NHQB. This is a computer-generated image of the henley, elevation treatment may vary. Room sizes are approximate, dimensions are taken from the longest room point (please consult homes advisor for measurement points). Plots may be handed and any garages may be single or double. Kitchen and bathroom layouts are indicative. These plans are correct at the time of going to press, but may be subject to change during construction. Please ensure that you check for specific plot details. 01/11/22 (grand version).

everything considered.

ANWYL
thoughtful homes



the hartford

4 bed detached with garage

A *spacious* modern 4 bedroom detached home. Key features include feature high ceilings, separate living room, integral garage and an *open plan* kitchen diner.

www.anwylhomes.co.uk

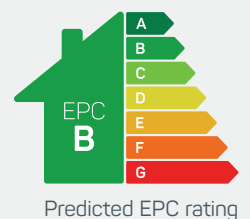

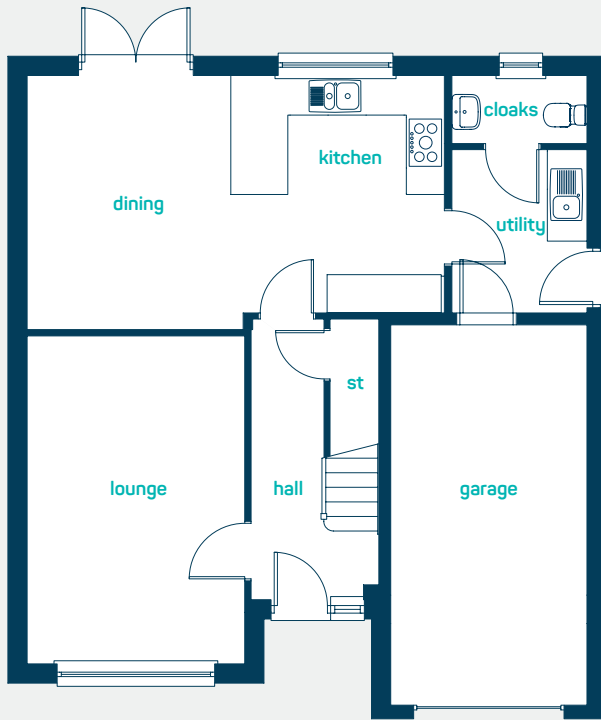

Ideal for growing families

ground floor

kitchen/dining 21'6" x 13'0"
 utility 8'6" x 6'11"
 living room 16'10" x 11'1"
 cloaks 6'11" x 3'5"

kitchen/dining 6.56m x 3.96m
 utility 2.58m x 2.11m
 living room 5.13m x 3.38m
 cloaks 2.11m x 1.05m

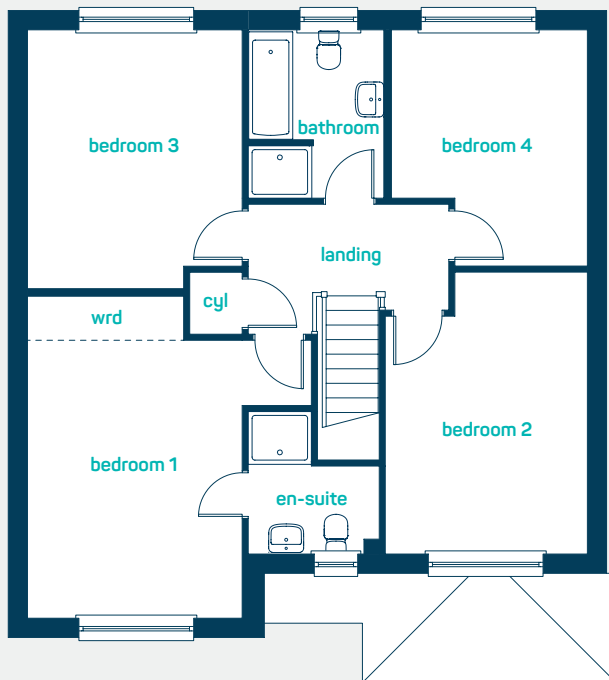

first floor

bedroom 1 16'7" x 11'0"
 en-suite 7'4" x 6'9"
 bedroom 2 14'6" x 10'5"
 bedroom 3 13'4" x 11'0"
 bedroom 4 12'2" x 10'1"
 bathroom 8'8" x 7'0"

bedroom 1 5.06m x 3.36m
 en-suite 2.22m x 2.07m
 bedroom 2 4.42m x 3.16m
 bedroom 3 4.06m x 3.36m
 bedroom 4 3.70m x 3.07m
 bathroom 2.63m x 2.14m

the hartford
 4 bed detached with garage

ANWYL
 thoughtful homes

NEW HOMES QUALITY CODE

NEW HOMES OMBUDSMAN SERVICE

www.anwylhomes.co.uk

Anwyl Homes is a Registered Developer with the NHQB. This is a computer-generated image of the hartford, elevation treatment may vary. Room sizes are approximate, dimensions are taken from the longest room point (please consult homes advisor for measurement points). Plots may be handed and any garages may be single or double. Kitchen and bathroom layouts are indicative. These plans are correct at the time of going to press, but may be subject to change during construction. Please ensure that you check for specific plot details. 01/11/22.

everything considered.



the oakmere

4 bed detached

An *impressive* 4 bedroom detached home, ideal for families.
Key features include large open plan kitchen, dining and family room with a separate living room, utility and study.

www.anwylhomes.co.uk

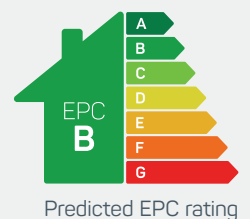

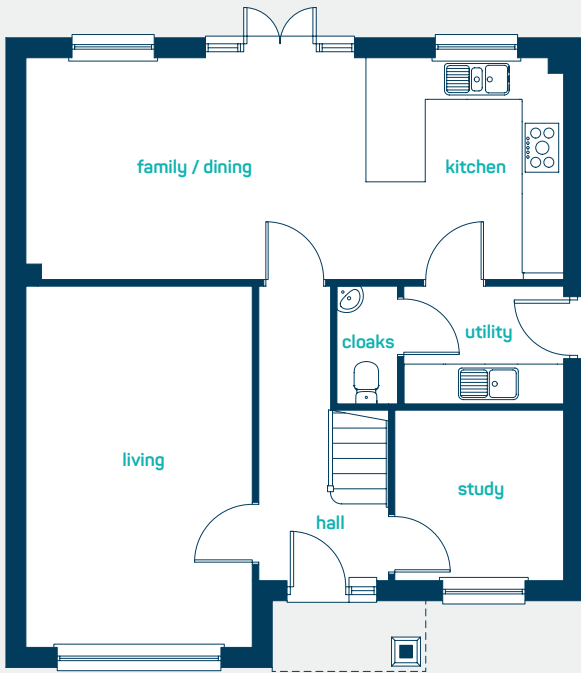

ground floor

| | |
|----------------|----------------|
| kitchen/dining | 26'7" x 10'11" |
| utility | 7'11" x 5'9" |
| living room | 17'10" x 11'1" |
| study | 8'5" x 8'4" |
| cloaks | 5'9" x 3'0" |
| | |
| kitchen/dining | 8.11m x 3.32m |
| utility | 2.40m x 1.76m |
| living room | 5.43m x 3.38m |
| study | 2.56m x 2.54m |
| cloaks | 1.76m x 0.92m |

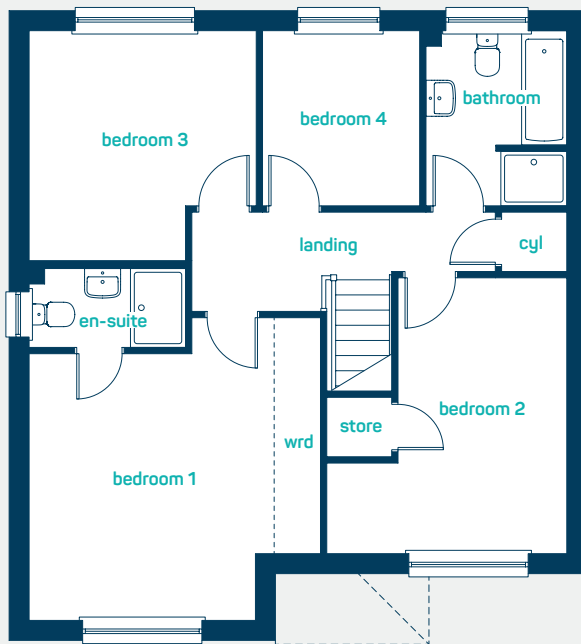

first floor

| | |
|-----------|----------------|
| bedroom 1 | 15'0" x 14'5" |
| en-suite | 7'9" x 3'11" |
| bedroom 2 | 13'8" x 11'10" |
| bedroom 3 | 11'4" x 11'3" |
| bedroom 4 | 8'8" x 7'10" |
| bathroom | 8'8" x 6'11" |
| | |
| bedroom 1 | 4.57m x 4.40m |
| en-suite | 2.35m x 1.20m |
| bedroom 2 | 4.16m x 3.62m |
| bedroom 3 | 3.46m x 3.42m |
| bedroom 4 | 2.63m x 2.38m |
| bathroom | 2.63m x 2.11m |

the oakmere
4 bed detached

ANWYL
thoughtful homes

NEW HOMES QUALITY CODE

NEW HOMES SERVICE OMBUDSMAN

www.anwylhomes.co.uk

Anwyl Homes is a Registered Developer with the NHQB. This is a computer-generated image of the oakmere, elevation treatment may vary. Room sizes are approximate, dimensions are taken from the longest room point (please consult homes advisor for measurement points). Plots may be handed and any garages may be single or double. Kitchen and bathroom layouts are indicative. These plans are correct at the time of going to press, but may be subject to change during construction. Please ensure that you check for specific plot details. 01/11/22.

everything considered.

ANWYL
thoughtful homes



the delamere

4 bed detached with double garage

An *impressive* detached 4 bedroom family home. Generously proportioned and superbly designed the delamere offers open plan modern family living space in addition to a separate living room. Classic exteriors, feature high ceilings combined with modern and thoughtfully considered living space, make this the perfect family home.

www.anwylhomes.co.uk

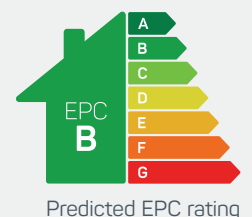



modern
open plan living

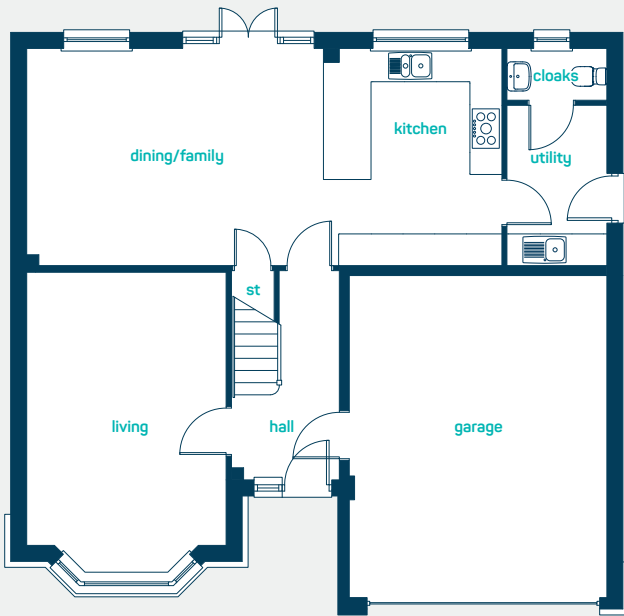

ground floor

| | |
|---------------------------|---------------|
| kitchen/dining/ family | 29'5" x 13'5" |
| utility | 9'11" x 6'1" |
| living room | 18'7" x 12'3" |
| cloaks | 6'1" x 3'2" |

| | |
|---------------------------|---------------|
| kitchen/dining/ family | 8.97m x 4.08m |
| utility | 3.03m x 1.87m |
| living room | 5.67m x 3.72m |
| cloaks | 1.87m x 0.95m |



first floor

| | |
|---------------|----------------|
| bedroom 1 | 16'2" x 13'1" |
| dressing room | 7'10" x 6'3" |
| en-suite 1 | 9'9" x 5'11" |
| bedroom 2 | 20'6" x 12'3" |
| en-suite 2 | 8'0" x 5'3" |
| bedroom 3 | 13'1" x 10'2" |
| bedroom 4 | 12'8" x 10'11" |
| bathroom | 9'1" x 8'1" |

| | |
|---------------|---------------|
| bedroom 1 | 4.92m x 3.99m |
| dressing room | 2.38m x 1.90m |
| en-suite 1 | 2.96m x 1.80m |
| bedroom 2 | 6.25m x 3.72m |
| en-suite 2 | 2.43m x 1.59m |
| bedroom 3 | 3.99m x 3.10m |
| bedroom 4 | 3.87m x 3.33m |
| bathroom | 2.76m x 2.46m |

the delamere
4 bed detached with double garage

ANWYL
thoughtful homes

**NEW
HOMES
QUALITY
CODE**

**NEW HOMES
OMBUDSMAN
SERVICE**

www.anwylhomes.co.uk

Anwyl Homes is a Registered Developer with the NHQB. This is a computer-generated image of the delamere, elevation treatment may vary. Room sizes are approximate, dimensions are taken from the longest room point (please consult homes advisor for measurement points). Plots may be handed and any garages may be single or double. Kitchen and bathroom layouts are indicative. These plans are correct at the time of going to press, but may be subject to change during construction. Please ensure that you check for specific plot details. 01/11/22.

everything considered.

ANWYL
thoughtful homes



the caernarfon at stonebridge fold

4 bed detached with double garage

A *spacious* family home. Key features include high ceilings, an open plan kitchen dining and family room with French doors, a double garage, separate living room, media room and a large utility.

www.anwylhomes.co.uk

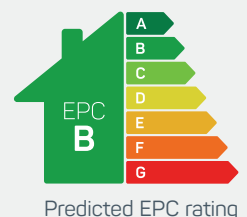



ideal for
modern family living

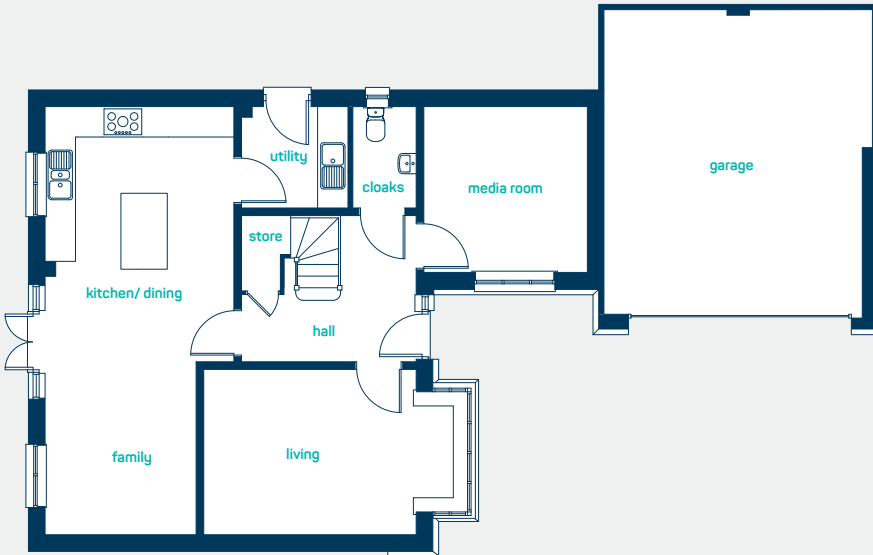

ground floor

| | |
|---------------------------|---------------|
| kitchen/ dining/family | 27'9" x 12'3" |
| utility | 6'11" x 6'7" |
| living room | 16'4" x 10'8" |
| media room | 10'9" x 10'7" |
| cloaks | 6'7" x 4'1" |

| | |
|---------------------------|---------------|
| kitchen/ dining/family | 8.45m x 3.73m |
| utility | 2.1m x 2m |
| living room | 4.98m x 3.26m |
| media room | 3.27m x 3.23m |
| cloaks | 2m x 1.25m |

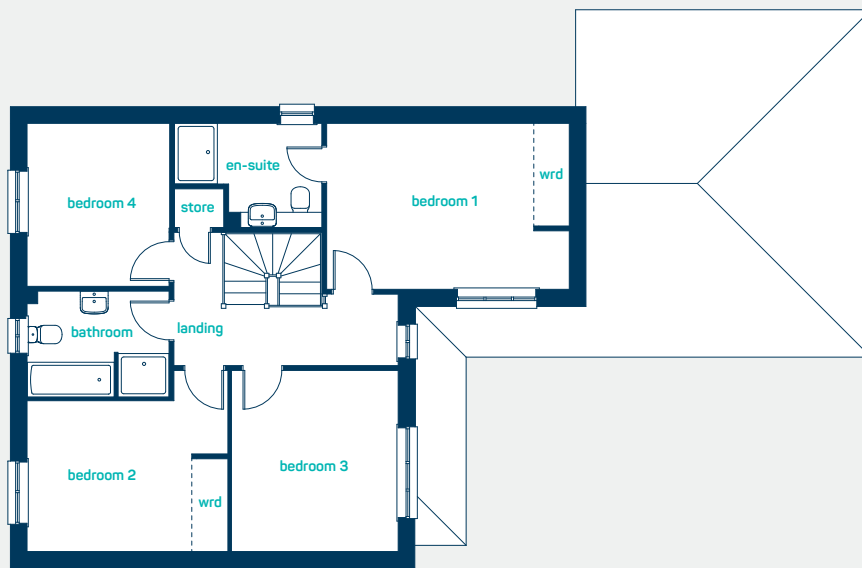

first floor

| | |
|-----------|---------------|
| bedroom 1 | 15'9" x 10'9" |
| en suite | 9'6" x 6'9" |
| bedroom 2 | 13' x 11'9" |
| bedroom 3 | 11'9" x 10'9" |
| bedroom 4 | 10'6" x 9'2" |
| bathroom | 9'2" x 6'9" |

| | |
|-----------|---------------|
| bedroom 1 | 4.79m x 3.27m |
| en suite | 2.89m x 2.06m |
| bedroom 2 | 3.95m x 3.57m |
| bedroom 3 | 3.57m x 3.28m |
| bedroom 4 | 3.2m x 2.8m |
| bathroom | 2.8m x 2.07m |

the caernarfon
at stonebridge fold
4 bed detached with double garage

www.anwyhomes.co.uk

ANWYL
thoughtful homes

**NEW
HOMES
QUALITY
CODE**

**NEW HOMES
OMBUDSMAN
SERVICE**

Anwyl Homes is a Registered Developer with the NHQB. This is a computer-generated image of the caernarfon, elevation treatment may vary. Room sizes are approximate, dimensions are taken from the longest room point (please consult homes advisor for measurement points). Plots may be handed and any garages may be single or double. Kitchen and bathroom layouts are indicative. These plans are correct at the time of going to press, but may be subject to change during construction. Please ensure that you check for specific plot details. 01/11/22.

everything considered.

got questions?
call 01772 286 095



Email: stonebridgefold@anwyl.co.uk
Stonebridge Fold, Whittingham Road, Longridge, Preston, PR3 2AB
anwylhomes.co.uk/stonebridge

everything considered.