

ANWYL  
thoughtful homes



**the henley**  
4 bed detached with garage

A *traditional* 4 bedroom detached home. Designed to capture the essence of traditional house building with lovely high ceilings, beautiful bay windows and a roofed porch. Step inside and the henley is thoughtfully designed for modern family life with open plan family space, separate living room and generously sized bedrooms on offer.

[www.anwylhomes.co.uk](http://www.anwylhomes.co.uk)

got  
questions?

call...  
**03300  
244 944**

*everything considered.*



Large open plan  
family space

**ANWYL**  
thoughtful homes

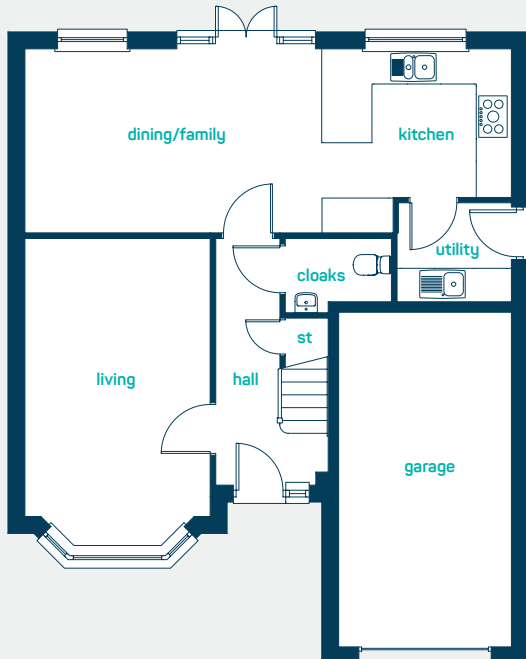

### ground floor

kitchen/dining/ family	28'6" x 10'8"
utility	6'1" x 5'10"
living room	18'0" x 10'9"
cloaks	6'8" x 4'3"
kitchen/dining/ family	8.67m x 3.25m
utility	1.85m x 1.76m
living room	5.48m x 3.27m
cloaks	2.03m x 1.31m

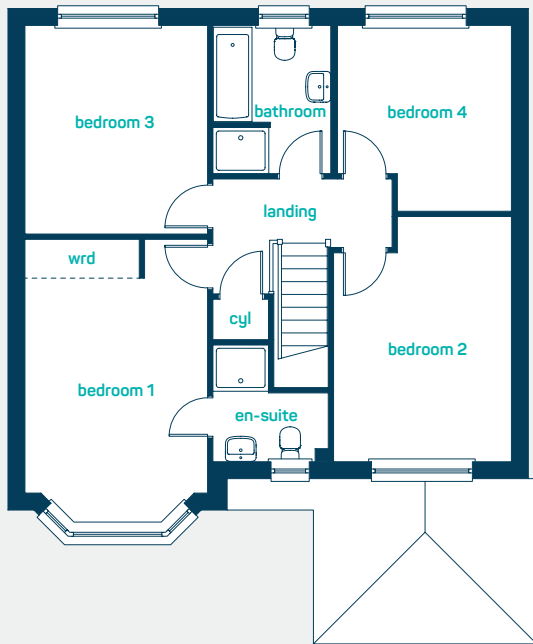

### first floor

bedroom 1	16'9" x 10'8"
en-suite	6'9" x 6'9"
bedroom 2	14'4" x 10'5"
bedroom 3	12'2" x 10'8"
bedroom 4	10'10" x 10'2"
bathroom	8'6" x 6'11"
bedroom 1	5.09m x 3.25m
en-suite	2.07m x 2.07m
bedroom 2	4.37m x 3.16m
bedroom 3	3.72m x 3.25m
bedroom 4	3.31m x 3.09m
bathroom	2.60m x 2.11m

get in  
touch...  
**03300  
244 944**

# the henley

4 bed detached with garage

[www.anwyllhomes.co.uk](http://www.anwyllhomes.co.uk)

This is a computer generated image of the henley, elevation treatment may vary. Room sizes are approximate, dimensions are taken from the longest room point (please consult homes advisor for measurement points). Plots may be handed and any garages may be single or double. Kitchen and bathroom layouts are indicative. These plans are correct at the time of going to press, but may be subject to change during construction. Please ensure that you check for specific plot details. 13/12/19 (grand version).

*everything considered.*