

ANWYL
thoughtful homes



the delamere

4 bed detached with double garage

An *impressive* detached 4 bedroom family home. Generously proportioned and superbly designed the delamere offers open plan modern family living space in addition to a separate living room. Classic exteriors, feature high ceilings combined with modern and thoughtfully considered living space, make this the perfect family home.

www.anwylhomes.co.uk

got
questions?

call...

**03300
244 944**

everything considered.

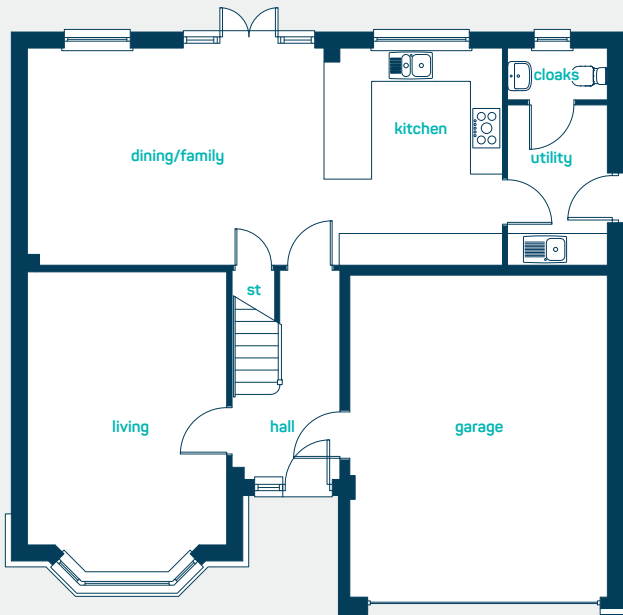

ground floor

| | |
|---------------------------|---------------|
| kitchen/dining/ family | 29'5" x 13'5" |
| utility | 9'11" x 6'1" |
| living room | 18'7" x 12'3" |
| cloaks | 6'1" x 3'2" |

| | |
|---------------------------|---------------|
| kitchen/dining/ family | 8.97m x 4.08m |
| utility | 3.03m x 1.87m |
| living room | 5.67m x 3.72m |
| cloaks | 1.87m x 0.95m |



first floor

| | |
|---------------|----------------|
| bedroom 1 | 16'2" x 13'1" |
| dressing room | 7'10" x 6'3" |
| en-suite 1 | 9'9" x 5'11" |
| bedroom 2 | 20'6" x 12'3" |
| en-suite 2 | 8'0" x 5'3" |
| bedroom 3 | 13'1" x 10'2" |
| bedroom 4 | 12'8" x 10'11" |
| bathroom | 9'1" x 8'1" |

| | |
|---------------|---------------|
| bedroom 1 | 4.92m x 3.99m |
| dressing room | 2.38m x 1.90m |
| en-suite 1 | 2.96m x 1.80m |
| bedroom 2 | 6.25m x 3.72m |
| en-suite 2 | 2.43m x 1.59m |
| bedroom 3 | 3.99m x 3.10m |
| bedroom 4 | 3.87m x 3.33m |
| bathroom | 2.76m x 2.46m |

the delamere

4 bed detached with double garage

www.anwylhomes.co.uk

This is a computer generated image of the delamere, elevation treatment may vary. Room sizes are approximate, dimensions are taken from the longest room point (please consult homes advisor for measurement points). Plots may be handed and any garages may be single or double. Kitchen and bathroom layouts are indicative. These plans are correct at the time of going to press, but may be subject to change during construction. Please ensure that you check for specific plot details.
13/12/19 (grand version).

get in
touch...
**03300
244 944**

everything considered.