



HEARTWOOD
HOMES

Sandridge Road, St. Albans, AL1 4AG

Offers Over £230,000

1 1 1



This charming one-bedroom ground floor conversion presents a wonderful opportunity to acquire a characterful yet comfortable home, thoughtfully combining period features with modern living. The bay-fronted living room is a welcoming space, filled with natural light and ideal for both relaxing evenings and entertaining guests. The recently refitted kitchen has been cleverly designed and is partially open to the living area, introducing a contemporary feel while maximising natural light and creating an enhanced sense of space and flow.

The property further benefits from a well-proportioned double bedroom with ample storage, and a stylish, modern shower room finished to a high standard. Positioned on the ground floor, the apartment offers easy accessibility and a convenient layout throughout. Offered to the market with no onward chain, this delightful home would make an ideal first-time purchase, downsizing opportunity, or investment, and early viewing is highly recommended to fully appreciate its charm and appeal.

Situated within the Bernard's Heath area of St Albans, the property occupies a sought-after and well-connected location, ideal for enjoying all that the city has to offer.



GROUND FLOOR
348 sq.ft. (32.4 sq.m.) approx.

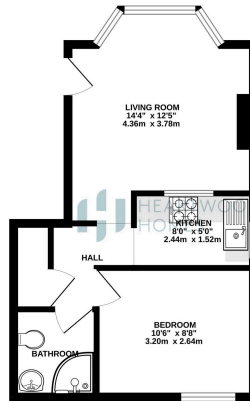

TOTAL FLOOR AREA: 348 sq.ft. (32.4 sq.m.) approx.
We warrant that the information contained in this document is true and correct to the best of our knowledge and belief at the time of preparation. We do not warrant the accuracy of the information contained in this document for any other purpose. The information contained in this document is for general information only and should not be relied upon for any specific purpose.



- Charming one-bedroom ground floor conversion
- Warm and inviting living space ideal for relaxing or entertaining
- Thoughtfully designed layout enhancing light, space, and overall flow
- Stylish modern shower room finished to a high standard
- Located in the desirable Bernard's Heath area of St Albans
- Bay-fronted living room filled with natural light
- Recently refitted kitchen with a contemporary finish
- Well-proportioned double bedroom
- Ground floor position offering easy accessibility and a practical layout
- EPC Grade C

