



HEARTWOOD
HOMES

Abbots Park, St. Albans, AL1 1TP

£475,000

3 2 2



This chain free townhouse gives you plenty of space to make your own, with flexible rooms that can easily adapt as life changes. It sits in a really handy spot, close to the mainline station for direct trips into London, well regarded local schools, and all the cafés, shops and leisure spots that make St Albans such a lovely place to enjoy your downtime.

Step inside and you'll find a welcoming hallway, a ground floor W.C and a large integral garage or workshop. It's a great space for anyone wanting a home studio, hobby room or even a quiet place to work once converted.

The first floor offers a bright kitchen and dining area that's made for relaxed mealtimes, with double doors opening into a comfortable living room where you can unwind at the end of the day.

Upstairs, the second floor has three bedrooms with good proportions plus a family bathroom.

Outside, there is off street parking for one car at the front and well kept communal gardens at the rear, giving you a pleasant green space without the upkeep.

If you'd like to explore how this home could fit your lifestyle, give us a call and we'll be happy to show you around.



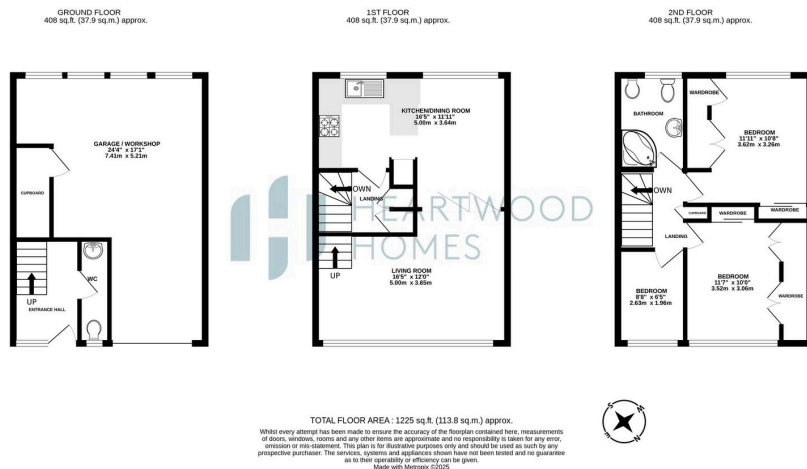

- Chain free townhouse with flexible living spaces
- Easy access to mainline station with direct London services
- Welcoming entrance hallway and ground floor W.C
- Bright kitchen and dining area for relaxed meals
- Off street parking and beautifully maintained communal gardens
- Prime location close to St Albans city centre
- Well regarded local schools nearby
- Large integral garage/workshop, perfect for a studio or home office
- Comfortable living room with plenty of natural light
- EPC Grade D

