



HEARTWOOD
HOMES

Springfield Road, St. Albans, AL1 5LY

Offers Over £300,000

🛏️ 2 🚿 1 🚗 1



A lovely two-bedroom first floor maisonette tucked away in a quiet cul-de-sac, just a short walk from St Albans mainline station and the historic city centre, where you'll find a great mix of shops, cafes, and pubs.

The property is bright and well presented throughout. It starts with the canopy porch, complete with a handy storage cupboard, which leads up to a private hallway. Upstairs, you'll find a spacious open-plan kitchen, living, and dining area with a modern fitted kitchen – perfect for both relaxing and entertaining. There are also two well-sized bedrooms and a stylish bathroom.

Outside, there's residents' parking to the front, and at the back, you'll find well-kept communal gardens.

Give us a call today to arrange your viewing – we'd love to show you around.



GROUND FLOOR
51 sq.ft. (4.7 sq.m.) approx.

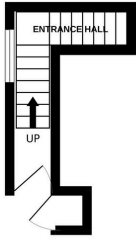

1ST FLOOR
538 sq.ft. (50.0 sq.m.) approx.

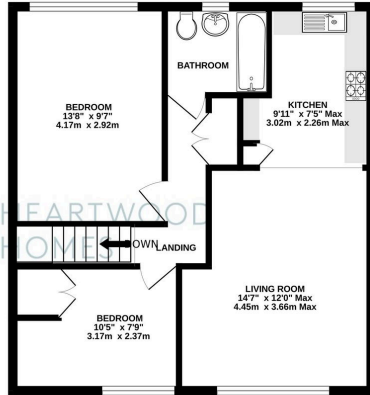

TOTAL FLOOR AREA: 589 sq.ft. (54.7 sq.m.) approx.

While every effort has been made to ensure the accuracy of the floorplan, measurements of doors, windows, rooms and any other items are approximate and no responsibility is taken for any error, omission or mis-statement. The plan shows approximate dimensions and locations and is not to be used as a guarantee of any kind. The plan is for information only and does not constitute an offer or guarantee as to their quantity or efficiency can be given. Made with Metreapp v2023



- Well-presented two-bedroom first floor maisonette
- Peaceful cul-de-sac setting, great for commuters
- Attractive bathroom
- EPC Rating C
- Modern open plan living
- Just a short walk to St Albans mainline station
- Residents' parking available to the front

