



Oakwood Drive, St. Albans, AL4 0XD

£875,000

3 1 2



This beautifully extended and improved 1930s three-bedroom home is perfectly positioned in a prime location, close to the highly sought-after Oakwood Primary and Beaumont Secondary schools. Nestled on the east side of St Albans, it's just a short stroll from a handy parade of shops and The Quadrant, where you'll find a great mix of shops, cafés, and restaurants. The mainline station is only 1.4 miles away, and the lovely Clarence Park is nearby. A little further on, St Albans' historic city centre offers fantastic shopping and leisure options.

Step inside to a welcoming entrance hall with plenty of storage and a convenient ground-floor W.C. The real heart of the home is the stunning open-plan dining/family room at the rear, seamlessly connecting to a stylish, contemporary kitchen. At the front, the generously sized bay-fronted living room, accessed via double doors, offers a bright and inviting space—perfect for both family life and entertaining.

Upstairs, there are three well-proportioned bedrooms and a beautifully presented family bathroom.

Outside, the landscaped rear garden is a real highlight, featuring a spacious patio ideal for relaxing, entertaining, and summer BBQs. The front driveway provides ample off-road parking, and there's a shared side access leading to the garden.

Homes in this fantastic location are always in high demand, so we highly recommend booking an early viewing to avoid missing out!



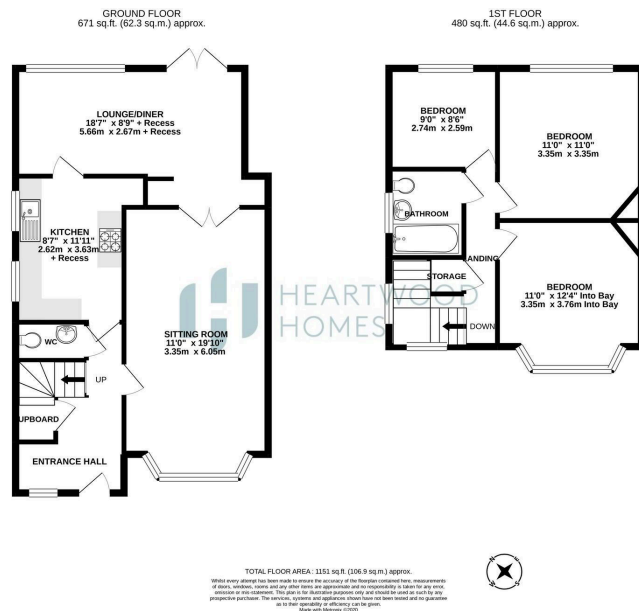

- Beautifully extended and improved 1930s three-bedroom home.
- Short walk to local shops, cafés, and The Quadrant.
- Welcoming entrance hall with ample storage and ground-floor W.C.
- Bright bay-fronted living room, perfect for entertaining.
- Landscaped rear garden with patio, ideal for relaxing and BBQs.
- Prime location near Oakwood Primary and Beaumont Secondary schools.
- Just 1.4 miles from the mainline station and close to Clarence Park.
- Stunning open-plan dining/family room leading to a modern kitchen.
- Three well-proportioned bedrooms and a stylish family bathroom.
- EPC Grade Awaited

