



HEARTWOOD  
HOMES



# Upper Culver Road, St. Albans, AL1 4EE

Offers Over £550,000

🛏 2 🍳 1 🛋 2



Nestled in the heart of the sought-after Bernards Heath Conservation area, this charming period home offers a wonderful blend of convenience and character. The location is truly special, with a lovely infant school at the end of the street, a handy corner shop with a post office, and a delightful coffee shop overlooking Bernards Heath – all just a short walk away. St Albans' lively city centre, bustling with shops, pubs, and restaurants, along with the mainline train station, is also within easy reach.

The home itself is beautifully presented, starting with a bright and welcoming living room featuring a charming fireplace, perfect for relaxing after a long day. There's a separate dining room leading to a well-sized kitchen, which opens onto a lovely garden – ideal for summer gatherings. Upstairs, you'll find two well-proportioned bedrooms and a contemporary family bathroom.

Outside, the front garden is neatly walled with gated access, adding extra charm to the home's appeal. The rear garden is spacious, well-maintained, and includes a sunny patio area that's perfect for relaxing outdoors.

This home truly captures the best of St Albans city living with easy access to London. Don't miss out – book your viewing today!





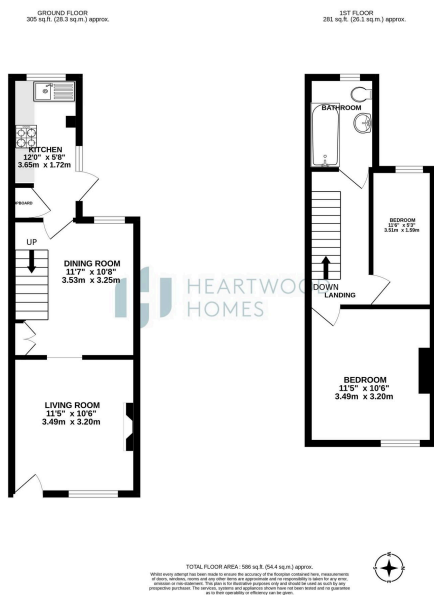

- Chain free
- Short walk to St Albans city centre and train station
- Separate dining room
- Two good-sized bedrooms
- Infant school, shop, and coffee spot nearby
- Period home in Bernards Heath Conservation area
- Bright living room with a cosy fireplace
- Spacious kitchen with garden access
- Modern family bathroom
- EPC awaited

