



St. Annes Road, London Colney, St. Albans, AL2 1LQ

Offers Over £600,000

3 2 3



This charming 3/4 bedroom 1930s semi-detached family home, with a bay front and spacious layout, is set on a highly sought-after road close to stunning countryside and lovely lakeside walks. London Colney offers a range of fantastic shops and highly regarded local schools, making this location a winner.

Inside, the extended layout makes the most of flexible spaces, starting with a roomy entrance hallway. To the left, you'll find a bright, bay-fronted living room that opens into a dining room and conservatory. The modern kitchen-breakfast room sits at the back, with convenient access to the garden. There's also a handy ground-floor shower room and a versatile room that could be a study or even a fourth bedroom.

Outside, a large block-paved driveway at the front provides ample off-street parking, while the beautiful rear garden features a generous patio perfect for gatherings, which steps up to a well-kept lawn with shrubs and borders.

Give us a call today to view this fantastic home and see everything it has to offer!



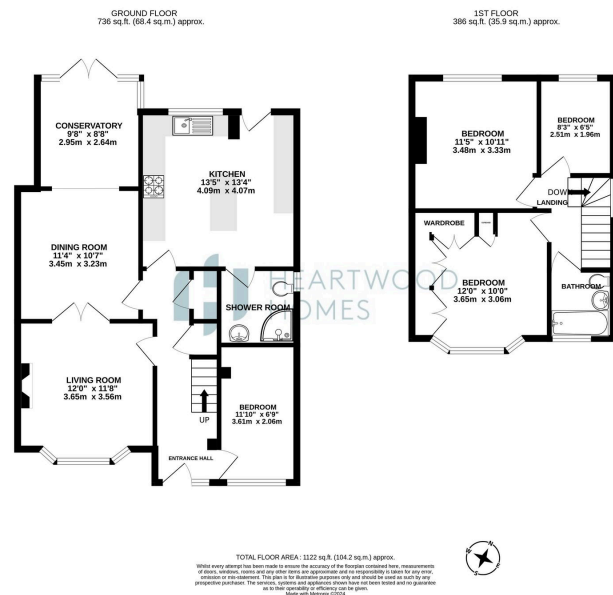

- Charming 1930s bay-fronted semi-detached family home with extended layout
- Close to London Colney's range of shops and well-regarded local schools
- Bright bay-fronted living room opens into dining room and conservatory
- Handy ground-floor shower room for added convenience
- Beautiful rear garden with a spacious patio, perfect for family time and entertaining
- Located on a popular road near scenic countryside and lovely lakeside walks
- Spacious entrance hallway leading to a flexible living space
- Modern kitchen-breakfast room with convenient garden access
- Large block-paved driveway offering plenty of off-street park
- EPC Grade D

