



HEARTWOOD
HOMES

High Street, Colney Heath

Offers Over £325,000

🛏️ 2 🚿 1 🚗 1



Offer chain free is this lovely two double bedroom ground floor maisonette, immaculately presented throughout this property benefits from off street parking and a shared garden.

You enter into the great size hallway, with plenty of room for coats and shoes, or to fit some built in storage/utility space. The modern fitted kitchen is towards the rear of the property and includes a great range of built in appliances and plenty of work top space. The living room is well proportioned and has a delightful feature fireplace. Two double bedrooms and the family bathroom with contemporary suite finishes the accommodation.

Externally the property has off street parking and shares a garden with one neighbour.



GROUND FLOOR
682 sq.ft. (63.3 sq.m.) approx.

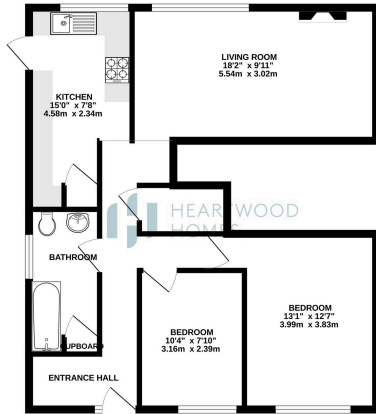

TOTAL FLOOR AREA: 682 sq.ft. (63.3 sq.m.) approx.
Where every effort has been made to ensure the accuracy of the figures contained here, measurements of this property should be taken from a professional surveyor or a qualified surveyor for any specific purposes. The accuracy, completeness and appropriateness of the information is not guaranteed. Please contact us for more information.



- Chain free
- Off street parking
- Modern fitted kitchen
- Shared garden
- Low leasehold charges
- Two double bedrooms
- Double glazed throughout
- EPC rating C

