



HEARTWOOD  
HOMES

# The Ridgeway, St. Albans, AL4 9TY

£425,000

🛏️ 2 🚿 1 🚿 1



This spacious and beautifully presented ground floor, split-level maisonette is located in the highly desirable Marshalswick area of St Albans. Just a short walk from excellent schools, the handy shopping and leisure spots at The Quadrant, and lovely countryside. Plus, St Albans City Centre, with its wider shopping and transport links, is just a quick drive away.

This fantastic home offers plenty of space, starting with the entrance hall that leads to a modern kitchen/breakfast room and a generous living/dining room with double doors opening onto a balcony.

Upstairs, you'll find two well-sized bedrooms, with the master boasting impressive dimensions of 17'5 x 12', along with a sleek, modern bathroom.

Outside, you'll enjoy the well-maintained communal grounds, residents' parking, and your very own garage.

Interested? Give us a call today to arrange a viewing—don't miss out on this lovely property!



GROUND FLOOR  
443 sq.ft. (41.1 sq.m.) approx.

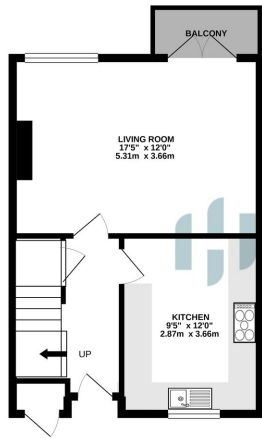

1ST FLOOR  
447 sq.ft. (41.5 sq.m.) approx.

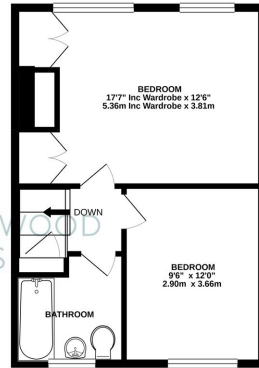

TOTAL FLOOR AREA: 890 sq.ft. (82.6 sq.m.) approx.  
 Whilst every effort has been made to ensure the accuracy of the information contained herein, measurements of floors, windows, rooms and any other items are approximate and no responsibility is taken for any error, omission or misstatement. This plan is for illustrative purposes only and should not be used to rely on, prospective purchase. The services, fixtures and appliances shown hereon have been illustrated and not guaranteed as to their operability or efficiency can be given.  
 Made with Housify ©2020

- Spacious ground floor split-level maisonette in desirable Marshalswick, St Albans
- Modern kitchen/breakfast room
- Two well-proportioned bedrooms
- Stylish, modern bathroom
- Share of freehold
- Close to excellent schools and local amenities at The Quadrant
- Generous living/dining room with balcony access
- Master bedroom measures an impressive 17'5 x 12'
- Includes residents' parking and private garage
- EPC Grade C

