



HEARTWOOD
HOMES

Althorp Road

Guide Price £725,000

🛏️ 3 🚿 2 🚗 2



This most stunning and truly unique property is nestled within a quiet cul-de-sac location within the heart of St Albans city centre, just a short walk from St Albans mainline station. Located on the first floor this property boasts stunning high ceilings, multiple feature fireplaces and a grand multi aspect living room. Lovingly and sympathetically converted from a once grand Edwardian mansion into individual dwellings, this beautiful home offers secluded living, within the city centre.

The magnificent communal hallway leads up to your own private front door, into the vast centrepiece entrance hall with doors leading off to all rooms. The kitchen leads through to the stunning dining room, which enjoys multi aspects and would be a perfect room for entertaining. The grand living room also enjoys views over the communal grounds and boasts a characterful fireplace. All three good size bedrooms are a great size with the stunning master benefitting from an en suite shower room, multi aspect windows and beautiful feature fireplace. Finishing the accommodation is the family bathroom with a modern fitted suite. Plenty of fitted storage can be found throughout the apartment.

This property should be viewed to be truly appreciated for both its size and private setting. The property offers similar square footage to that of a family home. EPC rating C



1ST FLOOR
1284 sq.ft. (119.3 sq.m.) approx.

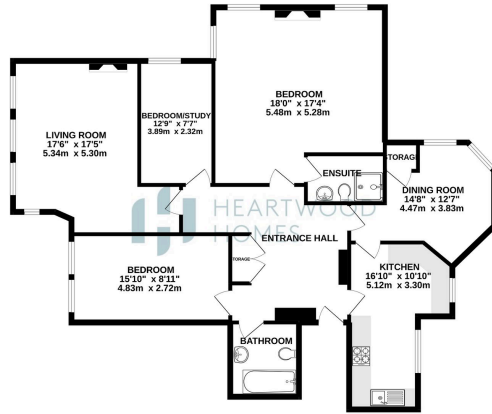

TOTAL FLOOR AREA: 1284 sq.ft. (119.3 sq.m.) approx.
While every effort has been made to ensure the accuracy of the floor plan, the measurements are approximate and should not be used for legal purposes. The floor plan is not intended as a guarantee of any specific features or measurements.



- Chain free
- Stunning period property
- Two allocated off street parking spaces
- Converted Edwardian mansion
- Three good size bedrooms
- Popular city centre location



Energy Efficiency Rating

Score	Energy rating	Current	Potential
92+	A		
81-91	B		85 B
69-80	C	78 C	
55-68	D		
39-54	E		
21-38	F		
1-20	G		