



HEARTWOOD
HOMES

Hatfield Road, St. Albans, AL1 4HY

£425,000

2 1 1



Check out this charming two-bedroom garden flat nestled within an attractive converted Victorian property on Hatfield Road! It's just a skip away from the mainline station and the vibrant City Centre of St Albans, with Clarence Park right across the street.

This fantastic home is beautifully presented, blending classic features with modern touches. Step through the sleek entrance hall to discover a bright bay-fronted living room, a modern kitchen, two generously sized bedrooms, and a contemporary bathroom.

Plus, you'll love the direct access to the private rear garden – perfect for those summer get-togethers! And with shared access to communal gardens, there's plenty of green space to enjoy.

This superb property is bound to be in high demand, so don't wait – schedule your viewing appointment today!



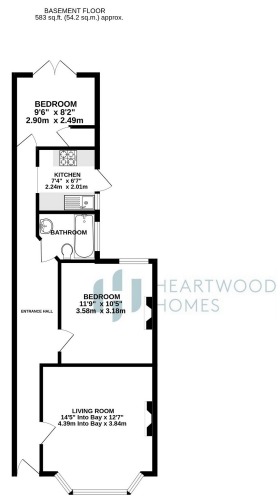

TOTAL FLOOR AREA: 1063 sq ft (98.2 sq m) approx.

While every effort has been made to ensure the accuracy of the floor plan, measurements of rooms are given as an approximate guide only. The actual measurements of the property may vary slightly from those shown on the floor plan. The services, fixtures and appliances shown have not been tested and are operated on the assumption that they are in good working order.

- Charming 2-bed garden flat in converted Victorian property
- Prime location on Hatfield Road, near mainline station
- Vibrant St Albans City Centre & Clarence Park nearby
- Beautiful blend of classic charm & modern touches
- Bright bay-fronted living room
- Modern kitchen & contemporary bathroom
- Generously sized bedrooms
- Direct access to private rear garden
- Book your viewing now before it's gone!

