



HEARTWOOD
HOMES

Riverside Road, St. Albans, AL1 1SF

£725,000

3 1 2



A charming period cottage situated on the sought after Riverside Road with stunning views over the Watercress Nature Reserve to the rear. The property is ideally set only a short distance from the mainline station and St Albans vibrant City Centre with a wide selection of shops, bars and eateries. You also have beautiful walks through the Watercress Nature Reserve only a few minutes away and you are close to highly regarded schools. Ideal for all stages of family life.

The property itself offers versatile accommodation to comprise living room complete with an attractive wood burner. To the rear is a stunning bright and spacious kitchen dining room which opens on to the landscaped rear garden. Upstairs you have two well proportioned bedrooms and an attractive family bathroom. On the second floor a lovely loft room partially separated into two areas.

Externally to the rear is a wonderful landscaped garden with a large patio area with a sunny aspect and allowing you to take in the amazing views

Please call today to book your viewing to see this fantastic home. EPC Grade C



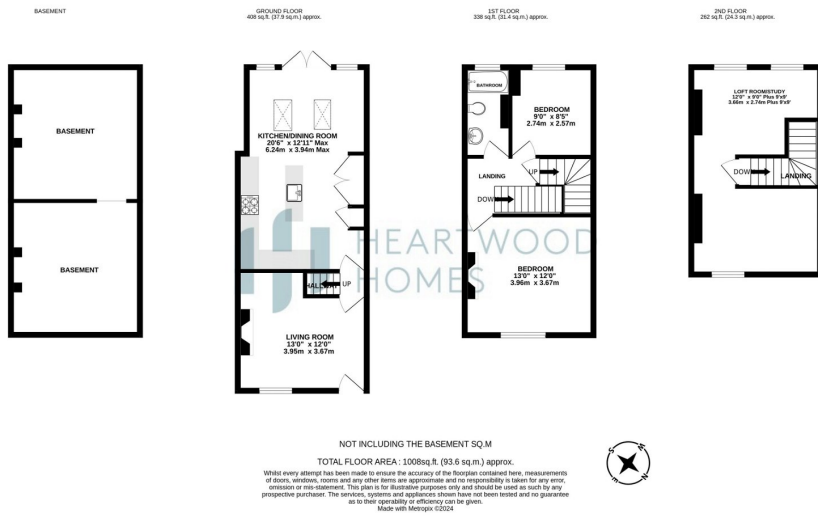

- Beautiful views over the Watercress Nature Reserve
- Close to the city centre and the station
- Stunning kitchen dining room
- Cosy living room
- A must view
- Attractive bathroom
- Upstairs bathroom
- EPC Grade C

