



HEARTWOOD
HOMES

Harvesters, St. Albans, AL4 9QY

£250,000

🛏️ 2 🚿 1 🚽 1



A delightful, chain free, over 55's maisonette which is pleasantly set in the popular Jersey Farm area of St Albans only a short walk to a wide variety of shops, eateries and coffee shops in both Jersey Farm and the Quadrant shopping precincts. There is a great community in Harvesters and you are also set close to beautiful countryside walks.

This excellent first floor apartment offers bright and spacious accommodation to comprise entrance hall with stairs and a stair lift leading to the first floor landing. From here you have a great size living room and a modern fitted kitchen. Furthermore there are two well proportioned bedrooms and a bathroom.

Please call us today to view this pleasant maisonette and to fully understand everything that it has to offer.



GROUND FLOOR
31.00m x 13.00m approx.

1ST FLOOR
62.00m x 10.00m approx.

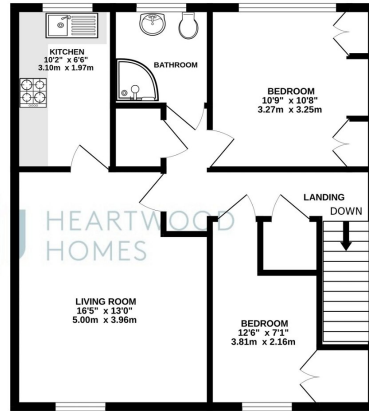
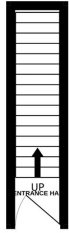

TOTAL FLOOR AREA: 672 sq.ft. (62.4 sq.m.) approx.

While every effort has been made to ensure the accuracy of the floorplan, Heartwood Homes does not warrant, represent, or give any other form of approval or endorsement in relation to the floorplan. It is for information only and should not be used for any purpose other than that intended. The floorplan is not intended to be used for any purpose other than that intended. The floorplan is not intended to be used for any purpose other than that intended. The floorplan is not intended to be used for any purpose other than that intended.



- Chain free
- Large living room
- A must view
- Close to good transport links
- Close to local shops
- Popular development
- Over 55's apartment
- EPC Grade C

