



HEARTWOOD
HOMES

Watling Street, St. Albans, AL1 2QF

£1,100,000

🛏️ 5 🚿 1 🚗 2



A beautiful, chain free 1930's semi detached family home set in a pleasant cul de sac location, a short distance from highly regarded local schools and with excellent access to the motorway networks. The property is perfectly located close to a wide variety of local shopping facilities and lovely walks through the beautiful Verulamium Park to St Albans historic City centre.

This wonderful home has been sympathetically extended to provide bright and spacious, versatile accommodation set over two floors. You enter into a great size entrance hall, to the left there is a playroom/home office/ground floor bedroom with an ensuite and to the right there is a large bay fronted living room. To the rear of the property is a stunning open plan contemporary kitchen/dining/family room with a large island and amazing bifold doors to the rear garden.

On the first floor there are four generous bedrooms and an attractive modern bathroom.

Externally, to the front, you approach the property via a block paved driveway providing ample parking and a lawned area. To the rear there is a great sized, mature garden.

Please call in today to make your appointment to view this wonderful home.



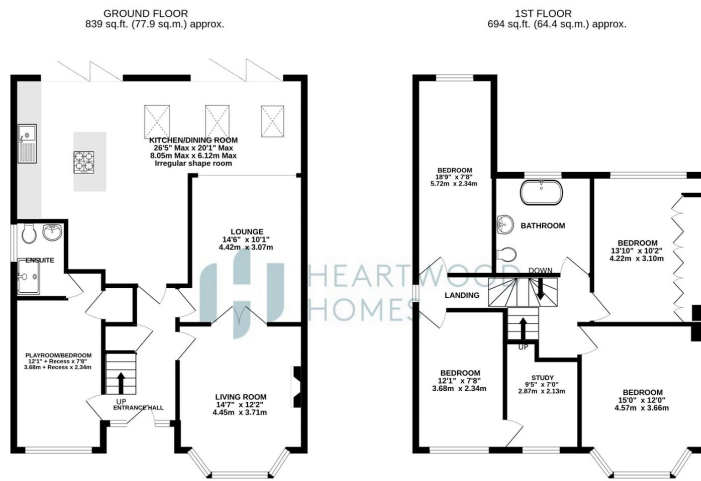

TOTAL FLOOR AREA: 1532 sq.ft. (142.4 sq.m.) approx.
 While every attempt has been made to ensure the accuracy of the figures contained here, measurements of doors, windows, stairs and any other items are approximate and no responsibility is taken for any error, omission or mis-statement. This plan is for illustrative purposes only and should not be used as a basis for any prospective purchase. The services, fixtures and appliances shown here are given trends and no guarantee as to their quantity or efficiency can be given.
 Made with Merge 10/22



- Contemporary opening plan kitchen/living/dining room with bifold's to the garden
- Bay fronted living room
- Attractive bathroom
- Large rear garden
- Chain free
- Playroom/home office
- Off street parking
- EPC grade C

