



HEARTWOOD  
HOMES

# Elizabeth Court, St. Albans, AL4 9JD

Offers Over £550,000

3 1 1



A well presented, chain free, three bedroom family home with modern open plan living. The property is ideally located in the sought after Jersey Farm area of St Albans, close to highly regarded local schools, a great selection of shops and eateries, as well as being close to beautiful countryside with Jersey Farm Woodland Park and Heartwood Forest.

This lovely family home offers versatile accommodation, starting with the canopy porch through to the entrance hall. To the front is a great size, bay fronted living/dining room and to the rear is a bright and spacious conservatory, opening to the garden and a modern kitchen. Upstairs there are three well proportioned bedrooms and an attractive family bathroom.

Externally to the front there is a well maintained garden and to the rear is a wonderful, landscaped and enclosed garden. Furthermore, you also benefit a useful side lobby area with direct access to the garage.

Please call in today to book your appointment to view this fantastic home. EPC Grade C



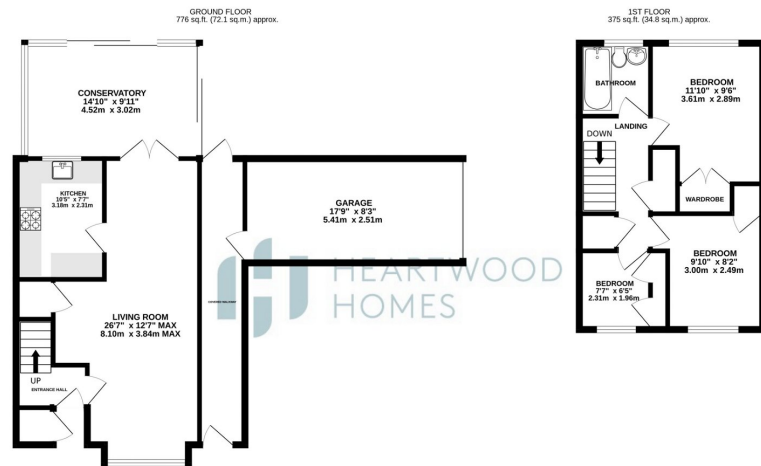

**TOTAL FLOOR AREA - 1151 sq ft. (106.9 sq.m.) approx.**  
 Whilst every attempt has been made to ensure the accuracy of the floorplan contained here, measurements of all flats, bedrooms, rooms and any other items are approximate and no responsibility is taken for any error, omission or mis-statement. This plan is for illustrative purposes only and should be used as such by any prospective purchaser. The services, systems and appliances shown have not been tested and no guarantee as to their operability or efficiency can be given.  
 Made with Mapbox (2023)



- Chain free
- Close to highly sought after schooling
- Modern kitchen
- Two reception rooms
- Great size garden
- Attractive bathroom
- Garage
- EPC Grade C

