



HEARTWOOD
HOMES

Lakeside Place, London Colney, St. Albans, AL2 1PZ

£600,000

4 1 2



A chain free four bedroom detached family home which is set in a popular cul de sac location, close to sought after local schooling and only a short distance from beautiful walks around the Broad Colney Lakes Nature Reserve. The property is also ideally situated with great access to the motorway networks and a wide variety of shopping facilities at Colney Fields including Sainsburys, Next and M&S.

This wonderful home provides ample accommodation starting in the entrance hall which leads to the ground floor W.C, study, kitchen and the open plan living dining room. To the first floor there are four well proportioned bedrooms and a family bathroom. Externally there is a well groomed rear garden, a garage and further parking.

Please call today to book your appointment to view this excellent home. EPC Grade C





HEARTWOOD HOMES

GROUND FLOOR
791 sq.ft. (73.5 sq.m.) approx.

1ST FLOOR
583 sq.ft. (54.2 sq.m.) approx.

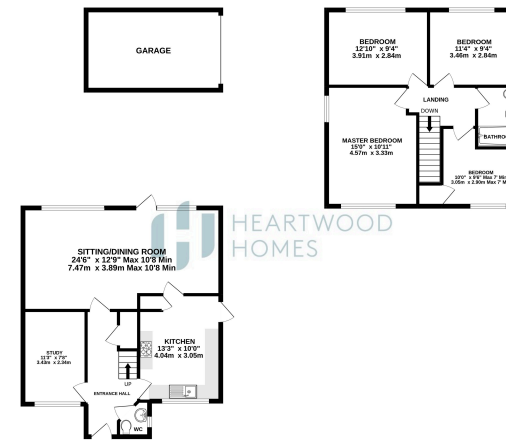

TOTAL FLOOR AREA: 1374 sq ft (127.7 sq m) approx.
While every effort has been made to ensure the accuracy of the floor plan contained herein, Heartwood Homes does not accept any liability for any errors or omissions. The floor plan is for information only and should not be used as a basis for any legal proceedings. The seller, agent and publisher of this plan have no liability for any errors or omissions.



HEARTWOOD HOMES



HEARTWOOD HOMES