



Claughton Court, 60, Russet Drive

Offers Over £300,000

2 1 1



An attractive modern, top floor apartment which is set in a popular location with excellent access to St Albans mainline railway station which is only 1.4 miles away.

This stunning apartment offers fabulous opening plan living conducive with modern lifestyle. You enter through the communal entrance which leads on to the private entrance hall which offers good storage. The kitchen/living/dining room offers a superb open plan space and has been fitted to a good standard. Further more there are two well proportioned bedrooms with and a bathroom.

Externally you have allocated parking. We expect a high demand for this popular home and would highly recommend booking an early viewing to avoid disappointment.





GROUND FLOOR
576 sq.ft. (53.5 sq.m.) approx.

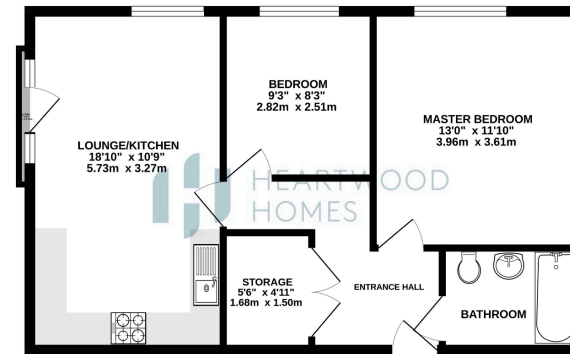

TOTAL FLOOR AREA: 576 sq.ft. (53.5 sq.m.) approx.
Whilst every attempt has been made to ensure the accuracy of the floorplan contained herein, measurements of areas, volumes, counts and any other items are approximate and no responsibility is taken for any error, omission or misstatement. This plan is for illustrative purposes only and should be used as such for any prospective purchaser. The dimensions and descriptions shown here are not intended and no guarantee as to their accuracy or efficiency can be given.
Made with Metaphor 12/22

