





# Ashley Court, Hatfield, AL10 0RW

£170,000

2 1 1



A warden assisted retirement apartment which is ideally located in Hatfield town centre with it's wide variety of shopping facilities and transport links including the train station with direct access to London.

The apartment itself is well presented and is set on the first floor. You enter via a communal entrance and there is a lift and stairs to the first floor. Once inside the property you have well proportioned accommodation to comprise entrance hallway with ample storage, a dual aspect kitchen/dining/living room fitted with an attractive kitchen. Furthermore, there are two bedrooms and a modern shower room .

Externally there are well groomed communal grounds and ample parking for the use of residents and visitors. Ashley Court is a warden assisted complex and also provides one guest apartment and communal living area which hosts many functions and activities as well as a communal laundry room. Please note, residents must be 55 or over.





GROUND FLOOR  
568 sq.ft. (52.8 sq.m.) approx.

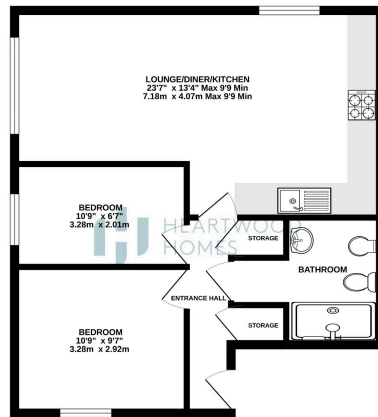

TOTAL FLOOR AREA: 568 sq.ft. (52.8 sq.m.) approx.  
While every attempt has been made to ensure the accuracy of the floorplan contained here, Heartwood Homes, its agents, cannot accept any liability for any discrepancies with the actual property. The floorplan is provided for information only and is not intended to be used as a basis for any legal proceedings. The floorplan is provided for information only and is not intended to be used as a basis for any legal proceedings. The floorplan is provided for information only and is not intended to be used as a basis for any legal proceedings.



- Chain free
- Warden assisted
- Over 55's
- Dual aspect kitchen dining living room
- Great storage
- Centrally located

