



HEARTWOOD
HOMES

Milford Close, Marshalswick, St. Albans, AL4 9AQ

Offers Over £300,000

🛏 1 🚿 1 🚿 1



A wonderful on double bedroom cluster home which is situated in a pleasant cul de sac location in the highly sought after Jersey Farm area of St Albans. Jersey Farm offers a great selection of local shops takeaways and a pub with more local amenities at the Quadrant shopping precinct.

There are also many beautiful countryside walks, just a short distance away with Jersey Farm Woodland Park and Heartwood Forrest.

This bright and spacious home provides great accommodation starting in the open plan kitchen/living /dining room. On to the first floor you have a lovely mezzanine double bedroom and a modern bathroom.

Externally to the front there is a well groomed attractive garden and an allocated parking space. EPC Grade E





GROUND FLOOR
260 sq.ft. (24.1 sq.m.) approx.

1ST FLOOR
162 sq.ft. (15.1 sq.m.) approx.

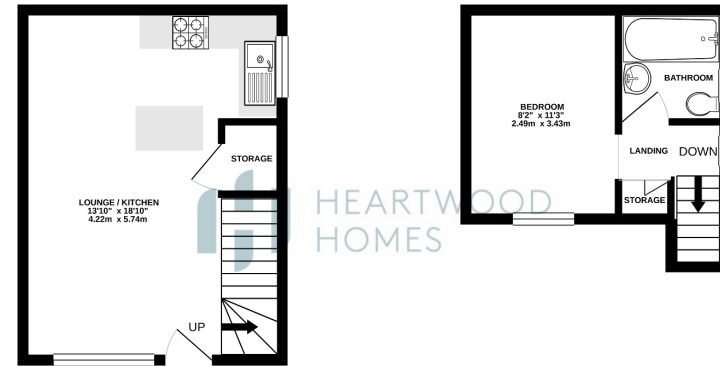

TOTAL FLOOR AREA: 422 sq.ft. (39.2 sq.m.) approx.
Whilst every attempt has been made to ensure the accuracy of the floorplan contained here, measurements of doors, windows, stairs and any other items are approximate and no responsibility is taken for any error, omission or mis-statement. This plan is for illustrative purposes only and should be used as such by any prospective purchaser. The services, systems and appliances shown have not been tested and no guarantee as to their operability or efficiency can be given.
Made with Homplan ©2021

