



SUTTON LANE ELTON







Situated in the heart of the Vale of Belvoir, The Spinney has been recently refurbished throughout and benefits from a high standard of finish and decoration, offering a spacious open plan kitchen dining room, entrance hall, master suite with built in storage, plus wet room featuring an attractive stone flooring, three further bedrooms, one being suitable to use as a study/home office and a three piece suite family bathroom.

Externally, this property offers excellent equestrian facilities with a recently built Harlow American stable block with monarch internal stabling, tack room, adjoining well fenced paddocks, plus a further adjacent area of grassland, which has previously been fenced and arranged to allow for DIY grazing/livery. A double garage with internal access plus an extensive area of parking for a number of vehicles. This property sits within approximately 2.5 acres and the land adjacent being approximately 3.8 acres.

Elton is located within close proximity of excellent transport links, including the A1 motorway and nearby stations giving access to trains to both, Nottingham and London, as well as the city of Nottingham, providing an extensive range of amenities and attractions.



Sutton Lane, Elton, Nottingham, NG13

Approximate Area = 1594 sq ft / 148.1 sq m

Outbuilding = 1853 sq ft / 172.1 sq m

Garage = 430 sq ft / 40 sq m

Total = 3877 sq ft / 360.2 sq m

For identification only - Not to scale

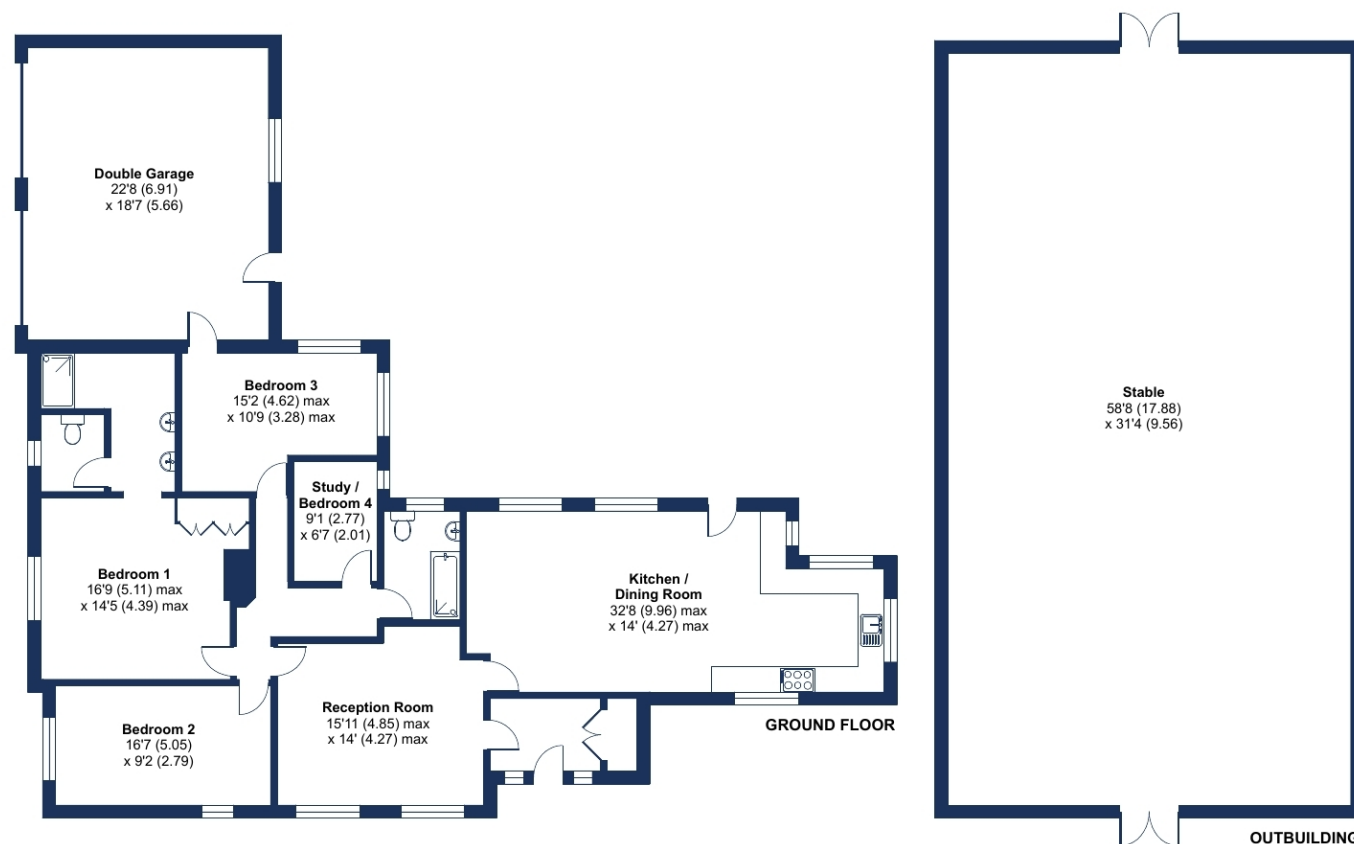

Floor plan produced in accordance with RICS Property Measurement 2nd Edition, Incorporating International Property Measurement Standards (IPMS2 Residential). © nichecom 2024. Produced for Moores Estate Agents. REF: 1205075



Moore V Ltd trading as Moores Estate Agents gives notice that: 1. These particulars do not constitute an offer or contract or part thereof. 2. All descriptions, photographs and plans are for guidance only and should not be relied upon as statements or representations of fact. All measurements are approximate and not necessarily to scale. Any prospective purchaser must satisfy themselves of the correctness of the information within the particulars by inspection or otherwise. 3. Moore V Ltd trading as Moores Estate Agents does not have any authority to give any representations or warranties whatsoever in relation to this property (including but not limited to planning/building regulations), nor can it enter into any contract on behalf of the Vendor. 4. Moore V Ltd trading as Moores Estate Agents does not accept responsibility for any expenses incurred by prospective purchasers in inspecting properties which have been sold, let or withdrawn. 5. If there is anything of particular importance to you, please contact this office and we will try to have the information checked for you.



Moores Property Hub 01572 757979
Moores Move to the Country 020 301 11361
Melton 01664 491610
Uppingham 01572 821935

Stamford 01780 484555
Grantham Meet & Greet 01476 855618
Peterborough Meet & Greet 01733 788888
A1 Meet & Greet Stoke Rochford



office@mooresestateagents.com
www.countryequestrianhomes.com