



Greenways Court, Shipston-On-Stour, CV36 4DR

Property Description

A charming two-bedroom terraced house with garden and allocated parking located within walking distance of the town centre and amenities, ideal for first time buyers or a downsize.

Upon entering the hallway, you'll find a modern kitchen with a built in electric oven with a gas hob and space for the usual appliances, there is a useful storage cupboard under the stairs before entering the sitting dining room which overlooks the garden and has a rear door that leads outside.

Upstairs, there are two bedrooms, both of which have a built in cupboard. The main bathroom features a shower over the bath.

Outside is a pretty rear courtyard garden which has a gate for access. There is an allocated parking space at the front of the property.





Key Features

- 2 Bedrooms
- Bright Living/Dining Room
- Family Bathroom
- Pretty Courtyard Garden with Rear Access
- Allotment Parking Space to the Front
- Ideal First Home or Investment Opportunity
- Walking Distance to Town Centre
- 10 mins Drive to Mainline Rail to Oxford/London
- Close to Schools, Doctors & Amenities

Price Guide
£220,000



Ground Floor

Approx. 28.0 sq. metres (301.6 sq. feet)

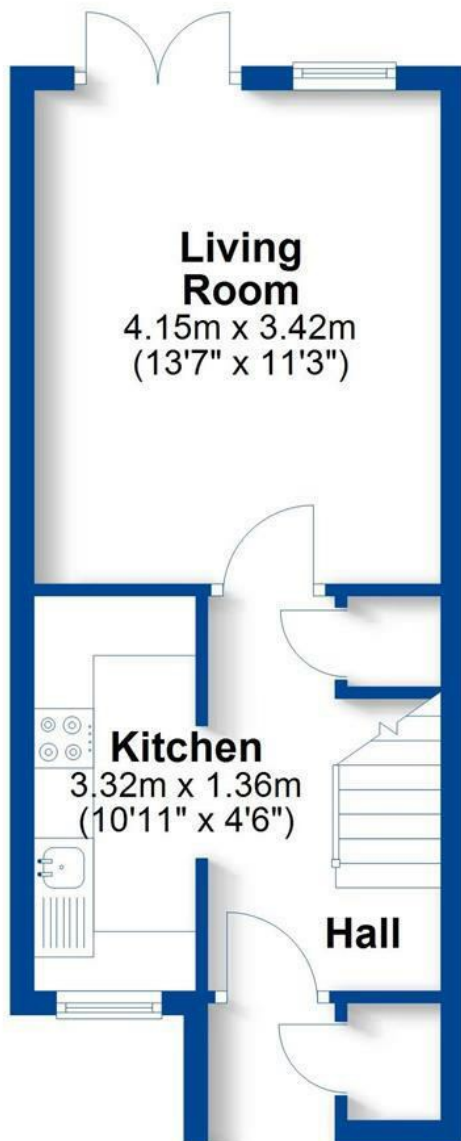

First Floor

Approx. 25.9 sq. metres (278.7 sq. feet)

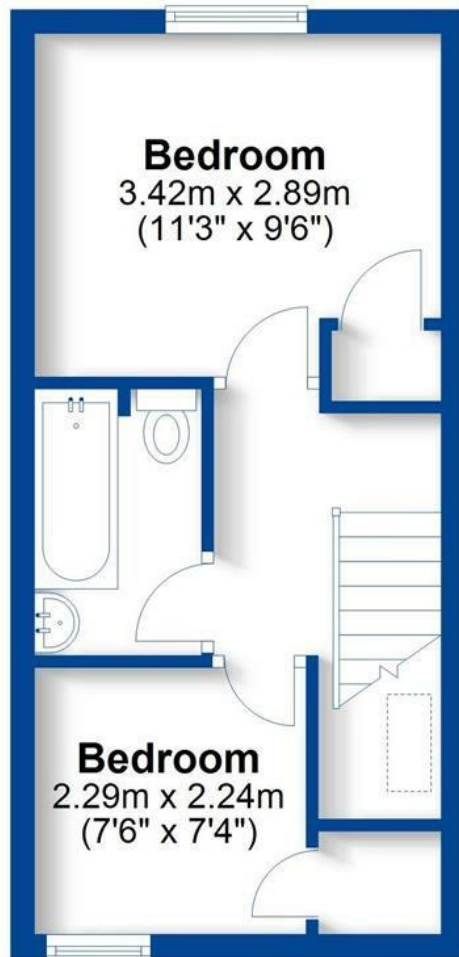

Total area: approx. 53.9 sq. metres (580.3 sq. feet)

This plan is for illustration purposes only and should not be relied upon as a statement of fact



EPC Rating - C

Tenure - Freehold

Council Tax Band - B

Local Authority
Stratford on Avon District Council



We routinely refer clients to both our recommended legal firm and a panel of financial services providers. It is your decision whether you choose to deal with these companies. In making that decision, you should know that we receive a referral fee.

**SHELDON
BOSLEY
KNIGHT**

LAND AND
PROPERTY
PROFESSIONALS