



Sheep Street, Shipston-On-Stour, CV36 4AF

**SHELDON
BOSLEY
KNIGHT** LAND AND
PROPERTY
PROFESSIONALS

Property Description

A centrally located, light and airy 2 double bedroom first floor apartment with accommodation over two floors. Communal entrance hall shared with one other apartment; front door opening to the entrance hall; open plan Living Room and Kitchen having integrated fridge/freezer, dishwasher, washing machine, oven, hob and extractor fan; Bathroom with shower over bath, WC and basin; Stairs leading to two double bedrooms and a useful storage cupboard. The property is conveniently located just off the market square, there are 2 carparks nearby and street parking which you can obtain a yearly resident permit for. Gas-fired Central Heating. Council Tax Band A. EPC Rating: D

Tenure: We understand that the property is for sale Leasehold with the lease 125 years from 01 January 2012. The vendor has made us aware of the current up to date charges: The Service Charge is £600 per annum, this covers the ground rent, maintenance of communal areas, exterior and roof of building.





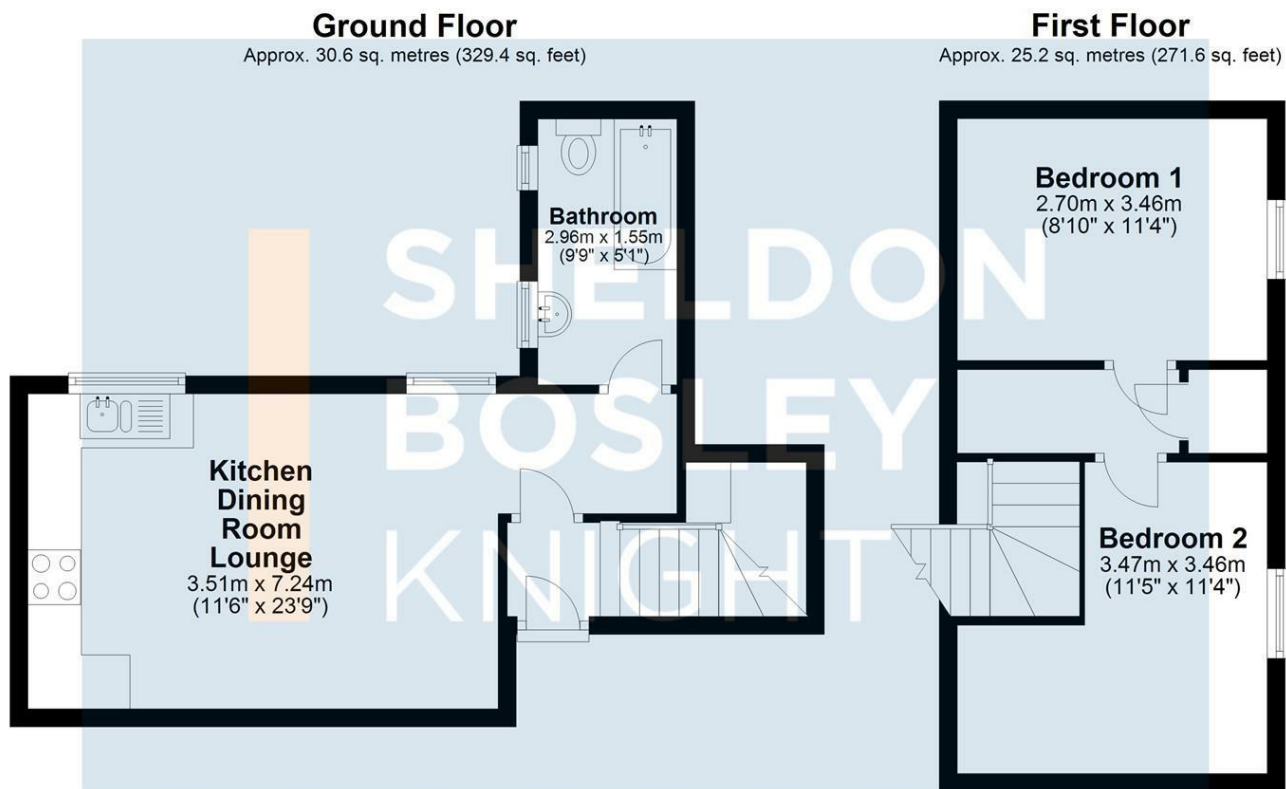

Total area: approx. 55.8 sq. metres (600.9 sq. feet)

All efforts have been made to ensure that the measurements on this floorplan are accurate however these are for guidance purposes only.
Plan produced using PlanUp.

Key Features

- No Onward Chain
- 2 Bedrooms
- Gas-fired Central Heating
- Town Centre Location
- Open Plan Living
- Built in Kitchen Appliances
- Investment Opportunity
- Tucked Away Location
- Roof Top Views
- Mainline Rail to Oxford/London
10 Mins Drive Away

Price Guide
£180,000

EPC Rating - D

Tenure - Leasehold

Council Tax Band - A

Local Authority -
Stratford on Avon

We routinely refer clients to both our recommended Legal Firm and a panel of Financial Services Providers. It is your decision whether you choose to deal with these companies. In making that decision, you should know that we receive a referral fee