



Old School House, Shipston-On-Stour, CV36 4AU

**SHELDON
BOSLEY
KNIGHT**

LAND AND
PROPERTY
PROFESSIONALS

Property Description

A charming, end-of-terrace cottage with 2 double bedrooms and 2 parking spaces. It is conveniently located just a few minutes walk from the town centre and amenities and offered for sale with no onward chain.

The Old School House was converted into cottages in the 1980's. This delightful conversion features an open-plan living dining room with natural light flowing in from windows on both sides. The living area opens to the kitchen, which is equipped with a good range of cupboards, an electric oven with a gas hob, and space for standard appliances. Upstairs, there are 2 double bedrooms and a bathroom.

Outside, there are 2 allocated parking spaces, a small open garden to the front and side, and a communal area with a shed, space for hanging washing, and a bin store. The side garden is the perfect spot for a bench or bistro set, capturing the sun in the afternoon and evening.

Residents are asked to contribute for the upkeep of communal areas. Last year, the contribution was £80, with an additional £70 per year for lawn mowing, this is arranged by the resident's association.





Key Features

- Characterful Conversion
- End of Terrace
- 2 Allocated Parking Spaces
- Sunny Garden
- 2 Double Bedrooms
- Open Plan Living Space
- Short Level Walk into Town Centre
- Gas Central Heating
- Low Maintenance Garden
- No Onward Chain

Price Guide
£239,000



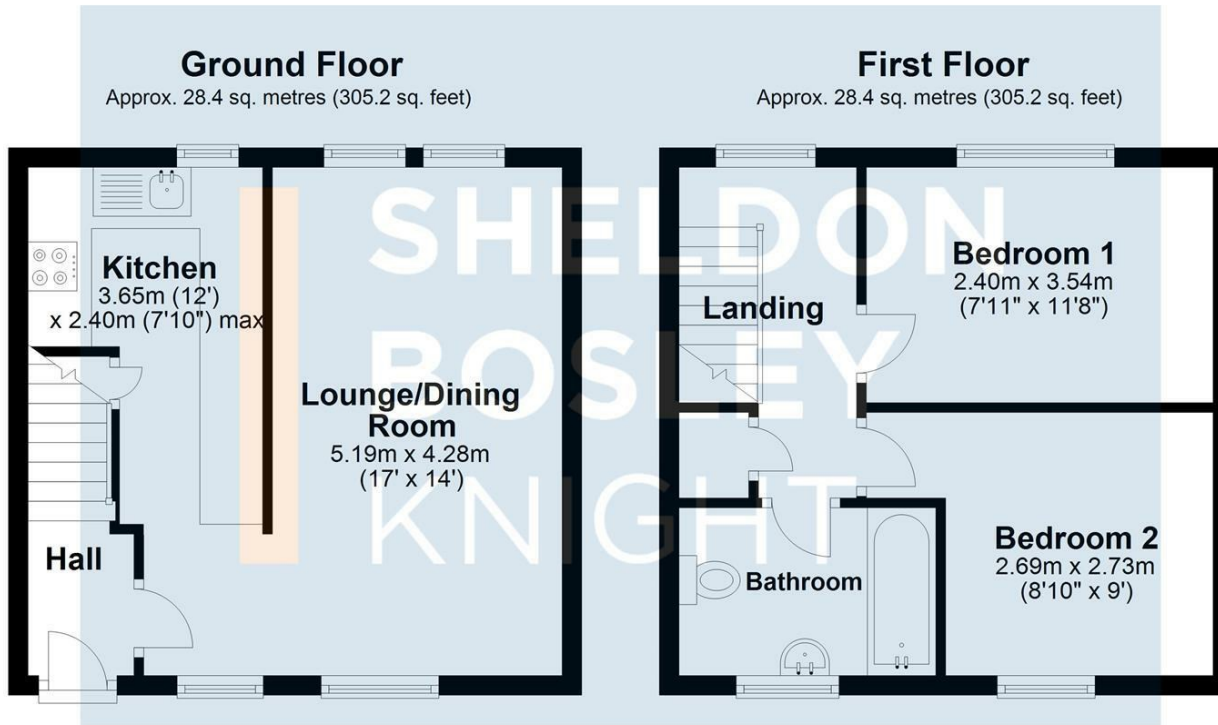

Total area: approx. 56.7 sq. metres (610.4 sq. feet)

All efforts have been made to ensure that the measurements on this floorplan are accurate however these are for guidance purposes only.
Plan produced using PlanUp.



EPC Rating - D

Tenure - Freehold

Council Tax Band - C

Local Authority
Stratford on Avon District



We routinely refer clients to both our recommended legal firm and a panel of financial services providers. It is your decision whether you choose to deal with these companies. In making that decision, you should know that we receive a referral fee.

**SHELDON
BOSLEY
KNIGHT**

LAND AND
PROPERTY
PROFESSIONALS