



Acheson Close, Shipston-On-Stour, CV36 4FW

**SHELDON
BOSLEY
KNIGHT**

LAND AND
PROPERTY
PROFESSIONALS

Property Description

*** AVAILABLE 8th AUGUST *** A Beautiful four bedroom detached family home within the sought after Cala development on the very edge of Shipston on Stour. This magnificent home briefly comprises: entrance door into an impressive reception hall with staircase to the first floor. There is a stylish kitchen with large island and double doors out to the garden, utility room, WC, living room also with double doors out to the garden and a second reception room which could be a dining room, home office or playroom. On the first floor are four double bedrooms, family bathroom and two en-suites to bedrooms one and two. Outside to the rear is a beautifully landscaped garden with a lawn, patio area, and rear access to the garage which has space for parking 2 cars in front. This home is offered Unfurnished. Council Tax Band F. Energy Rating B.





Key Features

- *** AVAILABLE 8th AUGUST ***
- Shipston on Stour
- Four Bedrooms
- Detached home
- Unfurnished
- Walled rear Garden
- Garage & 2 parking spaces
- Energy Rating B
- Council Tax Band F
- Cala development

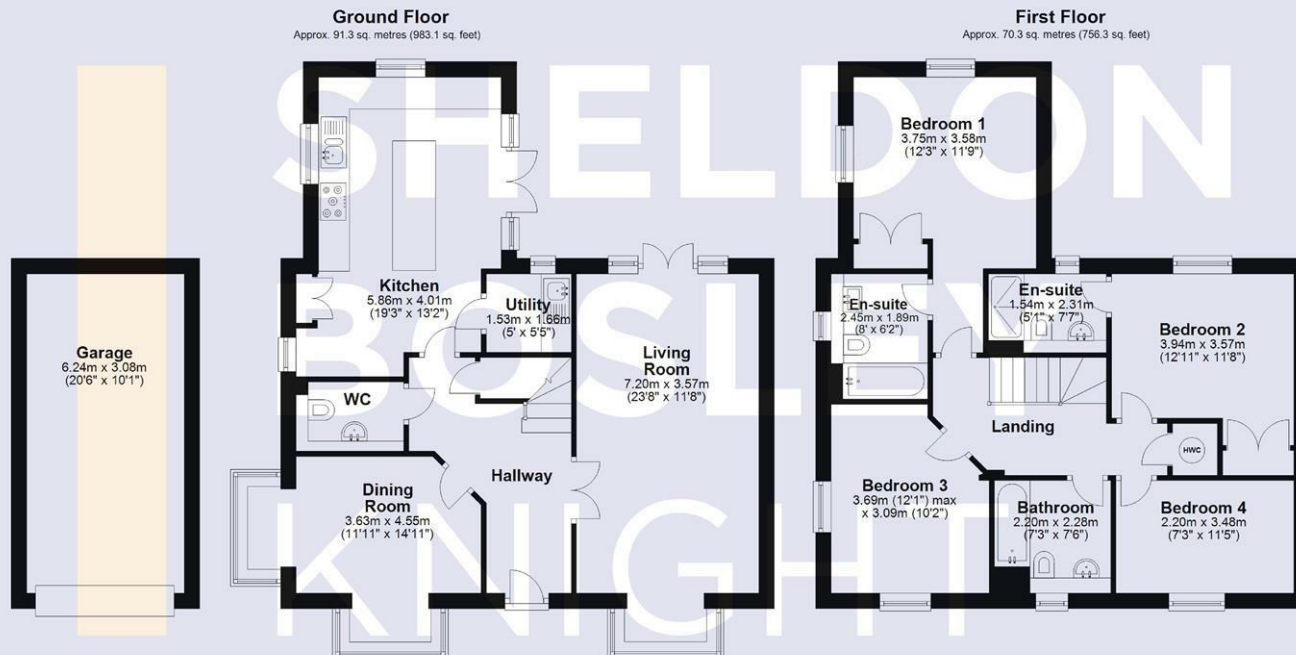

Total area: approx. 161.6 sq. metres (1739.4 sq. feet)

DISCLAIMER - Floor plans shown are for general guidance only. Whilst every attempt has been made to ensure that the floorplan measurements are as accurate as possible, they are for illustrative purposes only.

£2,000 PCM