



**Bradley Drive, Shipston-On-Stour, CV36 4RP**

**SHELDON  
BOSLEY  
KNIGHT**

LAND AND  
PROPERTY  
PROFESSIONALS



# Property Description

A well-presented 3-bedroom detached house built by Taylor Wimpey in 2020. The property benefits from the remainder of its NHBC warranty and is situated on the edge of the town. It features a garage and driveway.

The house comprises a neat hallway with a storage cupboard, leading to a lovely sitting room and a light and spacious kitchen/dining room at the back of the house. The kitchen overlooks the pretty garden and is well-equipped with a good range of units and built-in appliances, including a fridge/freezer, slimline dishwasher, washing machine, and electric oven with a gas hob. Additionally, there is a downstairs WC and a useful storage cupboard.

Upstairs, the main bedroom has an ensuite shower room and built-in wardrobes. There is a second double bedroom with built-in wardrobes, a family bathroom with a shower over the bath, and a third bedroom.

Outside, there is a pretty rear garden with a patio, lawn, and a useful shed. A side gate leads to the driveway with tandem parking for 2 cars and single garage.

The property features gas-fired central heating and UPVC double-glazed units throughout.







## Key Features

- Detached house
- Main bedroom with ensuite shower
- 3 Bedrooms
- Pretty rear garden
- Kitchen dining room
- Single Garage
- Tandem parking for 2 cars
- Remainder of NHBC warranty
- Walking distance of the town centre
- Nursery, primary & secondary schools in the town

**Offers Around  
£370,000**

### Shipston on Stour

The market town of Shipston on Stour, located in South Warwickshire, is an excellent choice for those who want to have easy access to a variety of amenities. The town has a rich history as an important sheep market town and is also known as 'Sheep-wash-Town'. It has flourished over the years as a thriving working town and boasts a range of facilities, including a number of independent shops, pubs, restaurants, and community-led services. The town has a primary and a secondary school, a medical centre, two dentists, a town hall, a scout hut, and many other amenities, including a variety of sports clubs. The town also hosts several events throughout the year, such as the Shipston Wool Fair, craft markets, Shipston Proms, and Victorian Evening. The main centres for the area are Stratford upon Avon (11 miles), Banbury (14 miles), Warwick (17 miles), and Leamington Spa (18 miles). A mainline rail service to Oxford/London is available from the Cotswold town of Moreton in Marsh (7 miles).

### Additional Information

Tenure: We understand that the property is for sale Freehold.

There is an estate service charge for the upkeep of communal areas - but this has not yet started, as the estate has only just been complete but they are estimated to be £190 per annum.

Local Authority: Stratford-On-Avon District Council

Council Tax Band: D

EPC Rating: B

Mains water, drainage, gas and electric are connected to the property.

Interested parties are advised to make their own enquiries and investigations before finalising their offer to purchase.

### Agents Notes

(i) All descriptions, dimensions, reference to condition and necessary permissions for use and occupation, and other details are given without responsibility and any intending buyers should not rely on them as statements of fact, but must satisfy themselves by inspection or otherwise as to the correctness of each of them.

(ii) Floorplans shown are for general guidance only. Whilst every attempt has been made to ensure that the floorplan measurements are as accurate as possible, they are for illustrative purposes only.





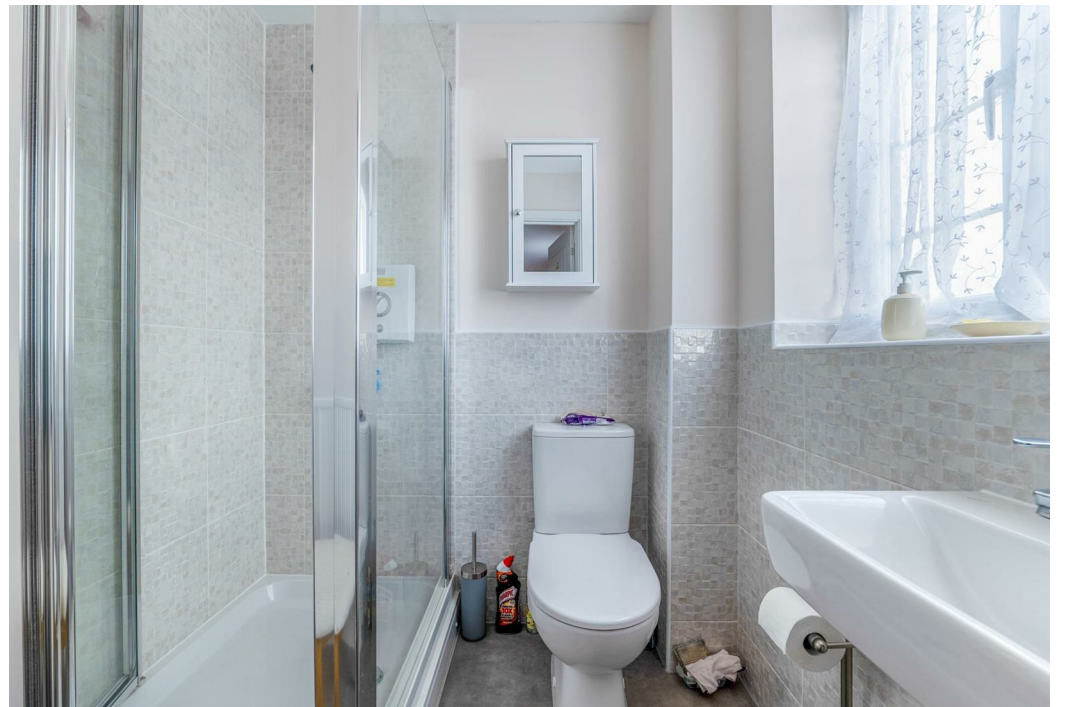







# Floorplan

## Ground Floor

Approx. 61.2 sq. metres (658.5 sq. feet)

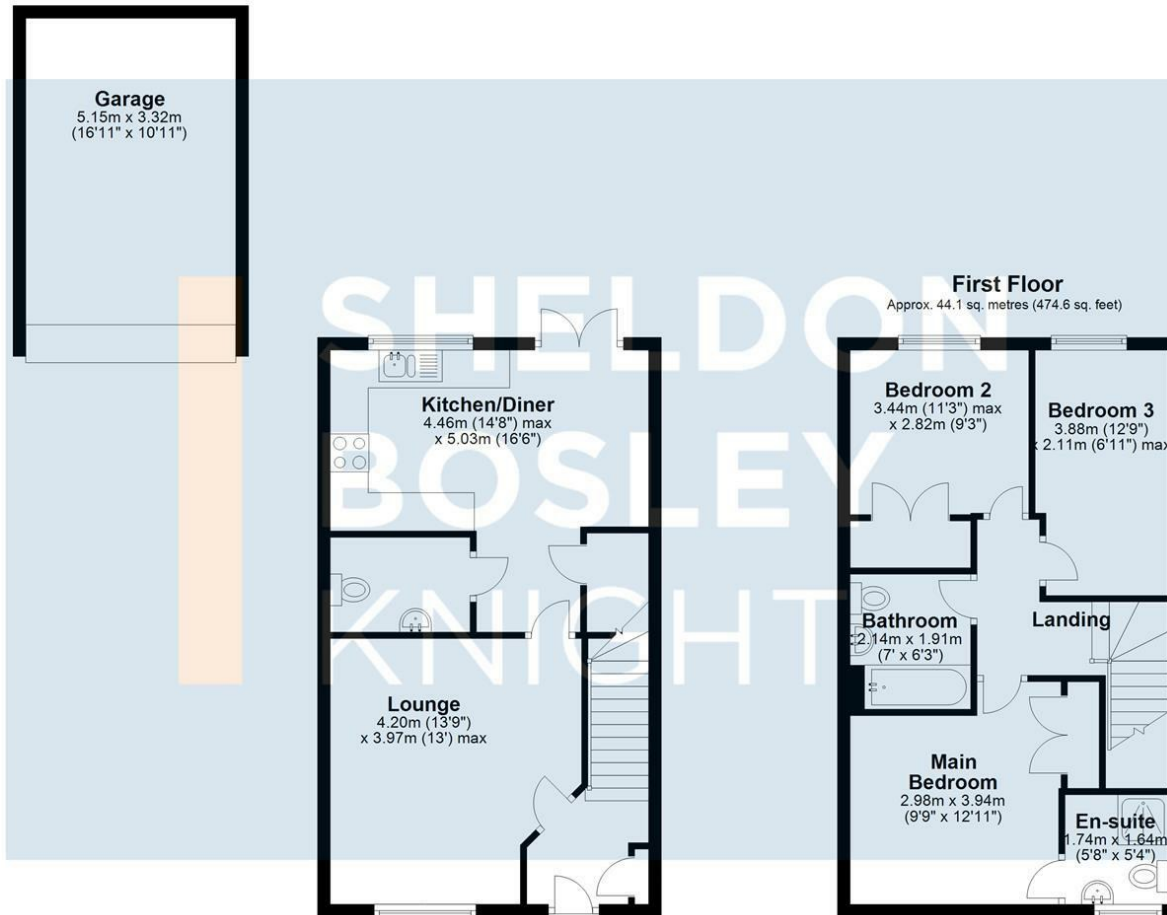

Total area: approx. 105.3 sq. metres (1133.2 sq. feet)

All efforts have been made to ensure that the measurements on this floorplan are accurate however these are for guidance purposes only.  
Plan produced using PlanUp.



EPC Rating - B

Tenure - Freehold

Council Tax Band - D

Local Authority  
Stratford on Avon District Council

# Our Testimonials

Excellent sales team. Chloe, Christian and Leanne supported me throughout a difficult sale and at a very competitive fee. They really know their stuff and I wouldn't hesitate to recommend SBK Evesham. Thank you!

Louise Orchard

Fantastic and easy experience. Nothing was too much to ask and the team were incredible in providing support and reassurance in our first move. Everything was communicated to us professionally and efficiently. Massive thanks to the team for making this move possible.

Anna Stoumann

We found our dream home and needed to sell our house to make an offer. Andrew and the team at Sheldon Bosley knight Leamington were fantastic. They managed to value our home, got photos and floor plans sorted, advertised, completed viewings and we had an above asking price offer accepted in one and a half weeks from first contacting them!! Communication from both Andrew, Sophie and the team plus through their online portal was great throughout. Honestly couldn't have asked for more.

Charlie Foley

Both Amy and Amelia were incredibly helpful and proactive throughout the purchase of our property. The commitment that they both showed to the sellers and us as buyers was second to none and meant that any moving bumps were successfully managed. We would wholeheartedly recommend them to friends and, if we were to consider moving again, would certainly use them.

Emmah Ferguson

I had a great experience while purchasing a house with Sheldon Bosley Shipston on stour. From start to finish they have done everything they can to help and been great with communication. I dealt with Kate and Morgan who were both lovely but I'm sure it was a team effort behind the scenes. I felt like they were there for me and supportive. Thank you to you all!

Georgie Smith

Very helpful and friendly staff. They were happy to provide names of local tradesmen which will be a great help. Would highly recommend.

Jane Harms

A stress free procedure due mainly to the estate agent Rockwell Allen. There was excellent communication and marketing with the bonus of getting the asking price.

Susan

Millie has been absolutely brilliant from the word go. The whole experience has been a breath of fresh air and the complete opposite from our last dealings with an estate agent. Thank you Millie for all your hard work and advice, couldn't be bettered.

Kate

We couldn't recommend Sheldon Bosley Knight more. After having a house sale fall through previously, we were very nervous about making our offer, but the lovely Annette and Sara guided us through everything with ease and made us feel so comfortable with our decisions. We got the house of our dreams, and we are absolutely delighted! They made us feel like friends and we would recommend them to anyone looking to buy their perfect home.

Jen Singleton

To book a free no obligation market appraisal of your property contact your local office.

[sheldonbosleyknight.co.uk](http://sheldonbosleyknight.co.uk)



SALES

LETTINGS

PLANNING &  
ARCHITECTURE

COMMERCIAL

STRATEGIC  
LAND

NEW  
HOMES

BLOCK  
MANAGEMENT

RURAL



DISCLAIMER

All fixtures and fittings mentioned in these particulars are included in the sale, all others in the property are specifically excluded. Photographs are reproduced for general information and it must not be inferred that any item is included for sale with the property. These particulars are thought to be materially correct. Their accuracy is not guaranteed and they do not form part of any contract.